



TRAFFIC CRASH REPORT

*DENOTES MANDATORY FIELD FOR SUPPLEMENT REPORT

LOCAL REPORT NUMBER*

2 0 2 1 - 0 0 0 1 1 1 8 8

PHOTOS TAKEN
 SECONDARY CRASH
 OH-2 OH-3
 OH-1P OTHER
 PRIVATE PROPERTY

LOCAL INFORMATION
 REPORTING AGENCY NAME*
City of Kent Police
 NCIC*
 0 6 7 0 3

HIT/SKIP
 1 - SOLVED
 2 - UNSOLVED
 NUMBER OF UNITS
0 1
 UNIT IN ERROR
 98 - ANIMAL
 99 - UNKNOWN
9 8

COUNTY* **6 7** LOCALITY* **1** LOCATION: CITY, VILLAGE, TOWNSHIP*
Kent

CRASH DATE / TIME*
0 7 1 2 2 0 2 1 / 0 5 2 0
 CRASH SEVERITY
 1 - FATAL
 2 - SERIOUS INJURY SUSPECTED
 3 - MINOR INJURY SUSPECTED
 4 - INJURY POSSIBLE
 5 - PROPERTY DAMAGE ONLY
5

ROUTE TYPE **S R** ROUTE NUMBER **2 6 1** PREFIX
 1 - NORTH
 2 - SOUTH
 3 - EAST
 4 - WEST
 LOCATION ROAD NAME
<UNKNOWN>
 ROAD TYPE

LATITUDE DECIMAL DEGREES
4 1 1 3 5 6 2 7

ROUTE TYPE
 1 - NORTH
 2 - SOUTH
 3 - EAST
 4 - WEST
 REFERENCE ROAD NAME (ROAD, MILEPOST, HOUSE #)
1250
 ROAD TYPE

LONGITUDE DECIMAL DEGREES
8 1 3 8 6 8 0 7

REFERENCE POINT
 1 - INTERSECTION
 2 - MILE POST
 3 - HOUSE #
3
 DIRECTION FROM REFERENCE
 1 - NORTH
 2 - SOUTH
 3 - EAST
 4 - WEST
 ROUTE TYPE
 IR - INTERSTATE ROUTE (TP)
 US - FEDERAL US ROUTE
 SR - STATE ROUTE
 CR - NUMBERED COUNTY ROUTE
 TR - NUMBERED TOWNSHIP ROUTE
 ROAD TYPE
 AL - ALLEY
 AV - AVENUE
 BL - BOULEVARD
 CR - CIRCLE
 CT - COURT
 DR - DRIVE
 HE - HEIGHTS
 HW - HIGHWAY
 LA - LANE
 MP - MILEPOST
 OV - OVAL
 PK - PARKWAY
 PI - PIKE
 PL - PLACE
 RD - ROAD
 SQ - SQUARE
 ST - STREET
 TE - TERRACE
 TL - TRAIL
 WA - WAY

INTERSECTION RELATED
 WITHIN INTERSECTION OR ON APPROACH
 WITHIN INTERCHANGE AREA
 NUMBER OF APPROACHES
 ROADWAY
 ROADWAY DIVIDED

LOCATION OF FIRST HARMFUL EVENT
 1 - ON ROADWAY
 2 - ON SHOULDER
 3 - IN MEDIAN
 4 - ON ROADSIDE
 5 - ON GORE
 6 - OUTSIDE TRAFFIC WAY
 7 - ON RAMP
 8 - OFF RAMP
0 1
 9 - CROSSOVER
 10 - DRIVEWAY/ALLEY ACCESS
 11 - RAILWAY GRADE CROSSING
 12 - SHARED USE PATHS OR TRAILS
 13 - BIKE LANE
 14 - TOLL BOOTH
 99 - OTHER / UNKNOWN

MANNER OF CRASH COLLISION/IMPACT
 1 - NOT COLLISION BETWEEN TWO MOTOR VEHICLES IN TRANSPORT
 2 - REAR-END
 3 - HEAD-ON
 4 - REAR-TO-REAR
 5 - BACKING
 6 - ANGLE
 7 - SIDESWIPE, SAME DIRECTION
 8 - SIDESWIPE, OPPOSITE DIRECTION
 9 - OTHER / UNKNOWN

DIRECTION OF TRAVEL
 1 - NORTH
 2 - SOUTH
 3 - EAST
 4 - WEST
 MEDIAN TYPE
 1 - DIVIDED FLUSH MEDIAN (<4 FEET)
 2 - DIVIDED FLUSH MEDIAN (≥4 FEET)
 3 - DIVIDED, DEPRESSED MEDIAN (ANY TYPE)
 4 - DIVIDED, RAISED MEDIAN (ANY TYPE)
 9 - OTHER/UNKNOWN

WORK ZONE RELATED
 WORKERS PRESENT
 LAW ENFORCEMENT PRESENT
 ACTIVE SCHOOL ZONE

WORK ZONE TYPE
 1 - LANE CLOSURE
 2 - LANE SHIFT/CROSSOVER
 3 - WORK ON SHOULDER OR MEDIAN
 4 - INTERMITTENT OR MOVING WORK
 5 - OTHER

LOCATION OF CRASH IN WORK ZONE
 1 - BEFORE THE 1ST WORK ZONE WARNING SIGN
 2 - ADVANCE WARNING AREA
 3 - TRANSITION AREA
 4 - ACTIVITY AREA
 5 - TERMINATION AREA

CONTOUR
3
 1 - STRAIGHT LEVEL
 2 - STRAIGHT GRADE
 3 - CURVE LEVEL
 4 - CURVE GRADE
 9 - OTHER/UNKNOWN
 CONDITIONS
2
 1 - DRY
 2 - WET
 3 - SNOW
 4 - ICE
 5 - SAND, MUD, DIRT, OIL, GRAVEL
 6 - WATER (STANDING, MOVING)
 7 - SLUSH
 9 - OTHER/UNKNOWN
 SURFACE
2
 1 - CONCRETE
 2 - BLACKTOP, BITUMINOUS, ASPHALT
 3 - BRICK/BLOCK
 4 - SLAG, GRAVEL, STONE
 5 - DIRT
 9 - OTHER/UNKNOWN

LIGHT CONDITION
 1 - DAYLIGHT
 2 - DAWN/DUSK
 3 - DARK - LIGHTED ROADWAY
 4 - DARK - ROADWAY NOT LIGHTED
 5 - DARK - UNKNOWN ROADWAY LIGHTING
 9 - OTHER / UNKNOWN
2

WEATHER
 1 - CLEAR
 2 - CLOUDY
 3 - FOG, SMOG, SMOKE
 4 - RAIN
 5 - SLEET, HAIL
 6 - SNOW
 7 - SEVERE CROSSWINDS
 8 - BLOWING SAND, SOIL, DIRT, SNOW
 9 - FREEZING RAIN OR FREEZING DRIZZLE
 99 - OTHER / UNKNOWN
0 3

NARRATIVE

Unit 1 was traveling W/B on STHY 261. A deer was crossing the road S/B and Unit 1 struck the deer in the W/B lane.

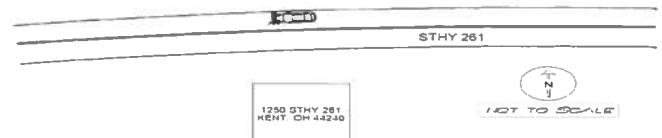
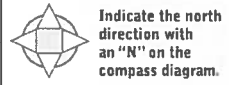

CRASH REPORTED DATE / TIME: **0 7 1 2 2 0 2 1 / 0 5 2 3**
 DISPATCH DATE / TIME: **0 7 1 2 2 0 2 1 / 0 5 2 5**
 ARRIVAL DATE / TIME: **0 7 1 2 2 0 2 1 / 0 5 3 0**
 SCENE CLEARED DATE / TIME: **0 7 1 2 2 0 2 1 / 0 5 4 2**
 REPORT TAKEN BY
 POLICE AGENCY
 MOTORIST
 SUPPLEMENT (CORRECTION OR ADDITION TO AN EXISTING REPORT SENT TO COPS)
 TOTAL TIME ROADWAY CLOSED: **0 0 0**
 OTHER INVESTIGATION TIME: **0 3 0**
 TOTAL MINUTES: **0 4 7**
 OFFICER'S NAME*: **Schmitt, Benjamin**
 OFFICER'S BADGE NUMBER*: **2 3 3**
 CHECKED BY OFFICER'S NAME*: **Nelson, Josh**
 CHECKED BY OFFICER'S BADGE NUMBER*: **2 3 2**

OWNER

UNIT # 01 OWNER NAME: LAST, FIRST, MIDDLE (X) SAME AS DRIVER
HICKS, DOMINICK, ANDREW

OWNER ADDRESS: STREET, CITY, STATE, ZIP (X) SAME AS DRIVER
4177 WHITESTONE RD, Brimfield Twp, OH 44240

COMMERCIAL CARRIER: NAME, ADDRESS, CITY, STATE, ZIP

OWNER PHONE: INCLUDE AREA CODE (X) SAME AS DRIVER

COMMERCIAL CARRIER PHONE: INCLUDE AREA CODE

VEHICLE

LP STATE OH LICENSE PLATE # HBM2808 VEHICLE IDENTIFICATION # 2HGFC1F36LH681615 VEHICLE YEAR 2020 VEHICLE MAKE Honda

INSURANCE VERIFIED (X) INSURANCE COMPANY GEICO INSURANCE POLICY # 4381132804 COLOR GRY VEHICLE MODEL CIVIC

TYPE OF USE: COMMERCIAL GOVERNMENT IN EMERGENCY RESPONSE

US DOT # _____ TOWED BY: COMPANY NAME _____

HAZARDOUS MATERIAL: MATERIAL RELEASED CLASS # _____ PLACARD ID # _____
 PLACARD _____

INTERLOCK DEVICE EQUIPPED HIT/SKIP UNIT #OCCUPANTS 01

VEHICLE WEIGHT GVWR/GCWR: 1 - <10K LBS, 2 - 10,001 - 26K LBS, 3 - >26K LBS

UNIT TYPE 01

1 - PASSENGER CAR	7 - MOTORCYCLE 2-WHEELED	12 - GOLF CART	18 - LIMO (LIVERY VEHICLE)	23 - PEDESTRIAN / SKATER
2 - PASSENGER VAN (MINIVAN)	8 - MOTORCYCLE 3-WHEELED	13 - SNOWMOBILE	19 - BUS (16+ PASSENGERS)	24 - WHEELCHAIR (ANY TYPE)
3 - SPORT UTILITY VEHICLE	9 - AUTOCYCLE	14 - SINGLE UNIT TRUCK	20 - OTHER VEHICLE	25 - OTHER NON-MOTORIST
4 - PICK UP	10 - MOPED OR MOTORIZED BICYCLE	15 - SEMI-TRACTOR	21 - HEAVY EQUIPMENT	26 - BICYCLE
5 - CARGO VAN	11 - ALL TERRAIN VEHICLE (ATV / UTV)	16 - FARM EQUIPMENT	22 - ANIMAL WITH RIDER OR ANIMAL-DRAWN VEHICLE	27 - TRAIN
6 - VAN (9-15 SEATS)		17 - MOTORHOME		99 - UNKNOWN OR HIT/SKIP

OF TRAILING UNITS _____

WAS VEHICLE OPERATING IN AUTONOMOUS MODE WHEN CRASH OCCURRED? 2

AUTONOMOUS MODE LEVEL 0

SPECIAL FUNCTION 01

1 - NONE	6 - BUS - CHARTER/TOUR	11 - FIRE	16 - FARM	21 - MAIL CARRIER
2 - TAXI	7 - BUS - INTERCITY	12 - MILITARY	17 - MOWING	99 - OTHER / UNKNOWN
3 - ELECTRONIC RIDE SHARING	8 - BUS - SHUTTLE	13 - POLICE	18 - SNOW REMOVAL	
4 - SCHOOL TRANSPORT	9 - BUS - OTHER	14 - PUBLIC UTILITY	19 - TOWING	
5 - BUS - TRANSIT/COMMUTER	10 - AMBULANCE	15 - CONSTRUCTION EQUIPMENT	20 - SAFETY SERVICE PATROL	

CARGO BODY TYPE 01

1 - NO CARGO BODY TYPE / NOT APPLICABLE	3 - VEHICLE TOWING ANOTHER MOTOR VEHICLE	5 - INTERMODAL CONTAINER CHASSIS	8 - POLE	12 - CONCRETE MIXER
2 - BUS	4 - LOGGING	6 - CARGO VAN/ENCLOSED BOX	9 - CARGO TANK	13 - AUTO TRANSPORTER
		7 - GRAIN/CHIPS/GRAVEL	10 - FLAT BED	14 - GARBAGE/REFUSE
			11 - DUMP	99 - OTHER / UNKNOWN

VEHICLE DEFECTS

1 - TURN SIGNALS	4 - BRAKES	7 - WORN OR SLICK TIRES	9 - MOTOR TROUBLE	99 - OTHER / UNKNOWN
2 - HEAD LAMPS	5 - STEERING	8 - TRAILER EQUIPMENT DEFECTIVE	10 - DISABLED FROM PRIOR ACCIDENT	
3 - TAIL LAMPS	6 - TIRE BLOWOUT			

NON-MOTORIST LOCATION AT IMPACT

1 - INTERSECTION - MARKED CROSSWALK	3 - INTERSECTION - OTHER	6 - BICYCLE LANE	9 - MEDIAN/CROSSING ISLAND	12 - FIRST RESPONDER AT INCIDENT SCENE
2 - INTERSECTION - UNMARKED CROSSWALK	4 - MIDBLOCK - MARKED CROSSWALK	7 - SHOULDER / ROADSIDE	10 - DRIVEWAY ACCESS	99 - OTHER / UNKNOWN
	5 - TRAVEL LANE - OTHER LOCATION	8 - SIDEWALK	11 - SHARED USE PATHS OR TRAILS	

ACTION 3

1 - NON-CONTACT	1 - STRAIGHT AHEAD	7 - MAKING U-TURN	13 - NEGOTIATING A CURVE	18 - APPROACHING OR LEAVING VEHICLE
2 - NON-COLLISION	2 - BACKING	8 - ENTERING TRAFFIC LANE	14 - ENTERING OR CROSSING SPECIFIED LOCATION	19 - STANDING
3 - STRIKING	3 - CHANGING LANES	9 - LEAVING TRAFFIC LANE	15 - WALKING, RUNNING, JOGGING, PLAYING	20 - OTHER NON-MOTORIST
4 - STRUCK	4 - OVERTAKING/PASSING	10 - PARKED	16 - WORKING	21 - STANDING OUTSIDE DISABLED VEHICLE
5 - BOTH STRIKING & STRUCK	5 - MAKING RIGHT TURN	11 - SLOWING OR STOPPED IN TRAFFIC	17 - PUSHING VEHICLE	99 - OTHER / UNKNOWN
9 - OTHER / UNKNOWN	6 - MAKING LEFT TURN	12 - DRIVERLESS		

CONTRIBUTING CIRCUMSTANCES 01

1 - NONE	7 - LEFT OF CENTER	13 - IMPROPER START FROM A PARKED POSITION	17 - VISION OBSTRUCTION	21 - LYING IN ROADWAY
2 - FAILURE TO YIELD	8 - FOLLOWING TOO CLOSE / ACCD	14 - STOPPED OR PARKED ILLEGALLY	18 - OPERATING DEFECTIVE EQUIPMENT	22 - NOT DISCERNIBLE
3 - RAN RED LIGHT	9 - IMPROPER LANE CHANGE	15 - SWERVING TO AVOID	19 - LOAD SHIFTING/FALLING/ SPILLING	23 - OPENING DOOR INTO ROADWAY
4 - RAN STOP SIGN	10 - IMPROPER PASSING	16 - WRONG WAY	20 - IMPROPER CROSSING	99 - OTHER IMPROPER ACTION
5 - UNSAFE SPEED	11 - DROVE OFF ROAD			
6 - IMPROPER TURN	12 - IMPROPER BACKING			

SEQUENCE OF EVENTS

EVENTS

1 <u>18</u>	1 - OVERTURN/ROLLOVER	6 - EQUIPMENT FAILURE	11 - CROSS CENTERLINE - OPPOSITE DIRECTION OF TRAVEL	16 - RAILWAY VEHICLE	22 - WORK ZONE MAINTENANCE EQUIPMENT
2	2 - FIRE/EXPLOSION	7 - SEPARATION OF UNITS	12 - DOWNHILL RUNAWAY	17 - ANIMAL - FARM	23 - STRUCK BY FALLING, SHIFTING CARGO OR ANYTHING SET IN MOTION BY A MOTOR VEHICLE
3	3 - IMMERSION	8 - RAN OFF ROAD RIGHT	13 - OTHER NON-COLLISION	18 - ANIMAL - DEER	24 - OTHER MOVABLE OBJECT
4	4 - JACKKNIFE	9 - RAN OFF ROAD LEFT	14 - PEDESTRIAN	19 - ANIMAL - OTHER	
5	5 - CARGO / EQUIPMENT LOSS OR SHIFT	10 - CROSS MEDIAN	15 - PEJALCYCLE	20 - MOTOR VEHICLE IN TRANSPORT	
6				21 - PARKED MOTOR VEHICLE	

COLLISION WITH FIXED OBJECT - STRUCK

25 - IMPACT ATTENUATOR / CRASH CUSHION	31 - GUARDRAIL END	37 - TRAFFIC SIGN POST	43 - CURB	50 - WORK ZONE MAINTENANCE EQUIPMENT
26 - BRIDGE OVERHEAD STRUCTURE	32 - PORTABLE BARRIER	38 - OVERHEAD SIGN POST	44 - DITCH	51 - WALL
27 - BRIDGE PIER OR ABUTMENT	33 - MEDIAN CABLE BARRIER	39 - LIGHT / LUMINARIES SUPPORT	45 - EMBANKMENT	52 - BUILDING
28 - BRIDGE PARAPET	34 - MEDIAN GUARDRAIL BARRIER	40 - UTILITY POLE	46 - FENCE	53 - TUNNEL
29 - BRIDGE RAIL	35 - MEDIAN CONCRETE BARRIER	41 - OTHER POST, POLE OR SUPPORT	47 - MAILBOX	54 - OTHER FIXED OBJECT
30 - GUARDRAIL FACE	36 - MEDIAN OTHER BARRIER	42 - CULVERT	48 - TREE	99 - OTHER / UNKNOWN
			49 - FIRE HYDRANT	

UNIT SPEED 035

POSTED SPEED 50

DETECTED SPEED 1

1 - STATED / ESTIMATED SPEED
2 - CALCULATED / EDR
3 - UNDETERMINED

LOCAL REPORT NUMBER
2021-00011188

DAMAGE

DAMAGE SCALE 3

1 - NONE
2 - MINOR DAMAGE
3 - FUNCTIONAL DAMAGE
4 - DISABLING DAMAGE
9 - UNKNOWN

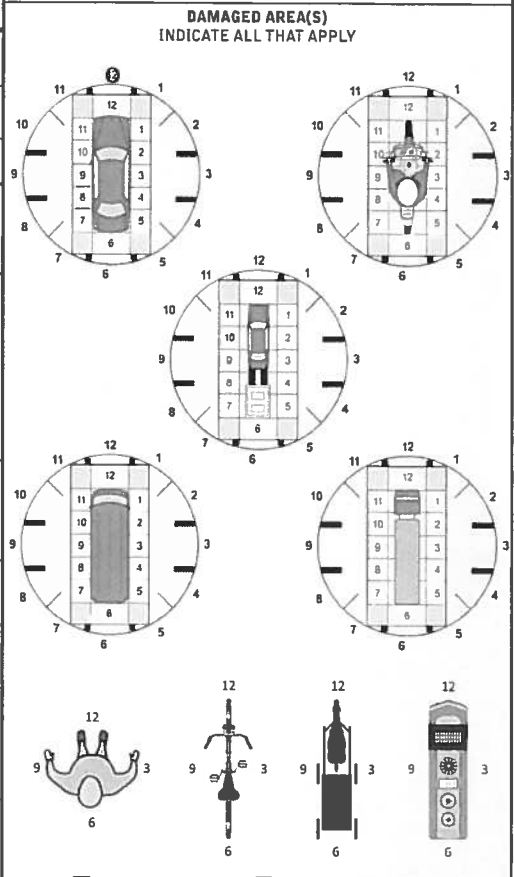

INITIAL POINT OF CONTACT

12

0 - NO DAMAGE
1-12 - REFER TO UNIT DIAGRAM
13 - TOP
14 - UNDERCARRIAGE
15 - VEHICLE NOT AT SCENE
99 - UNKNOWN

TRAFFIC

TRAFFICWAY FLOW 2

1 - ONE-WAY
2 - TWO-WAY

TRAFFIC CONTROL 6

1 - ROUNDABOUT
2 - SIGNAL
3 - FLASHER
4 - STOP SIGN
5 - YIELD SIGN
6 - NO CONTROL

OF THROUGH LANES ON ROAD 2

RAIL GRADE CROSSING 1

1 - NOT INVOLVED
2 - INVOLVED-ACTIVE CROSSING
3 - INVOLVED-PASSIVE CROSSING

UNIT / NON-MOTORIST DIRECTION

FROM 3 TO 4

1 - NORTH
2 - SOUTH
3 - EAST
4 - WEST
5 - NORTHWEST
6 - SOUTHWEST
7 - SOUTHWEST
8 - SOUTHWEST
9 - OTHER / UNKNOWN

UNIT SPEED 035

POSTED SPEED 50

DETECTED SPEED 1

1 - STATED / ESTIMATED SPEED
2 - CALCULATED / EDR
3 - UNDETERMINED



MOTORIST / Non-MOTORIST

LOCAL REPORT NUMBER
 2, 0, 2, 1 - 0, 0, 0, 1, 1, 1, 8, 8

UNIT # **0, 1** NAME: LAST, FIRST, MIDDLE
HICKS, DOMINICK, ANDREW

DATE OF BIRTH **10 / 28 / 1998** AGE **22** GENDER **M**

ADDRESS: STREET, CITY, STATE, ZIP
4177 WHITESTONE RD ,Brimfield Twp ,OH 44240

CONTACT PHONE - INCLUDE AREA CODE

INJURIES **5** **INJURED TAKEN BY** **EMS AGENCY (NAME)** **INJURED TAKEN TO: MEDICAL FACILITY (NAME, CITY)** **SAFETY EQUIPMENT USED** **0, 4** DOT-COMPLIANT MC HELMET **SEATING POSITION** **0 1** **AIR BAG USAGE** **1** **EJECTION** **1** **TRAPPED** **1**

OL STATE **O, H** **OPERATOR LICENSE NUMBER** **OFFENSE CHARGED** **LOCAL CODE** **OFFENSE DESCRIPTION** **CITATION NUMBER**

OL CLASS **4** **ENDORSEMENT** **RESTRICTION** **DRIVER DISTRACTED BY** **1** **ALCOHOL / DRUG SUSPECTED** ALCOHOL MARIJUANA OTHER DRUG **CONDITION** **1** **ALCOHOL TEST** **DRUG TEST(S)**

UNIT # NAME: LAST, FIRST, MIDDLE

DATE OF BIRTH AGE GENDER

ADDRESS: STREET, CITY, STATE, ZIP

CONTACT PHONE - INCLUDE AREA CODE

INJURIES **INJURED TAKEN BY** **EMS AGENCY (NAME)** **INJURED TAKEN TO: MEDICAL FACILITY (NAME, CITY)** **SAFETY EQUIPMENT USED** DOT-COMPLIANT MC HELMET **SEATING POSITION** **AIR BAG USAGE** **EJECTION** **TRAPPED**

OL STATE **OPERATOR LICENSE NUMBER** **OFFENSE CHARGED** **LOCAL CODE** **OFFENSE DESCRIPTION** **CITATION NUMBER**

OL CLASS **ENDORSEMENT** **RESTRICTION** **DRIVER DISTRACTED BY** **ALCOHOL / DRUG SUSPECTED** ALCOHOL MARIJUANA OTHER DRUG **CONDITION** **ALCOHOL TEST** **DRUG TEST(S)**

UNIT # NAME: LAST, FIRST, MIDDLE

DATE OF BIRTH AGE GENDER

ADDRESS: STREET, CITY, STATE, ZIP

CONTACT PHONE - INCLUDE AREA CODE

INJURIES **INJURED TAKEN BY** **EMS AGENCY (NAME)** **INJURED TAKEN TO: MEDICAL FACILITY (NAME, CITY)** **SAFETY EQUIPMENT USED** DOT-COMPLIANT MC HELMET **SEATING POSITION** **AIR BAG USAGE** **EJECTION** **TRAPPED**

OL STATE **OPERATOR LICENSE NUMBER** **OFFENSE CHARGED** **LOCAL CODE** **OFFENSE DESCRIPTION** **CITATION NUMBER**

OL CLASS **ENDORSEMENT** **RESTRICTION** **DRIVER DISTRACTED BY** **ALCOHOL / DRUG SUSPECTED** ALCOHOL MARIJUANA OTHER DRUG **CONDITION** **ALCOHOL TEST** **DRUG TEST(S)**

INJURIES	SEATING POSITION	AIR BAG	OL CLASS	OL RESTRICTION(S)	DRIVER DISTRACTION	TEST STATUS
1 - FATAL	1 - FRONT - LEFT SIDE (MOTORCYCLE DRIVER)	1 - NOT DEPLOYED	1 - CLASS A	1 - ALCOHOL INTERLOCK DEVICE	1 - NOT DISTRACTED	1 - NONE GIVEN
2 - SUSPECTED SERIOUS INJURY	2 - FRONT - MIDDLE	2 - DEPLOYED FRONT	2 - CLASS B	2 - COL INTRASTATE ONLY	2 - MANUALLY OPERATING AN ELECTRONIC COMMUNICATION DEVICE (TEXTING, TYPING, DIALING)	2 - TEST REFUSED
3 - SUSPECTED MINOR INJURY	3 - FRONT - RIGHT SIDE	3 - DEPLOYED SIDE	3 - CLASS C	3 - CORRECTIVE LENSES	3 - TALKING ON HANDS-FREE COMMUNICATION DEVICE	3 - TEST GIVEN, CONTAMINATED SAMPLE / UNUSABLE
4 - POSSIBLE INJURY	4 - SECOND - LEFT SIDE (MOTORCYCLE PASSENGER)	4 - DEPLOYED BOTH FRONT / SIDE	4 - REGULAR CLASS (OHIO - D)	4 - FARM WAIVER	4 - TALKING ON HAND-HELD COMMUNICATION DEVICE	4 - TEST GIVEN, RESULTS KNOWN
5 - NO APPARENT INJURY	5 - SECOND - MIDDLE	5 - NOT APPLICABLE	5 - MC MOPED ONLY	5 - EXCEPT CLASS A BUS	5 - OTHER ACTIVITY WITH AN ELECTRONIC DEVICE	5 - TEST GIVEN, RESULTS UNKNOWN
INJURED TAKEN BY	6 - SECOND - RIGHT SIDE	9 - DEPLOYMENT UNKNOWN	6 - NO VALID DL	6 - EXCEPT CLASS A & CLASS B BUS	6 - PASSENGER	ALCOHOL TEST TYPE
1 - NOT TRANSPORTED / TREATED AT SCENE	7 - THIRD - LEFT SIDE (MOTORCYCLE SIDE CAR)	EJECTION	OL ENDORSEMENT	7 - EXCEPT TRACTOR-TRAILER	7 - OTHER DISTRACTION INSIDE THE VEHICLE	1 - NONE
2 - EMS	8 - THIRD - MIDDLE	1 - NOT EJECTED	H - HAZMAT	8 - INTERMEDIATE LICENSE RESTRICTIONS	8 - OTHER DISTRACTION OUTSIDE THE VEHICLE	2 - BLOOD
3 - POLICE	9 - THIRD - RIGHT SIDE	2 - PARTIALLY EJECTED	M - MOTORCYCLE	9 - LEARNER'S PERMIT RESTRICTIONS	9 - OTHER / UNKNOWN	3 - URINE
9 - OTHER / UNKNOWN	10 - SLEEPER SECTION OF TRUCK CAB	3 - TOTALLY EJECTED	P - PASSENGER	10 - LIMITED TO DAYLIGHT ONLY	CONDITION	4 - BREATH
SAFETY EQUIPMENT	11 - PASSENGER IN OTHER ENCLOSED CARGO AREA (NON-TRAILING UNIT, BUS, PICK-UP WITH CAP)	4 - NOT APPLICABLE	N - TANKER	11 - LIMITED TO EMPLOYMENT	1 - APPARENTLY NORMAL	5 - OTHER
1 - NONE USED	12 - PASSENGER IN UNENCLOSED CARGO AREA	TRAPPED	Q - MOTOR SCOOTER	12 - LIMITED - OTHER	2 - PHYSICAL IMPAIRMENT	DRUG TEST TYPE
2 - SHOULDER BELT ONLY USED	13 - TRAILING UNIT	1 - NOT TRAPPED	R - THREE-WHEEL MOTORCYCLE	13 - MECHANICAL DEVICES (SPECIAL BRAKES, HAND CONTROLS, OR OTHER ADAPTIVE DEVICES)	3 - EMOTIONAL (E.G. DEPRESSED, ANGRY, DISTURBED)	1 - NONE
3 - LAP BELT ONLY USED	14 - RIDING ON VEHICLE EXTERIOR (NON-TRAILING UNIT)	2 - EXTRICATED BY MECHANICAL MEANS	S - SCHOOL BUS	14 - MILITARY VEHICLES ONLY	4 - ILLNESS	2 - BLOOD
4 - SHOULDER & LAP BELT USED	15 - NON-MOTORIST	3 - FREED BY NON-MECHANICAL MEANS	T - DOUBLE & TRIPLE TRAILERS	15 - MOTOR VEHICLES WITHOUT AIR BRAKES	5 - FELL ASLEEP, FAINTED, FATIGUED, ETC.	3 - URINE
5 - CHILD RESTRAINT SYSTEM - FORWARD FACING	99 - OTHER / UNKNOWN		X - TANKER / HAZMAT	16 - OUTSIDE MIRROR	6 - UNDER THE INFLUENCE OF MEDICATIONS / DRUGS / ALCOHOL	4 - BREATH
6 - CHILD RESTRAINT SYSTEM - REAR FACING			GENDER	17 - PROSTHETIC AID	9 - OTHER / UNKNOWN	5 - OTHER
7 - BOOSTER SEAT			F - FEMALE	18 - OTHER		DRUG TEST RESULT(S)
8 - HELMET USED			M - MALE			1 - AMPHETAMINES
9 - PROTECTIVE PADS USED (ELBOW, KNEES, ETC.)			U - OTHER / UNKNOWN			2 - BARBITURATES
10 - REFLECTIVE CLOTHING						3 - BENZODIAZEPINES
11 - LIGHTING - PEDESTRIAN / BICYCLE ONLY						4 - CANNABINOIDS
99 - OTHER / UNKNOWN						5 - COCAINE
						6 - OPIATES / OPIOIDS
						7 - OTHER
						8 - NEGATIVE RESULTS