



# TRAFFIC CRASH REPORT

\*DENOTES MANDATORY FIELD FOR SUPPLEMENT REPORT

LOCAL REPORT NUMBER\*

2 0 2 3 - 0 0 0 0 5 4 8 9

PHOTOS TAKEN  
 SECONDARY CRASH  
 OH-2  OH-3  
 OH-1P  OTHER  
 PRIVATE PROPERTY

LOCAL INFORMATION  
 REPORTING AGENCY NAME\*  
**City of Kent Police**  
 NCIC\*  
**0 6 7 0 3**

HIT/SKIP  
 1 - SOLVED  
 2 - UNSOLVED  
 NUMBER OF UNITS  
**0 2**  
 UNIT IN ERROR  
 98 - ANIMAL  
 99 - UNKNOWN  
**0 2**

COUNTY\* **6 7** LOCALITY\* **1** LOCATION: CITY, VILLAGE, TOWNSHIP\*  
**Kent**

CRASH DATE / TIME\*  
**04102023 / 1256**  
 CRASH SEVERITY  
 1 - FATAL  
 2 - SERIOUS INJURY SUSPECTED  
 3 - MINOR INJURY SUSPECTED  
 4 - INJURY POSSIBLE  
 5 - PROPERTY DAMAGE ONLY  
**5**

ROUTE TYPE **S R** ROUTE NUMBER **43** PREFIX **1** LOCATION ROAD NAME  
**MANTUA** ROAD TYPE **S T**

LATITUDE DECIMAL DEGREES  
**41.158584**

ROUTE TYPE ROUTE NUMBER PREFIX N - NORTH S - SOUTH E - EAST W - WEST  
 REFERENCE ROAD NAME (ROAD, MILEPOST, HOUSE #)  
**600** ROAD TYPE

LONGITUDE DECIMAL DEGREES  
**-81.359888**

REFERENCE POINT  
 1 - INTERSECTION  
 2 - MILE POST  
 3 - HOUSE #  
**3**  
 DIRECTION FROM REFERENCE  
 N - NORTH  
 S - SOUTH  
 E - EAST  
 W - WEST  
 ROUTE TYPE  
 IR - INTERSTATE ROUTE (TP)  
 US - FEDERAL US ROUTE  
 SR - STATE ROUTE  
 CR - NUMBERED COUNTY ROUTE  
 TR - NUMBERED TOWNSHIP ROUTE  
 ROAD TYPE  
 AL - ALLEY HW - HIGHWAY RD - ROAD  
 AV - AVENUE LA - LANE SQ - SQUARE  
 BL - BOULEVARD MP - MILEPOST ST - STREET  
 CR - CIRCLE OV - OVAL TE - TERRACE  
 CT - COURT PK - PARKWAY TL - TRAIL  
 DR - DRIVE PI - PIKE WA - WAY  
 HE - HEIGHTS PL - PLACE

INTERSECTION RELATED  
 WITHIN INTERSECTION OR ON APPROACH  
 WITHIN INTERCHANGE AREA  
 NUMBER OF APPROACHES  
**4**

ROADWAY  
 ROADWAY DIVIDED

LOCATION OF FIRST HARMFUL EVENT  
 1 - ON ROADWAY  
 2 - ON SHOULDER  
 3 - IN MEDIAN  
 4 - ON ROADSIDE  
 5 - ON GORE  
 6 - OUTSIDE TRAFFIC WAY  
 7 - ON RAMP  
 8 - OFF RAMP  
**0 1**  
 9 - CROSSOVER  
 10 - DRIVEWAY/ALLEY ACCESS  
 11 - RAILWAY GRADE CROSSING  
 12 - SHARED USE PATHS OR TRAILS  
 13 - BIKE LANE  
 14 - TOLL BOOTH  
 99 - OTHER / UNKNOWN

MANNER OF CRASH COLLISION/IMPACT  
 1 - NOT COLLISION BETWEEN TWO MOTOR VEHICLES IN TRANSPORT  
 2 - REAR-END  
 3 - HEAD-ON  
 4 - REAR-TO-REAR  
 5 - BACKING  
 6 - ANGLE  
 7 - SIDESWIPE, SAME DIRECTION  
 8 - SIDESWIPE, OPPOSITE DIRECTION  
 9 - OTHER / UNKNOWN  
**2**

DIRECTION OF TRAVEL  
 N - NORTH  
 S - SOUTH  
 E - EAST  
 W - WEST  
 MEDIAN TYPE  
 1 - DIVIDED FLUSH MEDIAN (<4 FEET)  
 2 - DIVIDED FLUSH MEDIAN (≥4 FEET)  
 3 - DIVIDED, DEPRESSED MEDIAN (ANYTYPE)  
 4 - DIVIDED, RAISED MEDIAN (ANYTYPE)  
 9 - OTHER/UNKNOWN

WORK ZONE RELATED  
 WORKERS PRESENT  
 LAW ENFORCEMENT PRESENT  
 ACTIVE SCHOOL ZONE

WORK ZONE TYPE  
 1 - LANE CLOSURE  
 2 - LANE SHIFT/CROSSOVER  
 3 - WORK ON SHOULDER OR MEDIAN  
 4 - INTERMITTENT OR MOVING WORK  
 5 - OTHER

LOCATION OF CRASH IN WORK ZONE  
 1 - BEFORE THE 1ST WORK ZONE WARNING SIGN  
 2 - ADVANCE WARNING AREA  
 3 - TRANSITION AREA  
 4 - ACTIVITY AREA  
 5 - TERMINATION AREA

CONTOUR  
**1**  
 1 - STRAIGHT LEVEL  
 2 - STRAIGHT GRADE  
 3 - CURVE LEVEL  
 4 - CURVE GRADE  
 9 - OTHER/UNKNOWN

CONDITIONS  
**1**  
 1 - DRY  
 2 - WET  
 3 - SNOW  
 4 - ICE  
 5 - SAND, MUD, DIRT, OIL, GRAVEL  
 6 - WATER (STANDING, MOVING)  
 7 - SLUSH  
 9 - OTHER/UNKNOWN

SURFACE  
**2**  
 1 - CONCRETE  
 2 - BLACKTOP, BITUMINOUS, ASPHALT  
 3 - BRICK/BLOCK  
 4 - SLAG, GRAVEL, STONE  
 5 - DIRT  
 9 - OTHER/UNKNOWN

LIGHT CONDITION  
**1**  
 1 - DAYLIGHT  
 2 - DAWN/DUSK  
 3 - DARK - LIGHTED ROADWAY  
 4 - DARK - ROADWAY NOT LIGHTED  
 5 - DARK - UNKNOWN ROADWAY LIGHTING  
 9 - OTHER / UNKNOWN

WEATHER  
**0 1**  
 1 - CLEAR  
 2 - CLOUDY  
 3 - FOG, SMOG, SMOKE  
 4 - RAIN  
 5 - SLEET, HAIL  
 6 - SNOW  
 7 - SEVERE CROSSWINDS  
 8 - BLOWING SAND, SOIL, DIRT, SNOW  
 9 - FREEZING RAIN OR FREEZING DRIZZLE  
 99 - OTHER / UNKNOWN

CONTAINS NARRATIVE AND DIAGRAM

NARRATIVE  
**In the center lane, both units traveled south on N. Mantua (SR43) at 600. The light turned green, and Unit Two traveled forward, failing to maintain an assured clear distance striking Unit One.**

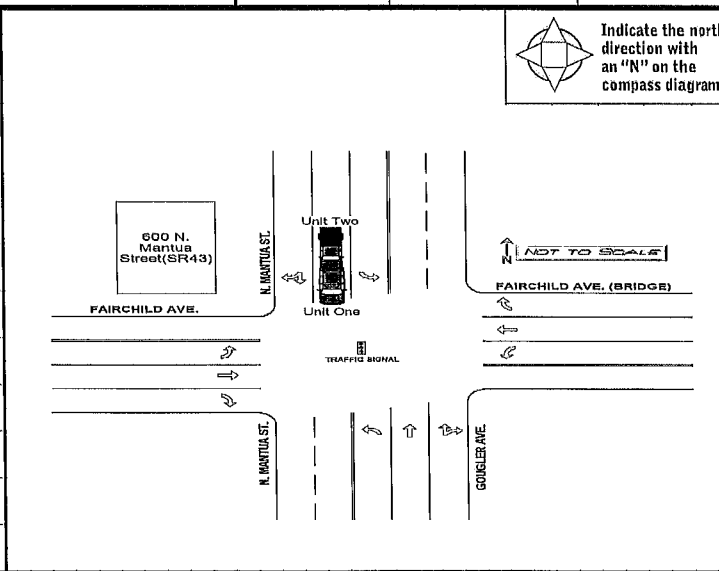

CRASH REPORTED DATE / TIME: **0,4,1,0,2,0,2,3 / 1,2,5,6**  
 DISPATCH DATE / TIME: **0,4,1,0,2,0,2,3 / 1,2,5,8**  
 ARRIVAL DATE / TIME: **0,4,1,0,2,0,2,3 / 1,3,0,1**  
 SCENE CLEARED DATE / TIME: **0,4,1,0,2,0,2,3 / 1,3,3,0**  
 REPORT TAKEN BY  
 POLICE AGENCY  
 MOTORIST  
 SUPPLEMENT (CORRECTION OR ADDITION TO AN EXISTING REPORT SENT TO SOPS)  
 TOTAL TIME ROADWAY CLOSED: **0 0 0**  
 OTHER INVESTIGATION TIME: **0 1 0**  
 TOTAL MINUTES: **0 4 2**  
 OFFICER'S NAME\*: **Butcher, Matthew**  
 OFFICER'S BADGE NUMBER\*: **2 3 4**  
 CHECKED BY OFFICER'S NAME\*: **Nelson, Josh**  
 CHECKED BY OFFICER'S BADGE NUMBER\*: **2 3 2**

**OWNER**  
 UNIT # 01 OWNER NAME: LAST, FIRST, MIDDLE (X SAME AS DRIVER) **CARTER, RACHEL, ANNE**  
 OWNER ADDRESS: STREET, CITY, STATE, ZIP (X SAME AS DRIVER) **7523 DIAGONAL RD, Franklin Twp, OH 44240**  
 COMMERCIAL CARRIER: NAME, ADDRESS, CITY, STATE, ZIP \_\_\_\_\_  
 OWNER PHONE: (INCLUDE AREA CODE) (X SAME AS DRIVER) \_\_\_\_\_  
 COMMERCIAL CARRIER PHONE: (INCLUDE AREA CODE) \_\_\_\_\_

**VEHICLE**  
 LP STATE OH LICENSE PLATE # HNB9154 VEHICLE IDENTIFICATION # 3VV2B7AX0JML10540 VEHICLE YEAR 2018 VEHICLE MAKE Volkswagen  
 INSURANCE VERIFIED INSURANCE COMPANY GRANGE INSURANCE POLICY # 4642418 COLOR SIL VEHICLE MODEL TIGUAN  
 COMMERCIAL TYPE OF USE  GOVERNMENT  IN EMERGENCY RESPONSE US DOT # \_\_\_\_\_ TOWED BY: COMPANY NAME \_\_\_\_\_  
 INTERLOCK DEVICE EQUIPPED  HIT/SKIP UNIT #OCCUPANTS 01 VEHICLE WEIGHT GVW/GCWR  
 1 - <10K LBS. 2 - 10,001 - 26K LBS. 3 - >26K LBS. HAZARDOUS MATERIAL  
 MATERIAL RELEASED CLASS # \_\_\_\_\_ PLACARD ID # \_\_\_\_\_  
 PLACARD \_\_\_\_\_

**UNIT TYPE**  
03 1 - PASSENGER CAR 7 - MOTORCYCLE 2-WHEELED 12 - GOLF CART 18 - LIMO (LIVERY VEHICLE) 23 - PEDESTRIAN / SKATER  
 2 - PASSENGER VAN (MINIVAN) 8 - MOTORCYCLE 3-WHEELED 13 - SNOWMOBILE 19 - BUS (16+ PASSENGERS) 24 - WHEELCHAIR (ANY TYPE)  
 3 - SPORT UTILITY VEHICLE 9 - AUTOCYCLE 14 - SINGLE UNIT TRUCK 20 - OTHER VEHICLE 25 - OTHER NON-MOTORIST  
 4 - PICK UP 10 - MOPED OR MOTORIZED BICYCLE 15 - SEMI-TRACTOR 21 - HEAVY EQUIPMENT 26 - BICYCLE  
 5 - CARGO VAN 11 - ALL TERRAIN VEHICLE (ATV / UTV) 16 - FARM EQUIPMENT 22 - ANIMAL WITH RIDER OR ANIMAL-DRAWN VEHICLE 27 - TRAIN  
 6 - VAN (9-15 SEATS) 17 - MOTORHOME 99 - UNKNOWN OR HIT/SKIP  
 # OF TRAILING UNITS 00

WAS VEHICLE OPERATING IN AUTONOMOUS MODE WHEN CRASH OCCURRED? 2 0 - NO AUTOMATION 3 - CONDITIONAL AUTOMATION 9 - UNKNOWN  
 1 - YES 2 - NO 9 - OTHER / UNKNOWN AUTONOMOUS MODE LEVEL 0  
 1 - DRIVER ASSISTANCE 4 - HIGH AUTOMATION 5 - FULL AUTOMATION 2 - PARTIAL AUTOMATION

**SPECIAL FUNCTION**  
01 1 - NONE 6 - BUS - CHARTER/TOUR 11 - FIRE 16 - FARM 21 - MAIL CARRIER  
 2 - TAXI 7 - BUS - INTERCITY 12 - MILITARY 17 - MOWING 99 - OTHER / UNKNOWN  
 3 - ELECTRONIC RIDE SHARING 8 - BUS - SHUTTLE 13 - POLICE 18 - SNOW REMOVAL  
 4 - SCHOOL TRANSPORT 9 - BUS - OTHER 14 - PUBLIC UTILITY 19 - TOWING  
 5 - BUS - TRANSIT/COMMUTER 10 - AMBULANCE 15 - CONSTRUCTION EQUIPMENT 20 - SAFETY SERVICE PATROL

**CARGO BODY TYPE**  
01 1 - NO CARGO BODY TYPE / NOT APPLICABLE 3 - VEHICLE TOWING ANOTHER MOTOR VEHICLE 5 - INTERMODAL CONTAINER CHASSIS 8 - POLE 12 - CONCRETE MIXER  
 2 - BUS 4 - LOGGING 6 - CARGO VAN/ENCLOSED BOX 9 - CARGO TANK 13 - AUTOTRANSPORTER  
 7 - GRAIN/CHIPS/GRAVEL 10 - FLAT BED 11 - DUMP 14 - GARBAGE/REFUSE 99 - OTHER / UNKNOWN

**VEHICLE DEFECTS**  
01 1 - TURN SIGNALS 4 - BRAKES 7 - WORN OR SLICK TIRES 9 - MOTOR TROUBLE 99 - OTHER / UNKNOWN  
 2 - HEAD LAMPS 5 - STEERING 8 - TRAILER EQUIPMENT DEFECTIVE 10 - DISABLED FROM PRIOR ACCIDENT  
 3 - TAIL LAMPS 6 - TIRE BLOWOUT

**NON-MOTORIST LOCATION AT IMPACT**  
01 1 - INTERSECTION - MARKED CROSSWALK 3 - INTERSECTION - OTHER 6 - BICYCLE LANE 9 - MEDIAN/CROSSING ISLAND 12 - FIRST RESPONDER AT INCIDENT SCENE  
 2 - INTERSECTION - UNMARKED CROSSWALK 4 - MIDBLOCK - MARKED CROSSWALK 7 - SHOULDER / ROADSIDE 10 - DRIVEWAY ACCESS 11 - SHARED USE PATHS OR TRAILS 99 - OTHER / UNKNOWN  
 5 - TRAVEL LANE - OTHER LOCATION 8 - SIDEWALK

**ACTION**  
4 1 - NON-CONTACT 1 - STRAIGHT AHEAD 7 - MAKING U-TURN 13 - NEGOTIATING A CURVE 18 - APPROACHING OR LEAVING VEHICLE  
 2 - NON-COLLISION 2 - BACKING 8 - ENTERING TRAFFIC LANE 14 - ENTERING OR CROSSING SPECIFIED LOCATION 19 - STANDING  
 3 - STRIKING 3 - CHANGING LANES 9 - LEAVING TRAFFIC LANE 15 - WALKING, RUNNING, JOGGING, PLAYING 20 - OTHER NON-MOTORIST  
 4 - STRUCK PRE-CRASH ACTIONS 4 - OVERTAKING/PASSING 10 - PARKED 16 - WORKING 21 - STANDING OUTSIDE DISABLED VEHICLE  
 5 - BOTH STRIKING & STRUCK 5 - MAKING RIGHT TURN 11 - SLOWING OR STOPPED IN TRAFFIC 17 - PUSHING VEHICLE 99 - OTHER / UNKNOWN  
 9 - OTHER / UNKNOWN 6 - MAKING LEFT TURN 12 - DRIVERLESS

**CONTRIBUTING CIRCUMSTANCES**  
01 1 - NONE 7 - LEFT OF CENTER 13 - IMPROPER START FROM A PARKED POSITION 17 - VISION OBSTRUCTION 21 - LYING IN ROADWAY  
 2 - FAILURE TO YIELD 8 - FOLLOWING TOO CLOSE / ACDA 14 - STOPPED OR PARKED ILLEGALLY 18 - OPERATING DEFECTIVE EQUIPMENT 22 - NOT DISCERNIBLE  
 3 - RAN RED LIGHT 9 - IMPROPER LANE CHANGE 15 - SWERVING TO AVOID 19 - LOAD SHIFTING/FALLING/SPILLING 23 - OPENING DOOR INTO ROADWAY  
 4 - RAN STOP SIGN 10 - IMPROPER PASSING 16 - WRONG WAY 20 - IMPROPER CROSSING 99 - OTHER IMPROPER ACTION  
 5 - UNSAFE SPEED 11 - DROVE OFF ROAD 12 - IMPROPER BACKING

**SEQUENCE OF EVENTS**  
 1 20 1 - OVERTURN/ROLLOVER 6 - EQUIPMENT FAILURE 11 - CROSS CENTERLINE - OPPOSITE DIRECTION OF TRAVEL 16 - RAILWAY VEHICLE 22 - WORK ZONE MAINTENANCE EQUIPMENT  
 2 01 2 - FIRE/EXPLOSION 7 - SEPARATION OF UNITS 12 - DOWNHILL RUNAWAY 17 - ANIMAL - FARM 23 - STRUCK BY FALLING, SHIFTING CARGO OR ANYTHING SET IN MOTION BY A MOTOR VEHICLE  
 3 01 3 - IMMERSION 8 - RAN OFF ROAD RIGHT 13 - OTHER NON-COLLISION 18 - ANIMAL - DEER 24 - OTHER MOVABLE OBJECT  
 4 01 4 - JACKKNIFE 9 - RAN OFF ROAD LEFT 14 - PEDESTRIAN 19 - ANIMAL - OTHER 20 - MOTOR VEHICLE IN TRANSPORT  
 5 01 5 - CARGO / EQUIPMENT LOSS OR SHIFT 10 - CROSS MEDIAN 15 - PEDALCYCLE 21 - PARKED MOTOR VEHICLE

**COLLISION WITH FIXED OBJECT - STRUCK**  
 4 01 25 - IMPACT ATTENUATOR / CRASH CUSHION 31 - GUARDRAIL END 37 - TRAFFIC SIGN POST 43 - CURB 50 - WORK ZONE MAINTENANCE EQUIPMENT  
 5 01 26 - BRIDGE OVERHEAD STRUCTURE 32 - PORTABLE BARRIER 38 - OVERHEAD SIGN POST 44 - DITCH 51 - WALL  
 6 01 27 - BRIDGE PIER OR ABUTMENT 33 - MEDIAN CABLE BARRIER 39 - LIGHT / LUMINARIES SUPPORT 45 - EMBANKMENT 52 - BUILDING  
 28 - BRIDGE PARAPET 34 - MEDIAN GUARDRAIL BARRIER 40 - UTILITY POLE 46 - FENCE 53 - TUNNEL  
 29 - BRIDGE RAIL 35 - MEDIAN CONCRETE BARRIER 41 - OTHER POST, POLE OR SUPPORT 47 - MAILBOX 54 - OTHER FIXED OBJECT  
 30 - GUARDRAIL FACE 36 - MEDIAN OTHER BARRIER 42 - CULVERT 48 - TREE 99 - OTHER / UNKNOWN

1 FIRST HARMFUL EVENT 1 MOST HARMFUL EVENT

LOCAL REPORT NUMBER  
2023-00005489

**DAMAGE**  
 DAMAGE SCALE  
2 1 - NONE 3 - FUNCTIONAL DAMAGE  
 2 - MINOR DAMAGE 4 - DISABLING DAMAGE  
 9 - UNKNOWN

**DAMAGED AREA(S)**  
 INDICATE ALL THAT APPLY

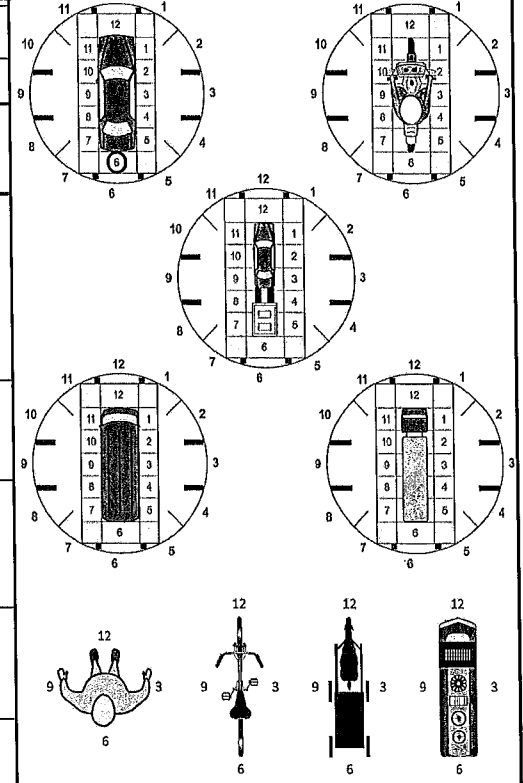

- NO DAMAGE [ 0 ]  - UNDERCARRIAGE [ 14 ]  
 - TOP [ 13 ]  - ALL AREAS [ 15 ]  
 - UNIT NOT AT SCENE [ 16 ]

**INITIAL POINT OF CONTACT**  
06 0 - NO DAMAGE 14 - UNDERCARRIAGE  
 1-12 - REFER TO UNIT DIAGRAM 15 - VEHICLE NOT AT SCENE  
 13 - TOP 99 - UNKNOWN

**TRAFFIC**  
**TRAFFICWAY FLOW**  
2 1 - ONE-WAY 2 - TWO-WAY  
**TRAFFIC CONTROL**  
2 1 - ROUNDABOUT 4 - STOP SIGN  
 2 - SIGNAL 5 - YIELD SIGN  
 3 - FLASHER 6 - NO CONTROL

**# OF THROUGH LANES ON ROAD**  
4  
**RAIL GRADE CROSSING**  
1 1 - NOT INVOLVED  
 2 - INVOLVED-ACTIVE CROSSING  
 3 - INVOLVED-PASSIVE CROSSING

**UNIT / NON-MOTORIST DIRECTION**  
 FROM 1 TO 2  
 1 - NORTH 5 - NORTHEAST  
 2 - SOUTH 6 - NORTHWEST  
 3 - EAST 7 - SOUTHEAST  
 4 - WEST 8 - SOUTHWEST  
 9 - OTHER / UNKNOWN

**UNIT SPEED**  
000  
**POSTED SPEED**  
35  
**DETECTED SPEED**  
1 1 - STATED / ESTIMATED SPEED  
 2 - CALCULATED / EDR  
 3 - UNDETERMINED

**OWNER**

UNIT # **0 2** OWNER NAME: LAST, FIRST, MIDDLE (X SAME AS DRIVER)  
**CHENOT, JOSEPH, N**

OWNER ADDRESS: STREET, CITY, STATE, ZIP (X SAME AS DRIVER)  
**13487 PEPPERTREE AVE NW, MOGADORE, OH 44260**

COMMERCIAL CARRIER: NAME, ADDRESS, CITY, STATE, ZIP  
COMMERCIAL CARRIER PHONE: INCLUDE AREA CODE

**DAMAGE**

**DAMAGE SCALE**

**1** 1 - NONE 3 - FUNCTIONAL DAMAGE  
2 - MINOR DAMAGE 4 - DISABLING DAMAGE  
9 - UNKNOWN

**VEHICLE**

LP STATE **OH** LICENSE PLATE # **PLJ3718** VEHICLE IDENTIFICATION # **1 F T 8 W 3 D T 3 M E D 4 3 1 2 6** VEHICLE YEAR **2 0 2 1** VEHICLE MAKE **Ford**

INSURANCE VERIFIED INSURANCE COMPANY **STATE FARM** INSURANCE POLICY # **2050100SFP35** COLOR **WHI** VEHICLE MODEL **F350**

COMMERCIAL TYPE OF USE  GOVERNMENT  IN EMERGENCY RESPONSE US DOT # TOWED BY: COMPANY NAME

INTERLOCK DEVICE EQUIPPED  HIT/SKIP UNIT #OCCUPANTS **0 1** VEHICLE WEIGHT GVWR/GCWR  
1 - ≤10K LBS.  
2 - 10,001 - 26K LBS.  
3 - >26K LBS. HAZARDOUS MATERIAL CLASS # PLACARD ID #

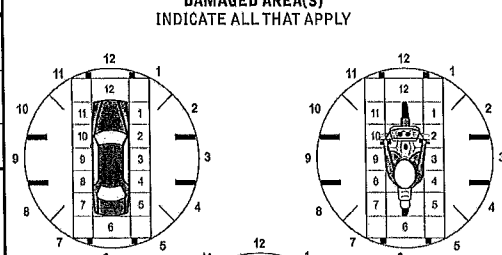

**UNIT TYPE** **0 4**

1 - PASSENGER CAR 7 - MOTORCYCLE 2-WHEELED 12 - GOLF CART 18 - LIMO (LIVERY VEHICLE) 23 - PEDESTRIAN / SKATER  
2 - PASSENGER VAN (MINIVAN) 8 - MOTORCYCLE 3-WHEELED 13 - SNOWMOBILE 19 - BUS (16+ PASSENGERS) 24 - WHEELCHAIR (ANY TYPE)  
3 - SPORT UTILITY VEHICLE 9 - AUTOCYCLE 14 - SINGLE UNIT TRUCK 20 - OTHER VEHICLE 25 - OTHER NON-MOTORIST  
4 - PICK UP 10 - MOPED OR MOTORIZED BICYCLE 15 - SEMI-TRACTOR 21 - HEAVY EQUIPMENT 26 - BICYCLE  
5 - CARGO VAN 11 - ALL TERRAIN VEHICLE (ATV / UTV) 16 - FARM EQUIPMENT 22 - ANIMAL WITH RIDER OR ANIMAL-DRAWN VEHICLE 27 - TRAIN  
6 - VAN (9-15 SEATS) 17 - MOTORHOME 99 - UNKNOWN OR HITSKIP

# OF TRAILING UNITS **00**

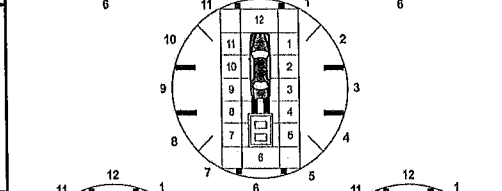

WAS VEHICLE OPERATING IN AUTONOMOUS MODE WHEN CRASH OCCURRED? **2**

1 - YES 2 - NO 9 - OTHER / UNKNOWN

AUTONOMOUS MODE LEVEL **0**

0 - NO AUTOMATION 3 - CONDITIONAL AUTOMATION 9 - UNKNOWN  
1 - DRIVER ASSISTANCE 4 - HIGH AUTOMATION  
2 - PARTIAL AUTOMATION 5 - FULL AUTOMATION

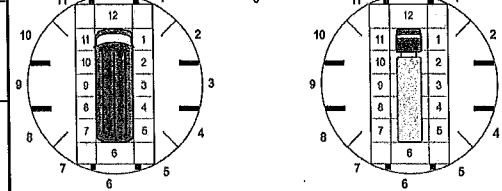

**SPECIAL FUNCTION** **0 1**

1 - NONE 6 - BUS - CHARTER/TOUR 11 - FIRE 16 - FARM 21 - MAIL CARRIER  
2 - TAXI 7 - BUS - INTERCITY 12 - MILITARY 17 - MOWING 99 - OTHER / UNKNOWN  
3 - ELECTRONIC RIDE SHARING 8 - BUS - SHUTTLE 13 - POLICE 18 - SNOW REMOVAL  
4 - SCHOOL TRANSPORT 9 - BUS - OTHER 14 - PUBLIC UTILITY 19 - TOWING  
5 - BUS - TRANSIT/COMMUTER 10 - AMBULANCE 15 - CONSTRUCTION EQUIPMENT 20 - SAFETY SERVICE PATROL

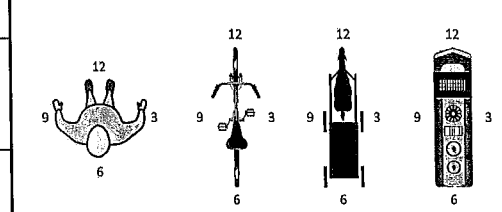

**CARGO BODY TYPE** **0 1**

1 - NO CARGO BODY TYPE / NOT APPLICABLE 3 - VEHICLE TOWING ANOTHER MOTOR VEHICLE 5 - INTERMODAL CONTAINER CHASSIS 8 - POLE 12 - CONCRETE MIXER  
2 - BUS 4 - LOGGING 6 - CARGO VAN/ENCLOSED BOX 9 - CARGO TANK 13 - AUTO TRANSPORTER  
7 - GRAIN/CHIPS/GRAVEL 11 - DUMP 14 - GARBAGE/REFUSE 99 - OTHER / UNKNOWN

- NO DAMAGE [ 0 ]  - UNDERCARRIAGE [ 14 ]  
 - TOP [ 13 ]  - ALL AREAS [ 15 ]  
 - UNIT NOT AT SCENE [ 16 ]

**VEHICLE DEFECTS**

1 - TURN SIGNALS 4 - BRAKES 7 - WORN OR SLICK TIRES 9 - MOTOR TROUBLE 99 - OTHER / UNKNOWN  
2 - HEAD LAMPS 5 - STEERING 8 - TRAILER EQUIPMENT DEFECTIVE 10 - DISABLED FROM PRIOR ACCIDENT  
3 - TAIL LAMPS 6 - TIRE BLOWOUT

**NON-MOTORIST LOCATION AT IMPACT**

1 - INTERSECTION - MARKED CROSSWALK 3 - INTERSECTION - OTHER 6 - BICYCLE LANE 9 - MEDIAN/CROSSING ISLAND 12 - FIRST RESPONDER AT INCIDENT SCENE  
2 - INTERSECTION - UNMARKED CROSSWALK 4 - MIDBLOCK - MARKED CROSSWALK 7 - SHOULDER / ROADSIDE 10 - DRIVEWAY ACCESS 99 - OTHER / UNKNOWN  
5 - TRAVEL LANE - OTHER LOCATION 8 - SIDEWALK 11 - SHARED USE PATHS OR TRAILS

**ACTION** **3** **PRE-CRASH ACTIONS** **0 1**

1 - NON-CONTACT 1 - STRAIGHT AHEAD 7 - MAKING U-TURN 13 - NEGOTIATING A CURVE OR LEAVING VEHICLE 18 - APPROACHING OR LEAVING VEHICLE  
2 - NON-COLLISION 2 - BACKING 8 - ENTERING TRAFFIC LANE 14 - ENTERING OR CROSSING SPECIFIED LOCATION 19 - STANDING  
3 - STRIKING 3 - CHANGING LANES 9 - LEAVING TRAFFIC LANE 15 - WALKING, RUNNING, JOGGING, PLAYING 20 - OTHER NON-MOTORIST  
4 - STRUCK 4 - OVERTAKING/PASSING 10 - PARKED 16 - WORKING 21 - STANDING OUTSIDE DISABLED VEHICLE  
5 - BOTH STRIKING & STRUCK 5 - MAKING RIGHT TURN 11 - SLOWING OR STOPPED IN TRAFFIC 17 - PUSHING VEHICLE 99 - OTHER / UNKNOWN  
6 - MAKING LEFT TURN 12 - DRIVERLESS 99 - OTHER / UNKNOWN  
9 - OTHER / UNKNOWN

**INITIAL POINT OF CONTACT**

0 - NO DAMAGE 14 - UNDERCARRIAGE  
1-12 - REFER TO UNIT DIAGRAM 15 - VEHICLE NOT AT SCENE  
13 - TOP 99 - UNKNOWN

**CONTRIBUTING CIRCUMSTANCES** **0 8**

1 - NONE 7 - LEFT OF CENTER 13 - IMPROPER START FROM A PARKED POSITION 17 - VISION OBSTRUCTION 21 - LYING IN ROADWAY  
2 - FAILURE TO YIELD 8 - FOLLOWING TOO CLOSE / ACDA 14 - OPERATING DEFECTIVE EQUIPMENT 18 - NOT DISCERNIBLE 22 - NOT DISCERNIBLE  
3 - RAN RED LIGHT 9 - IMPROPER LANE CHANGE 15 - LOAD SHIFTING/FALLING/SPILLING 19 - OPENING DOOR INTO ROADWAY 23 - OPENING DOOR INTO ROADWAY  
4 - RAN STOP SIGN 10 - IMPROPER PASSING 16 - WRONG WAY 20 - IMPROPER CROSSING 99 - OTHER IMPROPER ACTION  
5 - UNSAFE SPEED 11 - DROVE OFF ROAD 17 - VISION OBSTRUCTION 21 - LYING IN ROADWAY  
6 - IMPROPER TURN 12 - IMPROPER BACKING

**TRAFFIC**

**TRAFFICWAY FLOW** **2** **TRAFFIC CONTROL** **2**

1 - ONE-WAY 2 - TWO-WAY 1 - ROUNDABOUT 4 - STOP SIGN  
2 - SIGNAL 5 - YIELD SIGN  
3 - FLASHER 6 - NO CONTROL

**SEQUENCE OF EVENTS**

**1** **2** **0**

1 - OVERTURN/ROLLOVER 6 - EQUIPMENT FAILURE 11 - CROSS CENTERLINE - OPPOSITE DIRECTION OF TRAVEL 16 - RAILWAY VEHICLE 22 - WORK ZONE MAINTENANCE EQUIPMENT  
2 - FIRE/EXPLOSION 7 - SEPARATION OF UNITS 12 - DOWNHILL RUNAWAY 17 - ANIMAL - FARM 23 - STRUCK BY FALLING, SHIFTING CARGO OR ANYTHING SET IN MOTION BY A MOTOR VEHICLE  
3 - IMMERSION 8 - RAN OFF ROAD RIGHT 13 - OTHER NON-COLLISION 18 - ANIMAL - DEER 24 - OTHER MOVABLE OBJECT  
4 - JACKKNIFE 9 - RAN OFF ROAD LEFT 14 - PEDESTRIAN 19 - ANIMAL - OTHER 20 - MOTOR VEHICLE IN TRANSPORT  
5 - CARGO / EQUIPMENT LOSS OR SHIFT 10 - CROSS MEDIAN 15 - PEDALCYCLE 21 - PARKED MOTOR VEHICLE

**# OF THROUGH LANES ON ROAD** **4** **RAIL GRADE CROSSING** **1**

1 - NOT INVOLVED  
2 - INVOLVED-ACTIVE CROSSING  
3 - INVOLVED-PASSIVE CROSSING

**COLLISION WITH FIXED OBJECT - STRUCK**

25 - IMPACT ATTENUATOR / CRASH CUSHION 31 - GUARDRAIL END 37 - TRAFFIC SIGN POST 43 - CURB 50 - WORK ZONE MAINTENANCE EQUIPMENT  
26 - BRIDGE OVERHEAD STRUCTURE 32 - PORTABLE BARRIER 38 - OVERHEAD SIGN POST 44 - DITCH 51 - WALL  
27 - BRIDGE PIER OR ABUTMENT 33 - MEDIAN CABLE BARRIER 39 - LIGHT / LUMINARIES SUPPORT 45 - EMBANKMENT 52 - BUILDING  
28 - BRIDGE PARAPET 34 - MEDIAN GUARDRAIL BARRIER 40 - UTILITY POLE 46 - FENCE 53 - TUNNEL  
29 - BRIDGE RAIL 35 - MEDIAN CONCRETE BARRIER 41 - OTHER POST, POLE OR SUPPORT 47 - MAILBOX 54 - OTHER FIXED OBJECT  
30 - GUARDRAIL FACE 36 - MEDIAN OTHER BARRIER 42 - CULVERT 48 - TREE 55 - OTHER / UNKNOWN  
49 - FIRE HYDRANT

**UNIT / NON-MOTORIST DIRECTION**

FROM **1** TO **2**

1 - NORTH 5 - NORTHEAST  
2 - SOUTH 6 - NORTHWEST  
3 - EAST 7 - SOUTHEAST  
4 - WEST 8 - SOUTHWEST  
9 - OTHER / UNKNOWN

**FIRST HARMFUL EVENT** **1** **MOST HARMFUL EVENT** **1**

**UNIT SPEED** **0 0 1** **DETECTED SPEED** **1**

1 - STATED / ESTIMATED SPEED  
2 - CALCULATED / EDR  
3 - UNDETERMINED

**POSTED SPEED** **3 5**



# MOTORIST / Non-MOTORIST

LOCAL REPORT NUMBER  
 2 0 2 3 - 0 0 0 0 5 4 8 9

UNIT # <b>0 1</b>	NAME: LAST, FIRST, MIDDLE <b>CARTER, RACHEL, ANNE</b>		DATE OF BIRTH <b>0 8 2 0 1 9 8 0</b>		AGE <b>4 2</b>	GENDER <b>F</b>				
ADDRESS: STREET, CITY, STATE, ZIP <b>7523 DIAGONAL RD, Franklin Twp, OH 44240</b>					CONTACT PHONE - INCLUDE AREA CODE					
INJURIES <b>5</b>	INJURED TAKEN BY	EMS AGENCY (NAME)	INJURED TAKEN TO: MEDICAL FACILITY (NAME, CITY)	SAFETY EQUIPMENT USED <b>0 4</b>	<input type="checkbox"/> DOT-COMPLIANT MC HELMET	SEATING POSITION <b>0 1</b>	AIR BAG USAGE <b>1</b>	EJECTION <b>1</b>	TRAPPED <b>1</b>	
OL STATE <b>OH</b>	OPERATOR LICENSE NUMBER		OFFENSE CHARGED	LOCAL CODE <input type="checkbox"/>	OFFENSE DESCRIPTION		CITATION NUMBER			
OL CLASS <b>4</b>	ENDORSEMENT SELECT UP TO 2	RESTRICTION SELECT UP TO 3	DRIVER DISTRACTED BY <b>1</b>	ALCOHOL / DRUG SUSPECTED <input type="checkbox"/> ALCOHOL <input type="checkbox"/> MARIJUANA <input type="checkbox"/> OTHER DRUG		CONDITION <b>1</b>	ALCOHOL TEST STATUS <b>1</b> TYPE <b>1</b> VALUE		DRUG TEST(S) STATUS <b>1</b> TYPE <b>1</b> RESULT SELECT UP TO 4	

UNIT # <b>0 2</b>	NAME: LAST, FIRST, MIDDLE <b>CHENOT, JOSEPH, N</b>		DATE OF BIRTH <b>1 1 2 7 1 9 8 6</b>		AGE <b>3 6</b>	GENDER <b>M</b>				
ADDRESS: STREET, CITY, STATE, ZIP <b>13487 PEPPERTREE AVE NW, MOGADORE, OH 44260</b>					CONTACT PHONE - INCLUDE AREA CODE					
INJURIES <b>5</b>	INJURED TAKEN BY	EMS AGENCY (NAME)	INJURED TAKEN TO: MEDICAL FACILITY (NAME, CITY)	SAFETY EQUIPMENT USED <b>0 4</b>	<input type="checkbox"/> DOT-COMPLIANT MC HELMET	SEATING POSITION <b>0 1</b>	AIR BAG USAGE <b>1</b>	EJECTION <b>1</b>	TRAPPED <b>1</b>	
OL STATE <b>OH</b>	OPERATOR LICENSE NUMBER		OFFENSE CHARGED <b>333.03</b>	LOCAL CODE <input checked="" type="checkbox"/>	OFFENSE DESCRIPTION <b>Maximum Speed Limits</b>		CITATION NUMBER <b>25354</b>			
OL CLASS <b>4</b>	ENDORSEMENT SELECT UP TO 2	RESTRICTION SELECT UP TO 3	DRIVER DISTRACTED BY <b>1</b>	ALCOHOL / DRUG SUSPECTED <input type="checkbox"/> ALCOHOL <input type="checkbox"/> MARIJUANA <input type="checkbox"/> OTHER DRUG		CONDITION <b>1</b>	ALCOHOL TEST STATUS <b>1</b> TYPE <b>1</b> VALUE		DRUG TEST(S) STATUS <b>1</b> TYPE <b>1</b> RESULT SELECT UP TO 4	

UNIT #	NAME: LAST, FIRST, MIDDLE		DATE OF BIRTH		AGE	GENDER				
ADDRESS: STREET, CITY, STATE, ZIP					CONTACT PHONE - INCLUDE AREA CODE					
INJURIES	INJURED TAKEN BY	EMS AGENCY (NAME)	INJURED TAKEN TO: MEDICAL FACILITY (NAME, CITY)	SAFETY EQUIPMENT USED	<input type="checkbox"/> DOT-COMPLIANT MC HELMET	SEATING POSITION	AIR BAG USAGE	EJECTION	TRAPPED	
OL STATE	OPERATOR LICENSE NUMBER		OFFENSE CHARGED	LOCAL CODE <input type="checkbox"/>	OFFENSE DESCRIPTION		CITATION NUMBER			
OL CLASS	ENDORSEMENT SELECT UP TO 2	RESTRICTION SELECT UP TO 3	DRIVER DISTRACTED BY	ALCOHOL / DRUG SUSPECTED <input type="checkbox"/> ALCOHOL <input type="checkbox"/> MARIJUANA <input type="checkbox"/> OTHER DRUG		CONDITION	ALCOHOL TEST STATUS TYPE VALUE		DRUG TEST(S) STATUS TYPE RESULT SELECT UP TO 4	

INJURIES	SEATING POSITION	AIR BAG	OL CLASS	OL RESTRICTION(S)	DRIVER DISTRACTION	TEST STATUS
1 - FATAL 2 - SUSPECTED SERIOUS INJURY 3 - SUSPECTED MINOR INJURY 4 - POSSIBLE INJURY 5 - NO APPARENT INJURY	1 - FRONT - LEFT SIDE (MOTORCYCLE DRIVER) 2 - FRONT - MIDDLE 3 - FRONT - RIGHT SIDE 4 - SECOND - LEFT SIDE (MOTORCYCLE PASSENGER) 5 - SECOND - MIDDLE 6 - SECOND - RIGHT SIDE 7 - THIRD - LEFT SIDE (MOTORCYCLE SIDE CAR) 8 - THIRD - MIDDLE 9 - THIRD - RIGHT SIDE 10 - SLEEPER SECTION OF TRUCK CAB	1 - NOT DEPLOYED 2 - DEPLOYED FRONT 3 - DEPLOYED SIDE 4 - DEPLOYED BOTH FRONT / SIDE 5 - NOT APPLICABLE 9 - DEPLOYMENT UNKNOWN	1 - CLASS A 2 - CLASS B 3 - CLASS C 4 - REGULAR CLASS (OHIO = D) 5 - MC MOPED ONLY 6 - NO VALID OL	1 - ALCOHOL INTERLOCK DEVICE 2 - CDL INTRASTATE ONLY 3 - CORRECTIVE LENSES 4 - FARM WAIVER 5 - EXCEPT CLASS A BUS 6 - EXCEPT CLASS A & CLASS B BUS 7 - EXCEPT TRACTOR-TRAILER 8 - INTERMEDIATE LICENSE RESTRICTIONS 9 - LEARNER'S PERMIT RESTRICTIONS 10 - LIMITED TO DAYLIGHT ONLY 11 - LIMITED TO EMPLOYMENT 12 - LIMITED - OTHER 13 - MECHANICAL DEVICES (SPECIAL BRAKES, HAND CONTROLS, OR OTHER ADAPTIVE DEVICES) 14 - MILITARY VEHICLES ONLY 15 - MOTOR VEHICLES WITHOUT AIR BRAKES 16 - OUTSIDE MIRROR 17 - PROSTHETIC AID 18 - OTHER	1 - NOT DISTRACTED 2 - MANUALLY OPERATING AN ELECTRONIC COMMUNICATION DEVICE (TEXTING, TYPING, DIALING) 3 - TALKING ON HANDS-FREE COMMUNICATION DEVICE 4 - TALKING ON HAND-HELD COMMUNICATION DEVICE 5 - OTHER ACTIVITY WITH AN ELECTRONIC DEVICE 6 - PASSENGER 7 - OTHER DISTRACTION INSIDE THE VEHICLE 8 - OTHER DISTRACTION OUTSIDE THE VEHICLE 9 - OTHER / UNKNOWN	1 - NONE GIVEN 2 - TEST REFUSED 3 - TEST GIVEN, CONTAMINATED SAMPLE / UNUSABLE 4 - TEST GIVEN, RESULTS KNOWN 5 - TEST GIVEN, RESULTS UNKNOWN
INJURED TAKEN BY	SAFETY EQUIPMENT	EJECTION	OL ENDORSEMENT	CONDITION	DRUG TEST TYPE	ALCOHOL TEST TYPE
1 - NOT TRANSPORTED / TREATED AT SCENE 2 - EMS 3 - POLICE 9 - OTHER / UNKNOWN	1 - NONE USED 2 - SHOULDER BELT ONLY USED 3 - LAP BELT ONLY USED 4 - SHOULDER & LAP BELT USED 5 - CHILD RESTRAINT SYSTEM - FORWARD FACING 6 - CHILD RESTRAINT SYSTEM - REAR FACING 7 - BOOSTER SEAT 8 - HELMET USED 9 - PROTECTIVE PADS USED (ELBOW, KNEES, ETC.) 10 - REFLECTIVE CLOTHING 11 - LIGHTING - PEDESTRIAN / BICYCLE ONLY 99 - OTHER / UNKNOWN	1 - NOT EJECTED 2 - PARTIALLY EJECTED 3 - TOTALLY EJECTED 4 - NOT APPLICABLE	H - HAZMAT M - MOTORCYCLE P - PASSENGER N - TANKER Q - MOTOR SCOOTER R - THREE-WHEEL MOTORCYCLE S - SCHOOL BUS T - DOUBLE & TRIPLE TRAILERS X - TANKER / HAZMAT	1 - APPARENTLY NORMAL 2 - PHYSICAL IMPAIRMENT 3 - EMOTIONAL (E.G., DEPRESSED, ANGRY, DISTURBED) 4 - ILLNESS 5 - FELL ASLEEP, FAINTED, FATIGUED, ETC. 6 - UNDER THE INFLUENCE OF MEDICATIONS / DRUGS / ALCOHOL 9 - OTHER / UNKNOWN	1 - NONE 2 - BLOOD 3 - URINE 4 - BREATH 5 - OTHER	1 - NONE 2 - BLOOD 3 - URINE 4 - OTHER
SAFETY EQUIPMENT	TRAPPED	DRUG TEST RESULT(S)	GENDER			
1 - NONE USED 2 - SHOULDER BELT ONLY USED 3 - LAP BELT ONLY USED 4 - SHOULDER & LAP BELT USED 5 - CHILD RESTRAINT SYSTEM - FORWARD FACING 6 - CHILD RESTRAINT SYSTEM - REAR FACING 7 - BOOSTER SEAT 8 - HELMET USED 9 - PROTECTIVE PADS USED (ELBOW, KNEES, ETC.) 10 - REFLECTIVE CLOTHING 11 - LIGHTING - PEDESTRIAN / BICYCLE ONLY 99 - OTHER / UNKNOWN	1 - NOT TRAPPED 2 - EXTRICATED BY MECHANICAL MEANS 3 - FREED BY NON-MECHANICAL MEANS	1 - AMPHETAMINES 2 - BARBITURATES 3 - BENZODIAZEPINES 4 - CANNABINOIDS 5 - COCAINE 6 - OPIATES / OPIOIDS 7 - OTHER 8 - NEGATIVE RESULTS	F - FEMALE M - MALE U - OTHER / UNKNOWN			