

# TRAFFIC CRASH REPORT

\*DENOTES MANDATORY FIELD FOR SUPPLEMENT REPORT

LOCAL REPORT NUMBER\*

<input type="checkbox"/> PHOTOS TAKEN <input type="checkbox"/> SECONDARY CRASH <input type="checkbox"/> PRIVATE PROPERTY		<input type="checkbox"/> OH-2 <input checked="" type="checkbox"/> OH-1P <input type="checkbox"/> OTHER		LOCAL INFORMATION REPORTING AGENCY NAME* <b>City of Kent Police</b>		NCIC* <b>06703</b>		LOCAL REPORT NUMBER* <b>2023-00002577</b>		HITS/SKIP 1 - SOLVED 2 - UNSOLVED <b>03</b>		NUMBER OF UNITS <b>03</b>		UNIT IN ERROR 98 - ANIMAL 99 - UNKNOWN <b>01</b>	
--	--	--	--	---	--	-----------------------	--	--	--	--	--	------------------------------	--	---	--

COUNTY* <b>67</b>	LOCALITY* 1 - CITY 2 - VILLAGE 3 - TOWNSHIP <b>1</b>	LOCATION: CITY, VILLAGE, TOWNSHIP* <b>Kent</b>	CRASH DATE / TIME* <b>02172023/1022</b>	CRASH SEVERITY 1 - FATAL 2 - SERIOUS INJURY SUSPECTED 3 - MINOR INJURY SUSPECTED 4 - INJURY POSSIBLE 5 - PROPERTY DAMAGE ONLY <b>5</b>
----------------------	--	---	--	--

ROUTE TYPE <b>S R</b>	ROUTE NUMBER <b>43</b>	PREFIX <b>2</b>	N - NORTH S - SOUTH E - EAST W - WEST	LOCATION ROAD NAME <b>WATER</b>	ROAD TYPE <b>S T</b>	LATITUDE DECIMAL DEGREES <b>41.135238</b>
ROUTE TYPE	ROUTE NUMBER	PREFIX	N - NORTH S - SOUTH E - EAST W - WEST	REFERENCE ROAD NAME (ROAD, MILEPOST, HOUSE #) <b>1625</b>	ROAD TYPE	LONGITUDE DECIMAL DEGREES <b>-81.345405</b>

REFERENCE POINT 1 - INTERSECTION 2 - MILE POST 3 - HOUSE # <b>3</b>	DIRECTION FROM REFERENCE N - NORTH S - SOUTH E - EAST W - WEST	ROUTE TYPE IR - INTERSTATE ROUTE (TP) US - FEDERAL US ROUTE SR - STATE ROUTE CR - NUMBERED COUNTY ROUTE TR - NUMBERED TOWNSHIP ROUTE	ROAD TYPE AL - ALLEY AV - AVENUE BL - BOULEVARD CR - CIRCLE CT - COURT DR - DRIVE HE - HEIGHTS	HW - HIGHWAY LA - LANE MP - MILEPOST OV - OVAL PK - PARKWAY PI - PIKE PL - PLACE	RD - ROAD SQ - SQUARE ST - STREET TE - TERRACE TL - TRAIL WA - WAY	INTERSECTION RELATED <input type="checkbox"/> WITHIN INTERSECTION OR ON APPROACH <input type="checkbox"/> WITHIN INTERCHANGE AREA NUMBER OF APPROACHES <b>1</b>	ROADWAY <input type="checkbox"/> ROADWAY DIVIDED
---	--	---	---	--	---	---	---

LOCATION OF FIRST HARMFUL EVENT 1 - ON ROADWAY 2 - ON SHOULDER 3 - IN MEDIAN 4 - ON ROADSIDE 5 - ON GORE 6 - OUTSIDE TRAFFIC WAY 7 - ON RAMP 8 - OFF RAMP <b>01</b>	9 - CROSSOVER 10 - DRIVEWAY/ALLEY ACCESS 11 - RAILWAY GRADE CROSSING 12 - SHARED USE PATHS OR TRAILS 13 - BIKE LANE 14 - TOLL BOOTH 99 - OTHER / UNKNOWN	MANNER OF CRASH COLLISION/IMPACT 1 - NOT COLLISION BETWEEN TWO MOTOR VEHICLES IN TRANSPORT 2 - REAR-END 3 - HEAD-ON <b>6</b>	4 - REAR-TO-REAR 5 - BACKING 6 - ANGLE 7 - SIDESWIPE, SAME DIRECTION 8 - SIDESWIPE, OPPOSITE DIRECTION 9 - OTHER / UNKNOWN	DIRECTION OF TRAVEL N - NORTH S - SOUTH E - EAST W - WEST	MEDIAN TYPE 1 - DIVIDED FLUSH MEDIAN (<4 FEET) 2 - DIVIDED FLUSH MEDIAN (≥4 FEET) 3 - DIVIDED, DEPRESSED MEDIAN 4 - DIVIDED, RAISED MEDIAN (ANY TYPE) 9 - OTHER/UNKNOWN
--	--	--	---	---	--

<input type="checkbox"/> WORK ZONE RELATED <input type="checkbox"/> WORKERS PRESENT <input type="checkbox"/> LAW ENFORCEMENT PRESENT <input type="checkbox"/> ACTIVE SCHOOL ZONE	WORK ZONE TYPE 1 - LANE CLOSURE 2 - LANE SHIFT/CROSSOVER 3 - WORK ON SHOULDER OR MEDIAN 4 - INTERMITTENT OR MOVING WORK 5 - OTHER	LOCATION OF CRASH IN WORK ZONE 1 - BEFORE THE 1ST WORK ZONE WARNING SIGN 2 - ADVANCE WARNING AREA 3 - TRANSITION AREA 4 - ACTIVITY AREA 5 - TERMINATION AREA	CONTOUR <b>1</b> 1 - STRAIGHT LEVEL 2 - STRAIGHT GRADE 3 - CURVE LEVEL 4 - CURVE GRADE 9 - OTHER/UNKNOWN	CONDITIONS <b>2</b> 1 - DRY 2 - WET 3 - SNOW 4 - ICE 5 - SAND, MUD, DIRT, OIL, GRAVEL 6 - WATER (STANDING, MOVING) 7 - SLUSH 9 - OTHER/UNKNOWN	SURFACE <b>2</b> 1 - CONCRETE 2 - BLACKTOP, BITUMINOUS, ASPHALT 3 - BRICK/BLOCK 4 - SLAG, GRAVEL, STONE 5 - DIRT 9 - OTHER/UNKNOWN
---	--	---	--	---	---

LIGHT CONDITION <b>1</b> 1 - DAYLIGHT 2 - DAWN/DUSK 3 - DARK - LIGHTED ROADWAY 4 - DARK - ROADWAY NOT LIGHTED 5 - DARK - UNKNOWN ROADWAY LIGHTING 9 - OTHER / UNKNOWN	WEATHER <b>06</b> 1 - CLEAR 2 - CLOUDY 3 - FOG, SMOG, SMOKE 4 - RAIN 5 - SLEET, HAIL 6 - SNOW 7 - SEVERE CROSSWINDS 8 - BLOWING SAND, SOIL, DIRT, SNOW 9 - FREEZING RAIN OR FREEZING DRIZZLE 99 - OTHER / UNKNOWN
--	--

NARRATIVE

**UNIT 1 WAS TRAVELING SOUTHBOUND ON S WATER ST, PREPARING TO TURN LEFT INTO 1625 S WATER ST. UNIT 2 WAS TRAVELING NORTHBOUND ON S WATER ST IN FRONT OF 1625 S WATER ST. UNIT 1 FAILED TO YIELD AND TURNED LEFT IN FRONT OF UNIT 2, WHICH CAUSED UNIT 2 TO STRIKE UNIT 1 AND PUSH UNIT 1 INTO UNIT 3, WHICH WAS STOPPED PREPARING TO PULL OUT ONTO S WATER ST FROM 1625 S WATER ST.**

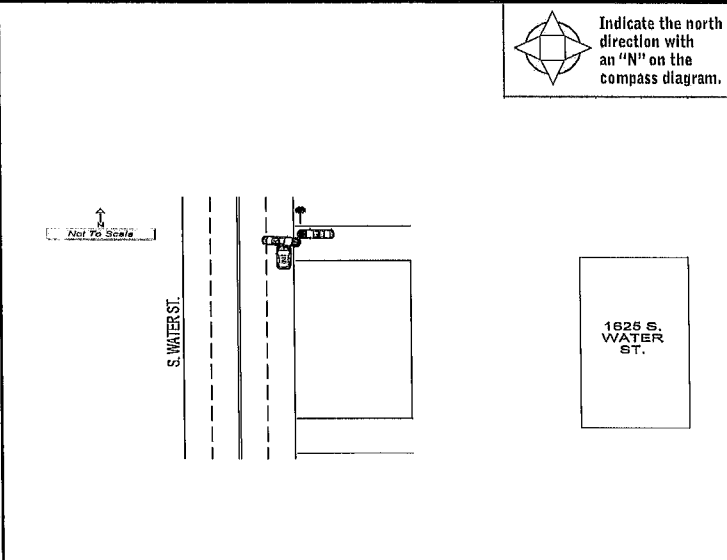

CRASH REPORTED DATE / TIME <b>02172023/1022</b>	DISPATCH DATE / TIME <b>02172023/1023</b>	ARRIVAL DATE / TIME <b>02172023/1030</b>	SCENE CLEARED DATE / TIME <b>02172023/1122</b>	REPORT TAKEN BY <input checked="" type="checkbox"/> POLICE AGENCY <input type="checkbox"/> MOTORIST <input type="checkbox"/> SUPPLEMENT (CORRECTION OR ADDITION TO AN EXISTING REPORT SENT TO ODPS)
TOTAL TIME ROADWAY CLOSED <b>000</b>	OTHER INVESTIGATION TIME <b>035</b>	TOTAL MINUTES <b>094</b>	OFFICER'S NAME* <b>Hadaway, Joseph</b> OFFICER'S BADGE NUMBER* <b>216</b>	CHECKED BY OFFICER'S NAME* <b>Wheeler, George</b> CHECKED BY OFFICER'S BADGE NUMBER* <b>243</b>

**OWNER**  
**UNIT #** 0 1 **OWNER NAME:** LAST, FIRST, MIDDLE (☐ SAME AS DRIVER)  
**MATIS, SHERRI**  
**OWNER ADDRESS:** STREET, CITY, STATE, ZIP (☒ SAME AS DRIVER)  
**52687 TOWNSHIP RD 178, FRESNO, OH 43824**  
**COMMERCIAL CARRIER:** NAME, ADDRESS, CITY, STATE, ZIP  
**COMMERCIAL CARRIER PHONE:** INCLUDE AREA CODE

**DAMAGE**  
**DAMAGE SCALE**  
**4** 1 - NONE 3 - FUNCTIONAL DAMAGE  
 2 - MINOR DAMAGE 4 - DISABLING DAMAGE  
 9 - UNKNOWN

**LP STATE** OH **LICENSE PLATE #** JFQ4237 **VEHICLE IDENTIFICATION #** 4 S 3 B M B H 6 X E 3 0 2 8 3 7 7 **VEHICLE YEAR** 2 0 1 4 **VEHICLE MAKE** Subaru  
 **INSURANCE VERIFIED** **INSURANCE COMPANY** STATE FARM **INSURANCE POLICY #** 2364337SFP35 **COLOR** BLU **VEHICLE MODEL** LEGACY  
 **COMMERCIAL**  **GOVERNMENT**  **IN EMERGENCY RESPONSE** **US DOT #**  
 **INTERLOCK DEVICE EQUIPPED**  **HIT/SKIP UNIT** **#OCCUPANTS** 0 1 **VEHICLE WEIGHT GVWR/GCWR**  
 1 - ≤10K LBS. 2 - 10,001 - 26K LBS. 3 - >26K LBS.  **HAZARDOUS MATERIAL**  
 **MATERIAL RELEASED** **CLASS #** **PLACARD ID #**  
 **PLACARD**

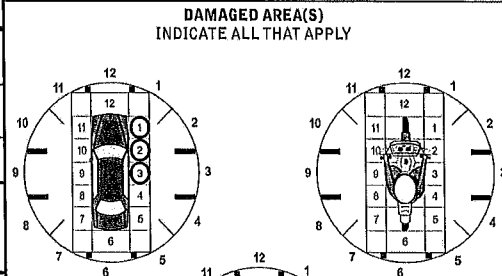

**UNIT TYPE** 0 1  
 1 - PASSENGER CAR 7 - MOTORCYCLE 2-WHEELED 12 - GOLF CART 18 - LIMO (LIVERY VEHICLE) 23 - PEDESTRIAN / SKATER  
 2 - PASSENGER VAN (MINIVAN) 8 - MOTORCYCLE 3-WHEELED 13 - SNOWMOBILE 19 - BUS (16+ PASSENGERS) 24 - WHEELCHAIR (ANY TYPE)  
 3 - SPORT UTILITY VEHICLE 9 - AUTOCYCLE 14 - SINGLE UNIT TRUCK 20 - OTHER VEHICLE 25 - OTHER NON-MOTORIST  
 4 - PICK UP 10 - MOPED OR MOTORIZED BICYCLE 15 - SEMI-TRACTOR 21 - HEAVY EQUIPMENT 26 - BICYCLE  
 5 - CARGOVAN 11 - ALL TERRAIN VEHICLE (ATV / UTV) 16 - FARM EQUIPMENT 22 - ANIMAL WITH RIDER OR ANIMAL-DRAWN VEHICLE 27 - TRAIN  
 6 - VAN (9-15 SEATS) 17 - MOTORHOME 99 - UNKNOWN OR HIT/SKIP  
**# OF TRAILING UNITS**

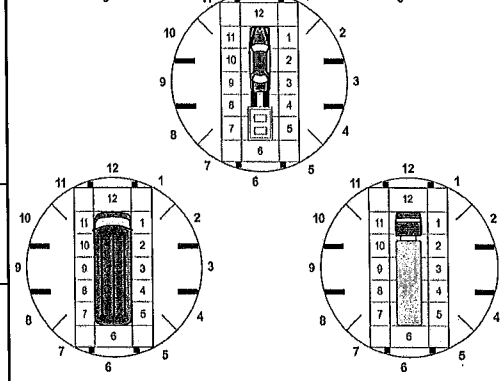

**WAS VEHICLE OPERATING IN AUTONOMOUS MODE WHEN CRASH OCCURRED?** 2  
 1 - YES 2 - NO 9 - OTHER / UNKNOWN **AUTONOMOUS MODE LEVEL** 0  
 0 - NO AUTOMATION 1 - DRIVER ASSISTANCE 2 - PARTIAL AUTOMATION 3 - CONDITIONAL AUTOMATION 4 - HIGH AUTOMATION 5 - FULL AUTOMATION 9 - UNKNOWN

**SPECIAL FUNCTION** 0 1  
 1 - NONE 6 - BUS - CHARTER/TOUR 11 - FIRE 16 - FARM 21 - MAIL CARRIER  
 2 - TAXI 7 - BUS - INTERCITY 12 - MILITARY 17 - MOWING 99 - OTHER / UNKNOWN  
 3 - ELECTRONIC RIDE SHARING 8 - BUS - SHUTTLE 13 - POLICE 18 - SNOW REMOVAL  
 4 - SCHOOL TRANSPORT 9 - BUS - OTHER 14 - PUBLIC UTILITY 19 - TOWING  
 5 - BUS - TRANSIT/COMMUTER 10 - AMBULANCE 15 - CONSTRUCTION EQUIPMENT 20 - SAFETY SERVICE PATROL

**CARGO BODY TYPE** 0 1  
 1 - NO CARGO BODY TYPE / NOT APPLICABLE 3 - VEHICLE TOWING ANOTHER MOTOR VEHICLE 5 - INTERMODAL CONTAINER CHASSIS 8 - POLE 12 - CONCRETE MIXER  
 2 - BUS 4 - LOGGING 6 - CARGO VAN/ENCLOSED BOX 9 - CARGO TANK 13 - AUTO TRANSPORTER  
 7 - GRAIN/CHIPS/GRAVEL 10 - FLAT BED 14 - GARBAGE/REFUSE 99 - OTHER / UNKNOWN

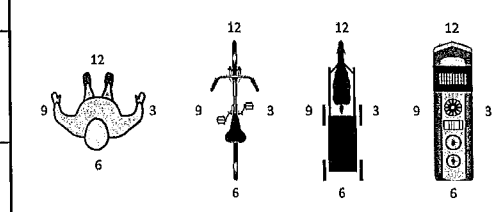

**VEHICLE DEFECTS**  
 1 - TURN SIGNALS 4 - BRAKES 7 - WORN OR SLICK TIRES 9 - MOTOR TROUBLE 99 - OTHER / UNKNOWN  
 2 - HEAD LAMPS 5 - STEERING 8 - TRAILER EQUIPMENT DEFECTIVE 10 - DISABLED FROM PRIOR ACCIDENT

**- NO DAMAGE [ 0 ]**  **- UNDERCARRIAGE [ 14 ]**  
 **- TOP [ 13 ]**  **- ALL AREAS [ 15 ]**  
 **- UNIT NOT AT SCENE [ 16 ]**

**NON-MOTORIST LOCATION AT IMPACT**  
 1 - INTERSECTION - MARKED CROSSWALK 3 - INTERSECTION - OTHER 6 - BICYCLE LANE 9 - MEDIAN/CROSSING ISLAND 12 - FIRST RESPONDER AT INCIDENT SCENE  
 2 - INTERSECTION - UNMARKED CROSSWALK 4 - MIDBLOCK - MARKED CROSSWALK 7 - SHOULDER / ROADSIDE 10 - DRIVEWAY ACCESS 15 - SHARED USE PATHS OR TRAILS  
 5 - TRAVEL LANE - OTHER LOCATION 8 - SIDEWALK 11 - OTHER / UNKNOWN 99 - OTHER / UNKNOWN

**ACTION** 4 **PRE-CRASH ACTIONS** 0 6  
 1 - NON-CONTACT 1 - STRAIGHT AHEAD 7 - MAKING U-TURN 13 - NEGOTIATING A CURVE 18 - APPROACHING OR LEAVING VEHICLE  
 2 - NON-COLLISION 2 - BACKING 8 - ENTERING TRAFFIC LANE 14 - ENTERING OR CROSSING SPECIFIED LOCATION 19 - STANDING  
 3 - STRIKING 3 - CHANGING LANES 9 - LEAVING TRAFFIC LANE 15 - WALKING, RUNNING, JOGGING, PLAYING 20 - OTHER NON-MOTORIST  
 4 - STRUCK 4 - OVERTAKING/PASSING 10 - PARKED 16 - WORKING 21 - STANDING OUTSIDE DISABLED VEHICLE  
 5 - BOTH STRIKING & STRUCK 5 - MAKING RIGHT TURN 11 - SLOWING OR STOPPED IN TRAFFIC 17 - PUSHING VEHICLE 99 - OTHER / UNKNOWN  
 9 - OTHER / UNKNOWN 6 - MAKING LEFT TURN 12 - DRIVERLESS

**INITIAL POINT OF CONTACT**  
 0 - NO DAMAGE 14 - UNDERCARRIAGE  
 1-12 - REFER TO UNIT DIAGRAM 15 - VEHICLE NOT AT SCENE  
 13 - TOP 99 - UNKNOWN

**CONTRIBUTING CIRCUMSTANCES** 0 2  
 1 - NONE 7 - LEFT OF CENTER 13 - IMPROPER START FROM A PARKED POSITION 17 - VISION OBSTRUCTION 21 - LYING IN ROADWAY  
 2 - FAILURE TO YIELD 8 - FOLLOWING TOO CLOSE / ACDA 14 - STOPPED OR PARKED ILLEGALLY 18 - OPERATING DEFECTIVE EQUIPMENT 22 - NOT DISCERNIBLE  
 3 - RAN RED LIGHT 9 - IMPROPER LANE CHANGE 15 - SWERVING TO AVOID 19 - LOAD SHIFTING/FALLING/SPILLING 23 - OPENING DOOR INTO ROADWAY  
 4 - RAN STOP SIGN 10 - IMPROPER PASSING 16 - WRONG WAY 20 - IMPROPER CROSSING 99 - OTHER IMPROPER ACTION  
 5 - UNSAFE SPEED 11 - DROVE OFF ROAD 12 - IMPROPER BACKING

**TRAFFIC**  
**TRAFFICWAY FLOW** 2  
 1 - ONE-WAY 2 - TWO-WAY  
**TRAFFIC CONTROL** 6  
 1 - ROUNDABOUT 4 - STOP SIGN  
 2 - SIGNAL 5 - YIELD SIGN  
 3 - FLASHER 6 - NO CONTROL

**SEQUENCE OF EVENTS**  
 1 2 0 1 - OVERTURN/ROLLOVER 6 - EQUIPMENT FAILURE 11 - CROSS CENTERLINE - OPPOSITE DIRECTION OF TRAVEL 16 - RAILWAY VEHICLE 22 - WORK ZONE MAINTENANCE EQUIPMENT  
 2 - FIRE/EXPLOSION 7 - SEPARATION OF UNITS 12 - DOWNHILL RUNAWAY 17 - ANIMAL - FARM 23 - STRUCK BY FALLING, SHIFTING CARGO OR ANYTHING SET IN MOTION BY A MOTOR VEHICLE  
 3 - IMMERSION 8 - RAN OFF ROAD RIGHT 13 - OTHER NON-COLLISION 18 - ANIMAL - DEER 24 - OTHER MOVABLE OBJECT  
 4 - JACKKNIFE 9 - RAN OFF ROAD LEFT 14 - PEDESTRIAN 19 - ANIMAL - OTHER 20 - MOTOR VEHICLE IN TRANSPORT  
 5 - CARGO / EQUIPMENT LOSS OR SHIFT 10 - CROSS MEDIAN 15 - PEDALCYCLE 21 - PARKED MOTOR VEHICLE

**# OF THROUGH LANES ON ROAD** 4  
**RAIL GRADE CROSSING** 1  
 1 - NOT INVOLVED  
 2 - INVOLVED-ACTIVE CROSSING  
 3 - INVOLVED-PASSIVE CROSSING

**COLLISION WITH FIXED OBJECT - STRUCK**  
 25 - IMPACT ATTENUATOR / CRASH CUSHION 31 - GUARDRAIL END 37 - TRAFFIC SIGN POST 43 - CURB 50 - WORK ZONE MAINTENANCE EQUIPMENT  
 26 - BRIDGE OVERHEAD STRUCTURE 32 - PORTABLE BARRIER 38 - OVERHEAD SIGN POST 44 - DITCH 51 - WALL  
 27 - BRIDGE PIER OR ABUTMENT 33 - MEDIAN CABLE BARRIER 39 - LIGHT / LUMINARIES SUPPORT 45 - EMBANKMENT 52 - BUILDING  
 28 - BRIDGE PARAPET 34 - MEDIAN GUARDRAIL BARRIER 40 - UTILITY POLE 46 - FENCE 53 - TUNNEL  
 29 - BRIDGE RAIL 35 - MEDIAN CONCRETE BARRIER 41 - OTHER POST, POLE OR SUPPORT 47 - MAILBOX 54 - OTHER FIXED OBJECT  
 30 - GUARDRAIL FACE 36 - MEDIAN OTHER BARRIER 42 - CULVERT 48 - TREE 55 - OTHER / UNKNOWN  
 49 - FIRE HYDRANT

**UNIT / NON-MOTORIST DIRECTION**  
 FROM 1 TO 3  
 1 - NORTH 5 - NORTHEAST  
 2 - SOUTH 6 - NORTHWEST  
 3 - EAST 7 - SOUTHEAST  
 4 - WEST 8 - SOUTHWEST  
 9 - OTHER / UNKNOWN

**UNIT SPEED** 0 0 5  
**POSTED SPEED** 2 5  
**DETECTED SPEED** 1  
 1 - STATED / ESTIMATED SPEED  
 2 - CALCULATED / EDR  
 3 - UNDETERMINED

LOCAL REPORT NUMBER  
**2 0 2 3 - 0 0 0 0 2 5 7 7**

**OWNER**  
 UNIT # **0 2** OWNER NAME: LAST, FIRST, MIDDLE (X SAME AS DRIVER)  
**JAMES, JULIE, VIOLET**  
 OWNED BY NAME: INCLUDE AREA CODE (X SAME AS DRIVER)  
 OWNER ADDRESS: STREET, CITY, STATE, ZIP (X SAME AS DRIVER)  
**4312 NINA ST, Rootstown, OH 44272**  
 COMMERCIAL CARRIER: NAME, ADDRESS, CITY, STATE, ZIP  
 COMMERCIAL CARRIER PHONE: INCLUDE AREA CODE

**DAMAGE**  
**DAMAGE SCALE**  
**4** 1 - NONE 3 - FUNCTIONAL DAMAGE  
 2 - MINOR DAMAGE 4 - DISABLING DAMAGE  
 9 - UNKNOWN

**VEHICLE**  
 LP STATE **OH** LICENSE PLATE # **626YZG** VEHICLE IDENTIFICATION # **1N4AL3APXHC123121** VEHICLE YEAR **2017** VEHICLE MAKE **Nissan**  
 INSURANCE VERIFIED INSURANCE COMPANY **ALLSTATE** INSURANCE POLICY # **826607976** COLOR **GRY** VEHICLE MODEL **ALTIMA**  
 COMMERCIAL  GOVERNMENT  IN EMERGENCY RESPONSE US DOT #  
 INTERLOCK DEVICE EQUIPPED  HIT/SKIP UNIT #OCCUPANTS **0 1** VEHICLE WEIGHT GVWR/GCWR  
 1 - ≤10K LBS.  
 2 - 10,001 - 26K LBS.  
 3 - >26K LBS.  
 MATERIAL RELEASED HAZARDOUS MATERIAL CLASS # PLACARD ID #  
 PLACARD

**DAMAGED AREA(S)**  
 INDICATE ALL THAT APPLY

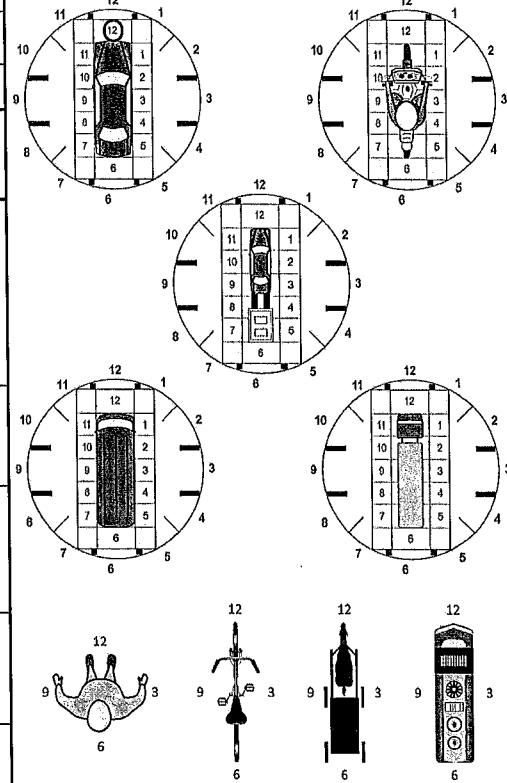

**UNIT TYPE**  
**0 1** 1 - PASSENGER CAR 7 - MOTORCYCLE 2-WHEELED 12 - GOLF CART 18 - LIMO (LIVERY VEHICLE) 23 - PEDESTRIAN / SKATER  
 2 - PASSENGER VAN (MINIVAN) 8 - MOTORCYCLE 3-WHEELED 13 - SNOWMOBILE 19 - BUS (16+ PASSENGERS) 24 - WHEELCHAIR (ANY TYPE)  
 3 - SPORT UTILITY VEHICLE 9 - AUTOCYCLE 14 - SINGLE UNIT TRUCK 20 - OTHER VEHICLE 25 - OTHER NON-MOTORIST  
 4 - PICK UP 10 - MOPED OR MOTORIZED BICYCLE 15 - SEMI-TRACTOR 21 - HEAVY EQUIPMENT 26 - BICYCLE  
 5 - CARGO VAN 11 - ALL TERRAIN VEHICLE (ATV / UTV) 16 - FARM EQUIPMENT 22 - ANIMAL WITH RIDER OR ANIMAL-DRAWN VEHICLE 27 - TRAIN  
 6 - VAN (9-15 SEATS) 17 - MOTORHOME 99 - UNKNOWN OR HIT/SKIP

**AUTONOMOUS MODE WHEN CRASH OCCURRED?**  
**2** 1 - YES 2 - NO 9 - OTHER / UNKNOWN  
**AUTONOMOUS MODE LEVEL**  
**0** 0 - NO AUTOMATION 3 - CONDITIONAL AUTOMATION 9 - UNKNOWN  
 1 - DRIVER ASSISTANCE 4 - HIGH AUTOMATION  
 2 - PARTIAL AUTOMATION 5 - FULL AUTOMATION

**SPECIAL FUNCTION**  
**0 1** 1 - NONE 6 - BUS - CHARTER/TOUR 11 - FIRE 16 - FARM 21 - MAIL CARRIER  
 2 - TAXI 7 - BUS - INTERCITY 12 - MILITARY 17 - MOWING 99 - OTHER / UNKNOWN  
 3 - ELECTRONIC RIDE SHARING 8 - BUS - SHUTTLE 13 - POLICE 18 - SNOW REMOVAL  
 4 - SCHOOL TRANSPORT 9 - BUS - OTHER 14 - PUBLIC UTILITY 19 - TOWING  
 5 - BUS - TRANSIT/COMMUTER 10 - AMBULANCE 15 - CONSTRUCTION EQUIPMENT 20 - SAFETY SERVICE PATROL

**CARGO BODY TYPE**  
**0 1** 1 - NO CARGO BODY TYPE / NOT APPLICABLE 3 - VEHICLE TOWING ANOTHER MOTOR VEHICLE 5 - INTERMODAL CONTAINER CHASSIS 8 - POLE 12 - CONCRETE MIXER  
 2 - BUS 4 - LOGGING 6 - CARGO VAN/ENCLOSED BOX 9 - CARGO TANK 13 - AUTO TRANSPORTER  
 7 - GRAIN/CHIPS/GRAVEL 10 - FLAT BED 14 - GARBAGE/REFUSE  
 99 - OTHER / UNKNOWN  
 11 - DUMP

**VEHICLE DEFECTS**  
**0 1** 1 - TURN SIGNALS 4 - BRAKES 7 - WORN OR SLICK TIRES 9 - MOTOR TROUBLE 99 - OTHER / UNKNOWN  
 2 - HEAD LAMPS 5 - STEERING 8 - TRAILER EQUIPMENT DEFECTIVE 10 - DISABLED FROM PRIOR ACCIDENT  
 3 - TAIL LAMPS 6 - TIRE BLOWOUT

NO DAMAGE [ 0 ]  UNDERCARRIAGE [ 14 ]  
 TOP [ 13 ]  ALL AREAS [ 15 ]  
 UNIT NOT AT SCENE [ 16 ]

**NON-MOTORIST LOCATION AT IMPACT**  
**0 1** 1 - INTERSECTION - MARKED CROSSWALK 3 - INTERSECTION - OTHER 6 - BICYCLE LANE 9 - MEDIAN/CROSSING ISLAND 12 - FIRST RESPONDER AT INCIDENT SCENE  
 2 - INTERSECTION - UNMARKED CROSSWALK 4 - MIDBLOCK - MARKED CROSSWALK 7 - SHOULDER / ROADSIDE 10 - DRIVEWAY ACCESS 99 - OTHER / UNKNOWN  
 5 - TRAVEL LANE - OTHER LOCATION 8 - SIDEWALK 11 - SHARED USE PATHS OR TRAILS

**ACTION**  
**3** 1 - NON-CONTACT 0 1 1 - STRAIGHT AHEAD 7 - MAKING U-TURN 13 - NEGOTIATING A CURVE OR LEAVING VEHICLE  
 2 - NON-COLLISION 2 - BACKING 8 - ENTERING TRAFFIC LANE 14 - ENTERING OR CROSSING SPECIFIED LOCATION  
 3 - STRIKING 3 - CHANGING LANES 9 - LEAVING TRAFFIC LANE 15 - WALKING, RUNNING, JOGGING, PLAYING  
 4 - STRUCK PRE-CRASH ACTIONS 4 - OVERTAKING/PASSING 10 - PARKED 16 - WORKING  
 5 - BOTH STRIKING & STRUCK 5 - MAKING RIGHT TURN 11 - SLOWING OR STOPPED IN TRAFFIC 17 - PUSHING VEHICLE  
 9 - OTHER / UNKNOWN 6 - MAKING LEFT TURN 12 - DRIVERLESS 99 - OTHER / UNKNOWN

**INITIAL POINT OF CONTACT**  
**1 2** 0 - NO DAMAGE 14 - UNDERCARRIAGE  
 1-12 - REFER TO UNIT DIAGRAM 15 - VEHICLE NOT AT SCENE  
 13 - TOP 99 - UNKNOWN

**CONTRIBUTING CIRCUMSTANCES**  
**0 1** 1 - NONE 7 - LEFT OF CENTER 13 - IMPROPER START FROM A PARKED POSITION 17 - VISION OBSTRUCTION 21 - LYING IN ROADWAY  
 2 - FAILURE TO YIELD 8 - FOLLOWING TOO CLOSE / ACDA 14 - STOPPED OR PARKED ILLEGALLY 18 - OPERATING DEFECTIVE EQUIPMENT 22 - NOT DISCERNIBLE  
 3 - RAN RED LIGHT 9 - IMPROPER LANE CHANGE 15 - SWERVING TO AVOID 19 - LOAD SHIFTING/FALLING/SPILLING 23 - OPENING DOOR INTO ROADWAY  
 4 - RAN STOP SIGN 10 - IMPROPER PASSING 16 - WRONG WAY 20 - IMPROPER CROSSING 99 - OTHER IMPROPER ACTION  
 5 - UNSAFE SPEED 11 - DROVE OFF ROAD 17 - VISION OBSTRUCTION 21 - LYING IN ROADWAY  
 6 - IMPROPER TURN 12 - IMPROPER BACKING

**TRAFFIC**  
**TRAFFICWAY FLOW**  
**2** 1 - ONE-WAY  
 2 - TWO-WAY  
**TRAFFIC CONTROL**  
**6** 1 - ROUNDABOUT 4 - STOP SIGN  
 2 - SIGNAL 5 - YIELD SIGN  
 3 - FLASHER 6 - NO CONTROL

**SEQUENCE OF EVENTS**  
**1 2 0** 1 - OVERTURN/ROLLOVER 6 - EQUIPMENT FAILURE 11 - NON-COLLISION 16 - RAILWAY VEHICLE 22 - WORK ZONE MAINTENANCE EQUIPMENT  
 2 - FIRE/EXPLOSION 7 - SEPARATION OF UNITS 12 - DOWNHILL RUNAWAY 17 - ANIMAL - FARM 23 - STRUCK BY FALLING, SHIFTING CARGO OR ANYTHING SET IN MOTION BY A MOTOR VEHICLE  
 3 - IMMERSION 8 - RAN OFF ROAD RIGHT 13 - OTHER NON-COLLISION 18 - ANIMAL - DEER 24 - OTHER MOVABLE OBJECT  
 4 - JACKKNIFE 9 - RAN OFF ROAD LEFT 14 - PEDESTRIAN 19 - ANIMAL - OTHER 20 - MOTOR VEHICLE IN TRANSPORT  
 5 - CARGO / EQUIPMENT LOSS OR SHIFT 10 - CROSS MEDIAN 15 - PEDALCYCLE 21 - PARKED MOTOR VEHICLE

**# OF THROUGH LANES ON ROAD**  
**4**  
**RAIL GRADE CROSSING**  
**1** 1 - NOT INVOLVED  
 2 - INVOLVED-ACTIVE CROSSING  
 3 - INVOLVED-PASSIVE CROSSING

**FIRST HARMFUL EVENT** **1** **MOST HARMFUL EVENT**  
**1** 25 - IMPACT ATTENUATOR / CRASH CUSHION 31 - GUARDRAIL END 37 - TRAFFIC SIGN POST 43 - CURB 50 - WORK ZONE MAINTENANCE EQUIPMENT  
 26 - BRIDGE OVERHEAD STRUCTURE 32 - PORTABLE BARRIER 38 - OVERHEAD SIGN POST 44 - DITCH 51 - WALL  
 27 - BRIDGE PIER OR ABUTMENT 33 - MEDIAN CABLE BARRIER 39 - LIGHT / LUMINARIES SUPPORT 45 - EMBANKMENT 52 - BUILDING  
 28 - BRIDGE PARAPET 34 - MEDIAN GUARDRAIL BARRIER 40 - UTILITY POLE 46 - FENCE 53 - TUNNEL  
 29 - BRIDGE RAIL 35 - MEDIAN CONCRETE BARRIER 41 - OTHER POST, POLE OR SUPPORT 47 - MAILBOX 54 - OTHER FIXED OBJECT  
 30 - GUARDRAIL FACE 36 - MEDIAN OTHER BARRIER 42 - CULVERT 48 - TREE 55 - OTHER / UNKNOWN  
 49 - FIRE HYDRANT 99 - OTHER / UNKNOWN

**UNIT / NON-MOTORIST DIRECTION**  
**FROM 2 TO 1**  
 1 - NORTH 5 - NORTHEAST  
 2 - SOUTH 6 - NORTHWEST  
 3 - EAST 7 - SOUTHEAST  
 4 - WEST 8 - SOUTHWEST  
 9 - OTHER / UNKNOWN

**UNIT SPEED**  
**0 2 5**  
**POSTED SPEED**  
**2 5**  
**DETECTED SPEED**  
**1** 1 - STATED / ESTIMATED SPEED  
 2 - CALCULATED / EDR  
 3 - UNDETERMINED

**OWNER**

UNIT # **0 3** OWNER NAME: LAST, FIRST, MIDDLE (☒ SAME AS DRIVER)  
**TRUSSO, ADRIA, LYNN**

OWNER ADDRESS: STREET, CITY, STATE, ZIP (☒ SAME AS DRIVER)  
**465 ALLEN DR, Kent, OH 44240**

COMMERCIAL CARRIER: NAME, ADDRESS, CITY, STATE, ZIP

OWNER PHONE: INCLUDE AREA CODE

COMMERCIAL CARRIER PHONE: INCLUDE AREA CODE

**DAMAGE**

**DAMAGE SCALE**

**2** 1 - NONE 3 - FUNCTIONAL DAMAGE  
2 - MINOR DAMAGE 4 - DISABLING DAMAGE  
9 - UNKNOWN

**VEHICLE**

LP STATE **OH** LICENSE PLATE # **JNU7181** VEHICLE IDENTIFICATION # **1VWA T7 A 3 2 E C 0 6 5 5 2 8** VEHICLE YEAR **2 0 1 4** VEHICLE MAKE **Volkswagen**

INSURANCE VERIFIED INSURANCE COMPANY **STATE FARM** INSURANCE POLICY # **2141947SFP35** COLOR **SIL** VEHICLE MODEL **PASSAT**

COMMERCIAL  GOVERNMENT  IN EMERGENCY RESPONSE

INTERLOCK DEVICE EQUIPPED  HIT/SKIP UNIT #OCCUPANTS **0 1** VEHICLE WEIGHT GVWR/GCWR  
1 - ≤10K LBS.  
2 - 10,001 - 26K LBS.  
3 - >26K LBS.

HAZARDOUS MATERIAL CLASS # PLACARD ID #

**DAMAGED AREA(S)**  
INDICATE ALL THAT APPLY

**UNIT TYPE** **0 1**

1 - PASSENGER CAR	7 - MOTORCYCLE 2-WHEELED	12 - GOLF CART	18 - LIMO (LIVERY VEHICLE)	23 - PEDESTRIAN / SKATER
2 - PASSENGER VAN (MINIVAN)	8 - MOTORCYCLE 3-WHEELED	13 - SNOWMOBILE	19 - BUS (16+ PASSENGERS)	24 - WHEELCHAIR (ANYTYPE)
3 - SPORT UTILITY VEHICLE	9 - AUTOCYCLE	14 - SINGLE UNIT TRUCK	20 - OTHER VEHICLE	25 - OTHER NON-MOTORIST
4 - PICK UP	10 - MOPED OR MOTORIZED BICYCLE	15 - SEMI-TRACTOR	21 - HEAVY EQUIPMENT	26 - BICYCLE
5 - CARGO VAN	11 - ALL TERRAIN VEHICLE (ATV / UTV)	16 - FARM EQUIPMENT	22 - ANIMAL WITH RIDER OR ANIMAL-DRAWN VEHICLE	27 - TRAIN
6 - VAN (9-15 SEATS)		17 - MOTORHOME		99 - UNKNOWN OR HIT/SKIP

# OF TRAILING UNITS

**DAMAGED AREA(S)**  
INDICATE ALL THAT APPLY

WAS VEHICLE OPERATING IN AUTONOMOUS MODE WHEN CRASH OCCURRED? **2**

1 - YES 2 - NO 9 - OTHER / UNKNOWN

AUTONOMOUS MODE LEVEL **0**

0 - NO AUTOMATION 3 - CONDITIONAL AUTOMATION 9 - UNKNOWN  
1 - DRIVER ASSISTANCE 4 - HIGH AUTOMATION  
2 - PARTIAL AUTOMATION 5 - FULL AUTOMATION

**DAMAGED AREA(S)**  
INDICATE ALL THAT APPLY

**SPECIAL FUNCTION** **0 1**

1 - NONE	6 - BUS - CHARTER/TOUR	11 - FIRE	16 - FARM	21 - MAIL CARRIER
2 - TAXI	7 - BUS - INTERCITY	12 - MILITARY	17 - MOWING	99 - OTHER / UNKNOWN
3 - ELECTRONIC RIDE SHARING	8 - BUS - SHUTTLE	13 - POLICE	18 - SNOW REMOVAL	
4 - SCHOOL TRANSPORT	9 - BUS - OTHER	14 - PUBLIC UTILITY	19 - TOWING	
5 - BUS - TRANSIT/COMMUTER	10 - AMBULANCE	15 - CONSTRUCTION EQUIPMENT	20 - SAFETY SERVICE PATROL	

**DAMAGED AREA(S)**  
INDICATE ALL THAT APPLY

**CARGO BODY TYPE** **0 1**

1 - NO CARGO BODY TYPE / NOT APPLICABLE	3 - VEHICLE TOWING ANOTHER MOTOR VEHICLE	5 - INTERMODAL CONTAINER CHASSIS	8 - POLE	12 - CONCRETE MIXER
2 - BUS	4 - LOGGING	6 - CARGO VAN/ENCLOSED BOX	9 - CARGO TANK	13 - AUTO TRANSPORTER
		7 - GRAIN/CHIPS/GRAVEL	10 - FLAT BED	14 - GARBAGE/REFUSE
			11 - DUMP	99 - OTHER / UNKNOWN

**DAMAGED AREA(S)**  
INDICATE ALL THAT APPLY

**VEHICLE DEFECTS**

1 - TURN SIGNALS	4 - BRAKES	7 - WORN OR SLICK TIRES	9 - MOTOR TROUBLE	99 - OTHER / UNKNOWN
2 - HEAD LAMPS	5 - STEERING	8 - TRAILER EQUIPMENT DEFECTIVE	10 - DISABLED FROM PRIOR ACCIDENT	
3 - TAIL LAMPS	6 - TIRE BLOWOUT			

**DAMAGED AREA(S)**  
INDICATE ALL THAT APPLY

- NO DAMAGE [ 0 ]  - UNDERCARRIAGE [ 14 ]  
 - TOP [ 13 ]  - ALL AREAS [ 15 ]  
 - UNIT NOT AT SCENE [ 16 ]

**NON-MOTORIST LOCATION AT IMPACT**

1 - INTERSECTION - MARKED CROSSWALK	3 - INTERSECTION - OTHER	6 - BICYCLE LANE	9 - MEDIAN/CROSSING ISLAND	12 - FIRST RESPONDER AT INCIDENT SCENE
2 - INTERSECTION - UNMARKED CROSSWALK	4 - MIDBLOCK - MARKED CROSSWALK	7 - SHOULDER / ROADSIDE	10 - DRIVEWAY ACCESS	99 - OTHER / UNKNOWN
	5 - TRAVEL LANE - OTHER LOCATION	8 - SIDEWALK	11 - SHARED USE PATHS OR TRAILS	

**INITIAL POINT OF CONTACT**

**1 1**

0 - NO DAMAGE 14 - UNDERCARRIAGE  
1-12 - REFER TO UNIT DIAGRAM 15 - VEHICLE NOT AT SCENE  
13 - TOP 99 - UNKNOWN

**ACTION** **3** **PRE-CRASH ACTIONS** **1 1**

1 - NON-CONTACT	1 - STRAIGHT AHEAD	7 - MAKING U-TURN	13 - NEGOTIATING A CURVE	18 - APPROACHING OR LEAVING VEHICLE
2 - NON-COLLISION	2 - BACKING	8 - ENTERING TRAFFIC LANE	14 - ENTERING OR CROSSING SPECIFIED LOCATION	19 - STANDING
3 - STRIKING	3 - CHANGING LANES	9 - LEAVING TRAFFIC LANE	15 - WALKING, RUNNING, JOGGING, PLAYING	20 - OTHER NON-MOTORIST
4 - STRUCK	4 - OVERTAKING/PASSING	10 - PARKED	16 - WORKING	21 - STANDING OUTSIDE DISABLED VEHICLE
5 - BOTH STRIKING & STRUCK	5 - MAKING RIGHT TURN	11 - SLOWING OR STOPPED IN TRAFFIC	17 - PUSHING VEHICLE	99 - OTHER / UNKNOWN
9 - OTHER / UNKNOWN	6 - MAKING LEFT TURN	12 - DRIVERLESS		

**CONTRIBUTING CIRCUMSTANCES** **0 1**

1 - NONE	7 - LEFT OF CENTER	13 - IMPROPER START FROM A PARKED POSITION	17 - VISION OBSTRUCTION	21 - LYING IN ROADWAY
2 - FAILURE TO YIELD	8 - FOLLOWING TOO CLOSE / ACDA	14 - STOPPED OR PARKED ILLEGALLY	18 - OPERATING DEFECTIVE EQUIPMENT	22 - NOT DISCERNIBLE
3 - RAN RED LIGHT	9 - IMPROPER LANE CHANGE	15 - SWERVING TO AVOID	19 - LOAD SHIFTING/FALLING/ SPILLING	23 - OPENING DOOR INTO ROADWAY
4 - RAN STOP SIGN	10 - IMPROPER PASSING	16 - WRONG WAY	20 - IMPROPER CROSSING	99 - OTHER IMPROPER ACTION
5 - UNSAFE SPEED	11 - DROVE OFF ROAD			
6 - IMPROPER TURN	12 - IMPROPER BACKING			

**TRAFFIC**

**TRAFFICWAY FLOW** **2**

1 - ONE-WAY  
2 - TWO-WAY

**TRAFFIC CONTROL** **4**

1 - ROUNDABOUT 4 - STOP SIGN  
2 - SIGNAL 5 - YIELD SIGN  
3 - FLASHER 6 - NO CONTROL

**SEQUENCE OF EVENTS**

**1 2 0**

1 - OVERTURN/ROLLOVER	6 - EQUIPMENT FAILURE	11 - CROSS CENTERLINE - OPPOSITE DIRECTION OF TRAVEL	16 - RAILWAY VEHICLE	22 - WORK ZONE MAINTENANCE EQUIPMENT
2 - FIRE/EXPLOSION	7 - SEPARATION OF UNITS	12 - DOWNHILL RUNAWAY	17 - ANIMAL - FARM	23 - STRUCK BY FALLING, SHIFTING CARGO OR ANYTHING SET IN MOTION BY A MOTOR VEHICLE
3 - IMMERSION	8 - RAN OFF ROAD RIGHT	13 - OTHER NON-COLLISION	18 - ANIMAL - DEER	24 - OTHER MOVABLE OBJECT
4 - JACKKNIFE	9 - RAN OFF ROAD LEFT	14 - PEDESTRIAN	19 - ANIMAL - OTHER	
5 - CARGO / EQUIPMENT LOSS OR SHIFT	10 - CROSS MEDIAN	15 - PEDALCYCLE	20 - MOTOR VEHICLE IN TRANSPORT	

**# OF THROUGH LANES ON ROAD** **2**

**RAIL GRADE CROSSING** **1**

1 - NOT INVOLVED  
2 - INVOLVED-ACTIVE CROSSING  
3 - INVOLVED-PASSIVE CROSSING

**COLLISION WITH FIXED OBJECT - STRUCK**

25 - IMPACT ATTENUATOR / CRASH CUSHION	31 - GUARDRAIL END	37 - TRAFFIC SIGN POST	43 - CURB	50 - WORK ZONE MAINTENANCE EQUIPMENT
26 - BRIDGE OVERHEAD STRUCTURE	32 - PORTABLE BARRIER	38 - OVERHEAD SIGN POST	44 - DITCH	51 - WALL
27 - BRIDGE PIER OR ABUTMENT	33 - MEDIAN CABLE BARRIER	39 - LIGHT / LUMINARIES SUPPORT	45 - EMBANKMENT	52 - BUILDING
28 - BRIDGE PARAPET	34 - MEDIAN GUARDRAIL BARRIER	40 - UTILITY POLE	46 - FENCE	53 - TUNNEL
29 - BRIDGE RAIL	35 - MEDIAN CONCRETE BARRIER	41 - OTHER POST, POLE OR SUPPORT	47 - MAILBOX	54 - OTHER FIXED OBJECT
30 - GUARDRAIL FACE	36 - MEDIAN OTHER BARRIER	42 - CULVERT	48 - TREE	99 - OTHER / UNKNOWN
			49 - FIRE HYDRANT	

**FIRST HARMFUL EVENT** **1** **MOST HARMFUL EVENT** **1**

**UNIT / NON-MOTORIST DIRECTION**

**FROM 3 TO 4**

1 - NORTH 5 - NORTHEAST  
2 - SOUTH 6 - NORTHWEST  
3 - EAST 7 - SOUTHEAST  
4 - WEST 8 - SOUTHWEST  
9 - OTHER / UNKNOWN

**UNIT SPEED** **0 0 0**

**POSTED SPEED** **2 5**

**DETECTED SPEED** **1**

1 - STATED / ESTIMATED SPEED  
2 - CALCULATED / EDR  
3 - UNDETERMINED



# MOTORIST / Non-MOTORIST

LOCAL REPORT NUMBER  
2, 0, 2, 3, -, 0, 0, 0, 0, 2, 5, 7, 7,

<b>UNIT #</b> 0, 1	<b>NAME: LAST, FIRST, MIDDLE</b> MATIS, SYDNEY, LYNN			<b>DATE OF BIRTH</b> 0, 9, 2, 5, 2, 0, 0, 3		<b>AGE</b> 19	<b>GENDER</b> F			
<b>ADDRESS: STREET, CITY, STATE, ZIP</b> 52687 TOWNSHIP RD 178 ,FRESNO ,OH 43824				<b>CONTACT PHONE - INCLUDE AREA CODE</b>						
<b>INJURIES</b> 5	<b>INJURED TAKEN BY</b>	<b>EMS AGENCY (NAME)</b>	<b>INJURED TAKEN TO: MEDICAL FACILITY (NAME, CITY)</b>		<b>SAFETY EQUIPMENT USED</b> 0, 4	<input type="checkbox"/> DOT-COMPLIANT MC HELMET	<b>SEATING POSITION</b> 0, 1	<b>AIR BAG USAGE</b> 1	<b>EJECTION</b> 1	<b>TRAPPED</b> 1
<b>OL STATE</b> O, H	<b>OPERATOR LICENSE NUMBER</b>		<b>OFFENSE CHARGED</b> 331.17	<b>LOCAL CODE</b> <input checked="" type="checkbox"/>	<b>OFFENSE DESCRIPTION</b> Right of Way when Tu			<b>CITATION NUMBER</b> 26026		
<b>OL CLASS</b> 4	<b>ENDORSEMENT SELECT UP TO 2</b>	<b>RESTRICTION SELECT UP TO 3</b>	<b>DRIVER DISTRACTED BY</b> 1	<b>ALCOHOL / DRUG SUSPECTED</b> <input type="checkbox"/> ALCOHOL <input type="checkbox"/> MARIJUANA <input type="checkbox"/> OTHER DRUG		<b>CONDITION</b> 1	<b>ALCOHOL TEST</b> STATUS TYPE VALUE		<b>DRUG TEST(S)</b> STATUS TYPE RESULT SELECT UP TO 4	

<b>UNIT #</b> 0, 2	<b>NAME: LAST, FIRST, MIDDLE</b> JAMES, JULIE, VIOLET			<b>DATE OF BIRTH</b> 0, 4, 0, 9, 1, 9, 9, 3		<b>AGE</b> 29	<b>GENDER</b> F			
<b>ADDRESS: STREET, CITY, STATE, ZIP</b> 4312 NINA ST ,Rootstown ,OH 44272				<b>CONTACT PHONE - INCLUDE AREA CODE</b>						
<b>INJURIES</b> 5	<b>INJURED TAKEN BY</b>	<b>EMS AGENCY (NAME)</b>	<b>INJURED TAKEN TO: MEDICAL FACILITY (NAME, CITY)</b>		<b>SAFETY EQUIPMENT USED</b> 0, 4	<input type="checkbox"/> DOT-COMPLIANT MC HELMET	<b>SEATING POSITION</b> 0, 1	<b>AIR BAG USAGE</b> 1	<b>EJECTION</b> 1	<b>TRAPPED</b> 1
<b>OL STATE</b> O, H	<b>OPERATOR LICENSE NUMBER</b>		<b>OFFENSE CHARGED</b>	<b>LOCAL CODE</b> <input type="checkbox"/>	<b>OFFENSE DESCRIPTION</b>			<b>CITATION NUMBER</b>		
<b>OL CLASS</b> 4	<b>ENDORSEMENT SELECT UP TO 2</b>	<b>RESTRICTION SELECT UP TO 3</b>	<b>DRIVER DISTRACTED BY</b> 1	<b>ALCOHOL / DRUG SUSPECTED</b> <input type="checkbox"/> ALCOHOL <input type="checkbox"/> MARIJUANA <input type="checkbox"/> OTHER DRUG		<b>CONDITION</b> 1	<b>ALCOHOL TEST</b> STATUS TYPE VALUE		<b>DRUG TEST(S)</b> STATUS TYPE RESULT SELECT UP TO 4	

<b>UNIT #</b> 0, 3	<b>NAME: LAST, FIRST, MIDDLE</b> TRUSSO, ADRIA, LYNN			<b>DATE OF BIRTH</b> 0, 1, 1, 9, 1, 9, 9, 3		<b>AGE</b> 30	<b>GENDER</b> F			
<b>ADDRESS: STREET, CITY, STATE, ZIP</b> 465 ALLEN DR ,Kent ,OH 44240				<b>CONTACT PHONE - INCLUDE AREA CODE</b>						
<b>INJURIES</b> 5	<b>INJURED TAKEN BY</b>	<b>EMS AGENCY (NAME)</b>	<b>INJURED TAKEN TO: MEDICAL FACILITY (NAME, CITY)</b>		<b>SAFETY EQUIPMENT USED</b> 0, 4	<input type="checkbox"/> DOT-COMPLIANT MC HELMET	<b>SEATING POSITION</b> 0, 1	<b>AIR BAG USAGE</b> 1	<b>EJECTION</b> 1	<b>TRAPPED</b> 1
<b>OL STATE</b> O, H	<b>OPERATOR LICENSE NUMBER</b>		<b>OFFENSE CHARGED</b>	<b>LOCAL CODE</b> <input type="checkbox"/>	<b>OFFENSE DESCRIPTION</b>			<b>CITATION NUMBER</b>		
<b>OL CLASS</b> 4	<b>ENDORSEMENT SELECT UP TO 2</b>	<b>RESTRICTION SELECT UP TO 3</b> 0, 3	<b>DRIVER DISTRACTED BY</b> 1	<b>ALCOHOL / DRUG SUSPECTED</b> <input type="checkbox"/> ALCOHOL <input type="checkbox"/> MARIJUANA <input type="checkbox"/> OTHER DRUG		<b>CONDITION</b> 1	<b>ALCOHOL TEST</b> STATUS TYPE VALUE		<b>DRUG TEST(S)</b> STATUS TYPE RESULT SELECT UP TO 4	

INJURIES	SEATING POSITION	AIR BAG	OL CLASS	OL RESTRICTION(S)	DRIVER DISTRACTION	TEST STATUS
1 - FATAL 2 - SUSPECTED SERIOUS INJURY 3 - SUSPECTED MINOR INJURY 4 - POSSIBLE INJURY 5 - NO APPARENT INJURY	1 - FRONT - LEFT SIDE (MOTORCYCLE DRIVER) 2 - FRONT - MIDDLE 3 - FRONT - RIGHT SIDE 4 - SECOND - LEFT SIDE (MOTORCYCLE PASSENGER) 5 - SECOND - MIDDLE 6 - SECOND - RIGHT SIDE 7 - THIRD - LEFT SIDE (MOTORCYCLE SIDE CAR) 8 - THIRD - MIDDLE 9 - THIRD - RIGHT SIDE 10 - SLEEPER SECTION OF TRUCK CAB	1 - NOT DEPLOYED 2 - DEPLOYED FRONT 3 - DEPLOYED SIDE 4 - DEPLOYED BOTH FRONT / SIDE 5 - NOT APPLICABLE 9 - DEPLOYMENT UNKNOWN	1 - CLASS A 2 - CLASS B 3 - CLASS C 4 - REGULAR CLASS (OHIO = D) 5 - M/C MOPED ONLY 6 - NO VALID OL	1 - ALCOHOL INTERLOCK DEVICE 2 - COL INTRASTATE ONLY 3 - CORRECTIVE LENSES 4 - FARM WAIVER 5 - EXCEPT CLASS A BUS 6 - EXCEPT CLASS A & CLASS B BUS 7 - EXCEPT TRACTOR-TRAILER 8 - INTERMEDIATE LICENSE RESTRICTIONS 9 - LEARNER'S PERMIT RESTRICTIONS 10 - LIMITED TO DAYLIGHT ONLY 11 - LIMITED TO EMPLOYMENT 12 - LIMITED - OTHER 13 - MECHANICAL DEVICES (SPECIAL BRAKES, HAND CONTROLS, OR OTHER ADAPTIVE DEVICES) 14 - MILITARY VEHICLES ONLY 15 - MOTOR VEHICLES WITHOUT AIR BRAKES 16 - OUTSIDE MIRROR 17 - PROSTHETIC AID 18 - OTHER	1 - NOT DISTRACTED 2 - MANUALLY OPERATING AN ELECTRONIC COMMUNICATION DEVICE (TEXTING, TYPING, DIALING) 3 - TALKING ON HANDS-FREE COMMUNICATION DEVICE 4 - TALKING ON HAND-HELD COMMUNICATION DEVICE 5 - OTHER ACTIVITY WITH AN ELECTRONIC DEVICE 6 - PASSENGER 7 - OTHER DISTRACTION INSIDE THE VEHICLE 8 - OTHER DISTRACTION OUTSIDE THE VEHICLE 9 - OTHER / UNKNOWN	1 - NONE GIVEN 2 - TEST REFUSED 3 - TEST GIVEN, CONTAMINATED SAMPLE / UNUSABLE 4 - TEST GIVEN, RESULTS KNOWN 5 - TEST GIVEN, RESULTS UNKNOWN
<b>INJURED TAKEN BY</b> 1 - NOT TRANSPORTED / TREATED AT SCENE 2 - EMS 3 - POLICE 9 - OTHER / UNKNOWN		<b>EJECTION</b> 1 - NOT EJECTED 2 - PARTIALLY EJECTED 3 - TOTALLY EJECTED 4 - NOT APPLICABLE	<b>OL ENDORSEMENT</b> H - HAZMAT M - MOTORCYCLE P - PASSENGER N - TANKER Q - MOTOR SCOOTER R - THREE-WHEEL MOTORCYCLE S - SCHOOL BUS T - DOUBLE & TRIPLE TRAILERS X - TANKER / HAZMAT			<b>ALCOHOL TEST TYPE</b> 1 - NONE 2 - BLOOD 3 - URINE 4 - BREATH 5 - OTHER
<b>SAFETY EQUIPMENT</b> 1 - NONE USED 2 - SHOULDER BELT ONLY USED 3 - LAP BELT ONLY USED 4 - SHOULDER & LAP BELT USED 5 - CHILD RESTRAINT SYSTEM - FORWARD FACING 6 - CHILD RESTRAINT SYSTEM - REAR FACING 7 - BOOSTER SEAT 8 - HELMET USED 9 - PROTECTIVE PADS USED (ELBOW, KNEES, ETC.) 10 - REFLECTIVE CLOTHING 11 - LIGHTING - PEDESTRIAN / BICYCLE ONLY 99 - OTHER / UNKNOWN	11 - PASSENGER IN OTHER ENCLOSED CARGO AREA (NON-TRAILING UNIT, BUS, PICK-UP WITH CAP) 12 - PASSENGER IN UNENCLOSED CARGO AREA 13 - TRAILING UNIT 14 - RIDING ON VEHICLE EXTERIOR (NON-TRAILING UNIT) 15 - NON-MOTORIST 99 - OTHER / UNKNOWN	<b>TRAPPED</b> 1 - NOT TRAPPED 2 - EXTRICATED BY MECHANICAL MEANS 3 - FREED BY NON-MECHANICAL MEANS	<b>GENDER</b> F - FEMALE M - MALE U - OTHER / UNKNOWN		<b>CONDITION</b> 1 - APPARENTLY NORMAL 2 - PHYSICAL IMPAIRMENT 3 - EMOTIONAL (E.G., DEPRESSED, ANGRY, DISTURBED) 4 - ILLNESS 5 - FELL ASLEEP, FAINTED, FATIGUED, ETC. 6 - UNDER THE INFLUENCE OF MEDICATIONS / DRUGS / ALCOHOL 9 - OTHER / UNKNOWN	<b>DRUG TEST TYPE</b> 1 - NONE 2 - BLOOD 3 - URINE 4 - OTHER
						<b>DRUG TEST RESULT(S)</b> 1 - AMPHETAMINES 2 - BARBITURATES 3 - BENZODIAZEPINES 4 - CANNABINOIDS 5 - COCAINE 6 - OPIATES / OPIOIDS 7 - OTHER 8 - NEGATIVE RESULTS