

TRAFFIC CRASH REPORT

\*DENOTES MANDATORY FIELD FOR SUPPLEMENT REPORT

LOCAL REPORT NUMBER\*

2 0 2 1 - 0 0 0 0 6 7 0 0

PHOTOS TAKEN  OH-2  OH-3  
 SECONDARY CRASH  OH-1P  OTHER  
 PRIVATE PROPERTY

LOCAL INFORMATION  
 REPORTING AGENCY NAME\*  
**City of Kent Police** NCIC\*  
 0 6 7 0 3

HIT/SKIP  
 1 - SOLVED  
 2 - UNSOLVED  
 NUMBER OF UNITS  
 0 2  
 UNIT IN ERROR  
 98 - ANIMAL  
 99 - UNKNOWN  
 0 1

COUNTY\* 6 7 LOCALITY\* 1  
 LOCATION: CITY VILLAGE TOWNSHIP\*  
**Kent**

CRASH DATE / TIME\*  
 0 4 2 9 2 0 2 1 / 1 5 1 4  
 CRASH SEVERITY  
 1 - FATAL  
 2 - SERIOUS INJURY SUSPECTED  
 3 - MINOR INJURY SUSPECTED  
 4 - INJURY POSSIBLE  
 5 - PROPERTY DAMAGE ONLY  
**5**

ROUTE TYPE S R ROUTE NUMBER 4 3 PREFIX 2  
 LOCATION ROAD NAME  
**WATER** ROAD TYPE S T  
 LATITUDE DECIMAL DEGREES  
 4 1 1 5 0 1 0 7

ROUTE TYPE ROUTE NUMBER PREFIX  
 REFERENCE ROAD NAME (ROAD, MILEPOST, HOUSE #)  
**SUMMIT** ROAD TYPE S T  
 LONGITUDE DECIMAL DEGREES  
 8 1 3 5 8 1 9 7

REFERENCE POINT 1 - INTERSECTION  
 2 - MILE POST  
 3 - HOUSE #  
**1**  
 DIRECTION FROM REFERENCE  
 1 - NORTH  
 2 - SOUTH  
 3 - EAST  
 4 - WEST  
 ROUTE TYPE IR - INTERSTATE ROUTE(TP)  
 US - FEDERAL US ROUTE  
 SR - STATE ROUTE  
 CR - NUMBERED COUNTY ROUTE  
 TR - NUMBERED TOWNSHIP ROUTE  
 ROAD TYPE AL - ALLEY HW - HIGHWAY RD - ROAD  
 AV - AVENUE LA - LAVE SQ - SQUARE  
 BL - BOULEVARD MP - MILEPOST ST - STREET  
 CR - CIRCLE OV - OVAL TE - TERRACE  
 CT - COURT PK - PARKWAY TL - TRAIL  
 DR - DRIVE PI - PIKE WA - WAY  
 HE - HEIGHTS PL - PLACE

INTERSECTION RELATED  
 WITHIN INTERSECTION OR ON APPROACH  
 WITHIN INTERCHANGE AREA  
 NUMBER OF APPROACHES  
**4**  
 ROADWAY  
 ROADWAY DIVIDED

LOCATION OF FIRST HARMFUL EVENT  
 1 - ON ROADWAY  
 2 - ON SHOULDER  
 3 - IN MEDIAN  
 4 - ON ROADSIDE  
 5 - ON GORE  
 6 - OUTSIDE TRAFFIC WAY  
 7 - ON RAMP  
 8 - OFF RAMP  
**0 1**  
 9 - CROSSOVER  
 10 - DRIVEWAY/ALLEY ACCESS  
 11 - RAILWAY GRADE CROSSING  
 12 - SHARED USE PATHS OR TRAILS  
 13 - BIKE LANE  
 14 - TOLL BOOTH  
 99 - OTHER UNKNOWN  
 MANNER OF CRASH COLLISION/IMPACT  
 1 - NOT COLLISION BETWEEN TWO MOTOR VEHICLES IN TRANSPORT  
 2 - REAR-END  
 3 - HEAD-ON  
 4 - REAR TO REAR  
 5 - BACKING  
 6 - ANGLE  
 7 - SIDESWIPE, SAME DIRECTION  
 8 - SIDESWIPE, OPPOSITE DIRECTION  
 9 - OTHER / UNKNOWN

DIRECTION OF TRAVEL  
 1 - NORTH  
 2 - SOUTH  
 3 - EAST  
 4 - WEST  
 MEDIAN TYPE  
 1 - DIVIDED FLUSH MEDIAN (<4 FEET)  
 2 - DIVIDED FL SH MEDIAN 4 FEET  
 3 - DIVIDED DEPRESSED MEDIAN  
 4 - DIVIDED RAISED MEDIAN (ANY TYPE)  
 9 - OTHER/ NKNOWN

WORK ZONE RELATED   
 WORKERS PRESENT   
 LAW ENFORCEMENT PRESENT   
 ACTIVE SCHOOL ZONE   
 WORK ZONE TYPE  
 1 - LANE CLOSURE  
 2 - LANE SHIFT/CROSSOVER  
 3 - WORK ON SHOULDER OR MEDIAN  
 4 - INTERMITTENT OR MOVING WORK  
 5 - OTHER  
 LOCATION OF CRASH IN WORK ZONE  
 1 - BEFORE THE 1ST WORK ZONE WARNING SIGN  
 2 - ADVANCE WARNING AREA  
 3 - TRANSITION AREA  
 4 - ACTIVITY AREA  
 5 - TERMINATION AREA

CONTOUR  
**1**  
 1 - STRAIGHT LEVEL  
 2 - STRAIGHT GRADE  
 3 - CURVE LEVEL  
 4 - CURVE GRADE  
 9 - OTHER/UNKNOWN  
 CONDITIONS  
**2**  
 1 - DRY  
 2 - WET  
 3 - SNOW  
 4 - ICE  
 5 - SAND, MUD, DIRT, OIL, GRAVEL  
 6 - WATER (STANDING, MOVING)  
 7 - SLUSH  
 9 - OTHER/UNKNOWN  
 SURFACE  
**2**  
 1 - CONCRETE  
 2 - BLACKTOP, BITUMINOUS, ASPHALT  
 3 - BRICK/BLOCK  
 4 - SLAG, GRAVEL, STONE  
 5 - DIRT  
 9 - OTHER

LIGHT CONDITION  
 1 - DAYLIGHT  
 2 - DAWN/DUSK  
 3 - DARK - LIGHTED ROADWAY  
 4 - DARK - ROADWAY NOT LIGHTED  
 5 - DARK - UNKNOWN ROADWAY LIGHTING  
 9 - OTHER / UNKNOWN  
**1**  
 WEATHER  
 1 - CLEAR  
 2 - CLOUDY  
 3 - FOG, SMOG, SMOKE  
 4 - RAIN  
 5 - SLEET, HAIL  
 6 - SNOW  
 7 - SEVERE CROSSWINDS  
 8 - BLOWING SAND, SOIL, DIRT, SNOW  
 9 - FREEZING RAIN OR FREEZING DRIZZLE  
 99 - OTHER / UNKNOWN  
**0 4**

NARRATIVE  
**UNIT 1 WAS TRAVELING NB ON S WATER ST IN THE LEFT LANE. UNIT 2 WAS TRAVELING SB ON S WATER ST MAKING A LEFT TURN ONTO E SUMMIT ST TO GO EB. UNIT 1 HAD A VEHICLE STOPPED IN FRONT OF THEM AND WENT AROUND IT RUNNING THROUGH THE RED LIGHT AT S WATER ST AND E SUMMIT ST. UNIT 1 STRUCK THE REAR RIGHT SIDE OF UNIT 2. UNIT 1 WAS CITED FOR RED LIGHT.**

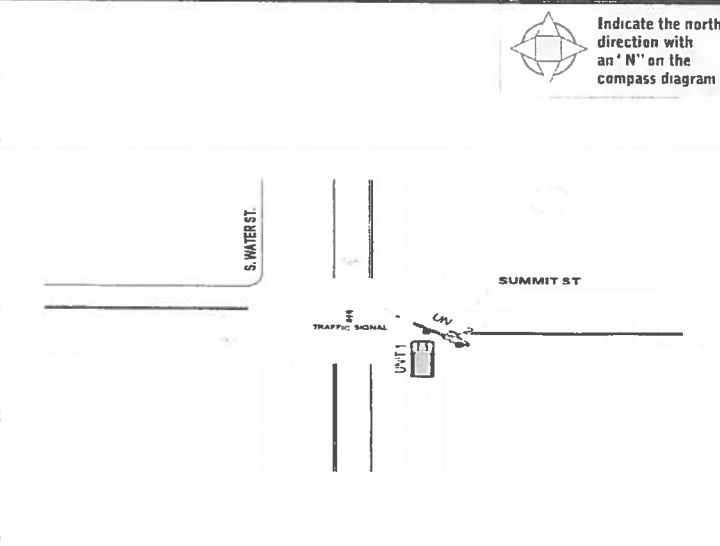

CRASH REPORTED DATE / TIME: 0 4 2 9 2 0 2 1 / 1 5 1 4  
 DISPATCH DATE / TIME: 0 4 2 9 2 0 2 1 / 1 5 1 6  
 ARRIVAL DATE / TIME: 0 4 2 9 2 0 2 1 / 1 5 1 9  
 SCENE CLEARED DATE / TIME: 0 4 2 9 2 0 2 1 / 1 6 1 0  
 REPORT TAKEN BY  
 POLICE AGENCY  
 MOTORIST  
 SUPPLEMENT (CORRECTION OR ADDITION TO AN EXISTING REPORT SENT TO CSRS)  
 TOTAL TIME ROADWAY CLOSED: 0 4 0  
 OTHER INVESTIGATION TIME: 0 2 0  
 TOTAL MINUTES: 0 7 6  
 OFFICER'S NAME\*  
**Moore, Matthew J**  
 OFFICER'S BADGE NUMBER\*  
**2 5 2**  
 CHECKED BY OFFICER'S NAME\*  
**Short, Jason M**  
 CHECKED BY OFFICER'S BADGE NUMBER\*  
**2 2 8**

LOCAL REPORT NUMBER  
**2,0,2,1 - 0,0,0,0,6,7,0,0**

**OWNER**

UNIT # **01** OWNER NAME: LAST, FIRST, MIDDLE ( ) SAVE AS DRIVER  
**SCOTTON, GARY, JOHN**

OWNER ADDRESS: STREET, CITY, STATE, ZIP ( ) SAME AS DRIVER  
**11253 PECK RD, Mantua Twp, OH 44255**

COMMERCIAL CARRIER: NAME, ADDRESS, CITY, STATE, ZIP  
 COMMERCIAL CARRIER PHONE: INCLUDE AREA CODE

**DAMAGE**

**DAMAGE SCALE**

**4** 1 - NONE 3 - FUNCTIONAL DAMAGE  
 2 - MINOR DAMAGE 4 - DISABLING DAMAGE  
 9 - UNKNOWN

**VEHICLE**

LP STATE **OH** LICENSE PLATE # **EDB3893** VEHICLE IDENTIFICATION # **1FMCU0D70AKA02129** VEHICLE YEAR **2010** VEHICLE MAKE **Ford**

INSURANCE VERIFIED ALLSTATE INSURANCE POLICY # **980971723** COLOR **BLU** VEHICLE MODEL **EXPLORER**

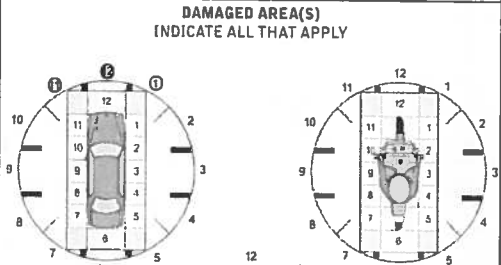

TYPE OF USE  
 COMMERCIAL  GOVERNMENT  IN EMERGENCY RESPONSE

US DOT # \_\_\_\_\_

TOWED BY: COMPANY NAME  
**Bakers Towing**

HAZARDOUS MATERIAL  
 MATERIAL RELEASED CLASS # \_\_\_\_\_ PLACARD ID # \_\_\_\_\_  
 PLACARD

UNIT TYPE **01**

**00** # OF TRAILING UNITS

1 - PASSENGER CAR	7 - MOTORCYCLE 2-WHEELED	12 - GOLF CART	18 - LIMO (LIVERY VEHICLE)	23 - PEDESTRIAN / SKATER
2 - PASSENGER VAN (MINIVAN)	8 - MOTORCYCLE 3-WHEELED	13 - SNOWMOBILE	19 - BUS (16+ PASSENGERS)	24 - WHEELCHAIR (ANY TYPE)
3 - SPORT UTILITY VEHICLE	9 - AUTOCYCLE	14 - SINGLE UNIT TRUCK	20 - OTHER VEHICLE	25 - OTHER NON-MOTORIST
4 - PICK UP	10 - MOPED OR MOTORIZED BICYCLE	15 - SEMI-TRACTOR	21 - HEAVY EQUIPMENT	26 - BICYCLE
5 - CARGO VAN	11 - ALL TERRAIN VEHICLE (ATV / UTV)	16 - FARM EQUIPMENT	22 - ANIMAL WITH RIDER OR ANIMAL-DRAWN VEHICLE	27 - TRAIN
6 - VAN (9-15 SEATS)		17 - MOTORHOME		99 - UNKNOWN OR HITS/SKIP

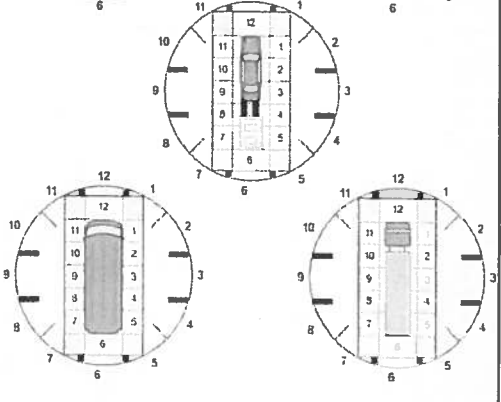

WAS VEHICLE OPERATING IN AUTONOMOUS MODE WHEN CRASH OCCURRED?  
**2** 1-YES 2-NO 9-OTHER / UNKNOWN

AUTONOMOUS MODE LEVEL **0**

0 - NO AUTOMATION  
 1 - DRIVER ASSISTANCE  
 2 - PARTIAL AUTOMATION  
 3 - CONDITIONAL AUTOMATION  
 4 - HIGH AUTOMATION  
 5 - FULL AUTOMATION  
 9 - UNKNOWN

SPECIAL FUNCTION **01**

1 - NONE	6 - BUS - CHARTER/TOUR	11 - FIRE	16 - FARM	21 - MAIL CARRIER
2 - TAXI	7 - BUS - INTERCITY	12 - MILITARY	17 - MOWING	99 - OTHER / UNKNOWN
3 - ELECTRONIC RIDE SHARING	8 - BUS - SHUTTLE	13 - POLICE	18 - SNOW REMOVAL	
4 - SCHOOL TRANSPORT	9 - BUS - OTHER	14 - PUBLIC UTILITY	19 - TOWING	
5 - BUS - TRANSIT/COMMUTER	10 - AMBULANCE	15 - CONSTRUCTION EQUIPMENT	20 - SAFETY SERVICE PATROL	

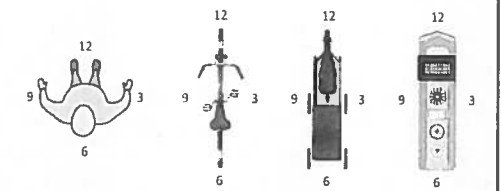

CARGO BODY TYPE **01**

1 - NO CARGO BODY TYPE / NOT APPLICABLE	3 - VEHICLE TOWING ANOTHER MOTOR VEHICLE	5 - INTERMODAL CONTAINER CHASSIS	8 - POLE	12 - CONCRETE MIXER
2 - BUS	4 - LOGGING	6 - CARGO VAN/ENCLOSED BOX	9 - CARGO TANK	13 - AUTO TRANSPORTER
		7 - GRAIN/CHIPS/GRAVEL	10 - FLAT BED	14 - GARBAGE/REFUSE
			11 - DUMP	99 - OTHER / UNKNOWN

VEHICLE DEFECTS

1 - TURN SIGNALS	4 - BRAKES	7 - WORN OR SLICK TIRES	9 - MOTOR TROUBLE	99 - OTHER / UNKNOWN
2 - HEAD LAMPS	5 - STEERING	8 - TRAILER EQUIPMENT DEFECTIVE	10 - DISABLED FROM PRIOR ACCIDENT	
3 - TAIL LAMPS	6 - TIRE BLOWOUT			

- NO DAMAGE [ 0 ]  - UNDERCARRIAGE [ 14 ]  
 - TOP [ 13 ]  - ALL AREAS [ 15 ]  
 - UNIT NOT AT SCENE [ 16 ]

NON-MOTORIST LOCATION AT IMPACT

1 - INTERSECTION - MARKED CROSSWALK	3 - INTERSECTION - OTHER	6 - BICYCLE LANE	9 - MEDIA CROSSING ISLAND	12 - FIRST RESPONDER AT INCIDENT SCENE
2 - INTERSECTION - UNMARKED CROSSWALK	4 - MIDBLOCK - MARKED CROSSWALK	7 - SHOULDER / ROADSIDE	10 - DRIVEWAY ACCESS	99 - OTHER / UNKNOWN
	5 - TRAVEL LANE - OTHER LOCATION	8 - SIDEWALK	11 - SHARED USE PATHS OR TRAILS	

ACTION **3**

1 - NON-CONTACT	1 - STRAIGHT AHEAD	7 - MAKING U-TURN	13 - NEGOTIATING A CURVE	18 - APPROACHING OR LEAVING VEHICLE
2 - NON-COLLISION	2 - BACKING	8 - ENTERING TRAFFIC LANE	14 - ENTERING OR CROSSING SPECIFIED LOCATION	19 - STANDING
3 - STRIKING	3 - CHANGING LANES	9 - LEAVING TRAFFIC LANE	15 - WALKING, RUNNING, JOGGING, PLAYING	20 - OTHER NON-MOTORIST
4 - STRUCK	4 - OVERTAKING/PASSING	10 - PARKED	16 - WORKING	21 - STANDING OUTSIDE DISABLED VEHICLE
5 - BOTH STRIKING & STRUCK	5 - MAKING RIGHT TURN	11 - SLOWING OR STOPPED IN TRAFFIC	17 - PUSHING VEHICLE	99 - OTHER / UNKNOWN
9 - OTHER / UNKNOWN	6 - MAKING LEFT TURN	12 - DRIVERLESS		

INITIAL POINT OF CONTACT

0 - NO DAMAGE 14 - UNDERCARRIAGE  
**1, 2** 1-12 - REFER TO UNIT DIAGRAM 15 - VEHICLE NOT AT SCENE  
 13 - TOP 99 - UNKNOWN

CONTRIBUTING CIRCUMSTANCES **0, 3**

1 - NONE	7 - LEFT OF CENTER	13 - IMPROPER START FROM A PARKED POSITION	17 - VISION OBSTRUCTION	21 - LYING IN ROADWAY
2 - FAILURE TO YIELD	8 - FOLLOWING TOO CLOSE / ACDA	14 - STOPPED OR PARKED ILLEGALLY	18 - OPERATING DEFECTIVE EQUIPMENT	22 - NOT DISCERNIBLE
3 - RAN RED LIGHT	9 - IMPROPER LANE CHANGE	15 - SWERVING TO AVOID	19 - LOAD SHIFTING/FALLING/ SPILLING	23 - OPENING DOOR INTO ROADWAY
4 - RAN STOP SIGN	10 - IMPROPER PASSING	16 - WRONG WAY	20 - IMPROPER CROSSING	99 - OTHER IMPROPER ACTION
5 - UNSAFE SPEED	11 - DROVE OFF ROAD			
6 - IMPROPER TURN	12 - IMPROPER BACKING			

TRAFFICWAY FLOW **2**

1 - ONE-WAY  
 2 - TWO-WAY

TRAFFIC CONTROL **2**

1 - ROUNDABOUT 4 - STOP SIGN  
 2 - SIGNAL 5 - YIELD SIGN  
 3 - FLASHER 6 - NO CONTROL

SEQUENCE OF EVENTS

EVENTS

1 - OVERTURN/ROLLOVER	6 - EQUIPMENT FAILURE	11 - CROSS CENTERLINE - OPPOSITE DIRECTION OF TRAVEL	16 - RAILWAY VEHICLE	22 - WORK ZONE MAINTENANCE EQUIPMENT
2 - FIRE/EXPLOSION	7 - SEPARATION OF UNITS	12 - DOWNHILL RUNAWAY	17 - ANIMAL - BARY	23 - STRUCK BY FALLING, SHIFTING CARGO OR ANYTHING SET IN MOTION BY A MOTOR VEHICLE
3 - IMMERSION	8 - RAN OFF ROAD RIGHT	13 - OTHER NON-COLLISION	18 - ANIMAL - DEER	24 - OTHER MOVABLE OBJECT
4 - JACKKNIFE	9 - RAN OFF ROAD LEFT	14 - PEDESTRIAN	19 - ANIMAL - OTHER	
5 - CARGO / EQUIPMENT LOSS OR SHIFT	10 - CROSS MEDIAN	15 - PEDESTAL CYCLE	20 - MOTOR VEHICLE IN TRANSPORT	
			21 - PARKED MOTOR VEHICLE	

# OF THROUGH LANES ON ROAD **2**

RAIL GRADE CROSSING **1**

1 - NOT INVOLVED  
 2 - INVOLVED-ACTIVE CROSSING  
 3 - INVOLVED-PASSIVE CROSSING

COLLISION WITH FIXED OBJECT - STRUCK

25 - IMPACT ATTENUATOR / CRASH CUSHION	31 - GUARDRAIL END	37 - TRAFFIC SIGN POST	43 - CURB	50 - WORK ZONE MAINTENANCE EQUIPMENT
26 - BRIDGE OVERHEAD STRUCTURE	32 - PORTABLE BARRIER	38 - OVERHEAD SIGN POST	44 - DITCH	51 - WALL
27 - BRIDGE PIER OR ABUTMENT	33 - MEDIAN CABLE BARRIER	39 - LIGHT / LUMINARIES SUPPORT	45 - EMBANKMENT	52 - BUILDING
28 - BRIDGE PARAPET	34 - MEDIAN GUARDRAIL BARRIER	40 - UTILITY POLE	46 - FENCE	53 - TUNNEL
29 - BRIDGE RAIL	35 - MEDIAN CONCRETE BARRIER	41 - OTHER POST, POLE OR SUPPORT	47 - MAILBOX	54 - OTHER FIXED OBJECT
30 - GUARDRAIL FACE	36 - MEDIAN OTHER BARRIER	42 - CULVERT	48 - TREE	99 - OTHER / UNKNOWN
			49 - FIRE HYDRANT	

FIRST HARMFUL EVENT **1** MOST HARMFUL EVENT **1**

UNIT / NON-MOTORIST DIRECTION

FROM **2** TO **1**

1 - NORTH 5 - NORTH-EAST  
 2 - SOUTH 6 - NORTH-WEST  
 3 - EAST 7 - SOUTH-EAST  
 4 - WEST 8 - SOUTH-WEST  
 9 - OTHER / UNKNOWN

UNIT SPEED **0, 2, 5**

POSTED SPEED **2, 5**

DETECTED SPEED **1**

1 - STATED / ESTIMATED SPEED  
 2 - CALCULATED / EDR  
 3 - UNDETERMINED

**OWNER**

UNIT # 02 OWNER NAME: LAST, FIRST, MIDDLE (SAME AS DRIVER)  
**DAYWALT, DAVID, E**

OWNER ADDRESS: STREET, CITY, STATE, ZIP (SAME AS DRIVER)  
**3449 HERRIFF RD, Rootstown, OH 44266**

COMMERCIAL CARRIER: NAME, ADDRESS, CITY, STATE, ZIP \_\_\_\_\_  
COMMERCIAL CARRIER PHONE: INC. USE AREA CODE \_\_\_\_\_

**VEHICLE**

LP STATE OH LICENSE PLATE # PMC1534 VEHICLE IDENTIFICATION # 1G1E111X3F508318 VEHICLE YEAR 2003 VEHICLE MAKE Chevrolet

INSURANCE VERIFIED INSURANCE COMPANY THOMPSON INS GROUP INSURANCE POLICY # 340226400 COLOR WHI VEHICLE MODEL C7500

COMMERCIAL  GOVERNMENT  IN EMERGENCY RESPONSE US DOT # \_\_\_\_\_ TOWED BY: COMPANY NAME Bainbridge Towing

INTERLOCK DEVICE EQUIPPED  HIT/SKIP UNIT #OCCUPANTS 01 VEHICLE WEIGHT GVWR/GCWR  
1 - <10K LBS.  
2 - 10,001 - 26K LBS.  
3 - >26K LBS. HAZARDOUS MATERIAL CLASS # PLACARD ID # \_\_\_\_\_

UNIT TYPE 20 # OF TRAILING UNITS 00

1 - PASSENGER CAR 7 - MOTORCYCLE 2-WHEELED 12 - GOLF CART 13 - LIMO (LIVERY VEHICLE) 23 - PEDESTRIAN / SKATER  
2 - PASSENGER VAN (MINIVAN) 8 - MOTORCYCLE 3-WHEELED 13 - SNOWMOBILE 19 - BUS (15+ PASSENGERS) 24 - WHEELCHAIR (ANY TYPE)  
3 - SPORT UTILITY VEHICLE 9 - AUTOCYCLE 14 - SINGLE UNIT TRUCK 20 - OTHER VEHICLE 25 - OTHER NON-MOTORIST  
4 - PICK UP 10 - MOPED OR MOTORIZED BICYCLE 15 - SEVI-TRACTOR 21 - HEAVY EQUIPMENT 26 - BICYCLE  
5 - CARGO VAN 11 - ALL TERRAIN VEHICLE (ATV / UTV) 16 - FARM EQUIPMENT 22 - ANIMAL WITH RIDER OR ANIMAL-DRAWN VEHICLE 27 - TRAILER  
6 - VAN (9-15 SEATS) 17 - MOTORHOME 99 - UNKNOWN OR HIT/SKIP

WAS VEHICLE OPERATING IN AUTONOMOUS MODE WHEN CRASH OCCURRED? 2 AUTONOMOUS MODE LEVEL 0

1 - YES 2 - NO 9 - OTHER / UNKNOWN 0 - NO AUTOMATION 1 - DRIVER ASSISTANCE 3 - CONDITIONAL AUTOMATION 9 - UNKNOWN  
2 - PARTIAL AUTOMATION 4 - HIGH AUTOMATION 5 - FULL AUTOMATION

SPECIAL FUNCTION 19

1 - NONE 6 - BUS - CHARTER/TOUR 11 - FIRE 16 - FERRY 21 - MAIL CARRIER  
2 - TAXI 7 - BUS - INTERCITY 12 - MILITARY 17 - MOWING 99 - OTHER UNKNOWN  
3 - ELECTRONIC RIDE SHARING 8 - BUS - SHUTTLE 13 - POLICE 18 - SNOW REMOVAL  
4 - SCHOOL TRANSPORT 9 - BUS - OTHER 14 - PUBLIC UTILITY 19 - TOWING  
5 - BUS - TRANSIT/COMMUTER 10 - AMBULANCE 15 - CONSTRUCTION EQUIPMENT 20 - SAFETY SERVICE PATROL

CARGO BODY TYPE 01

1 - NO CARGO BODY TYPE / NOT APPLICABLE 3 - VEHICLE TOWING ANOTHER MOTOR VEHICLE 5 - INTERMODAL CONTAINER CHASSIS 8 - POLE 12 - CONCRETE MIXER  
2 - BUS 4 - LOGGING 6 - CARGO VAN ENCLOSED BOX 9 - CARGO TANK 13 - AUTO TRANSPORTER  
7 - GRAIN CHIPS/GRAVEL 10 - DUMP 11 - FLAT BED 14 - GARBAGE/REFUSE 15 - OTHER UNKNOWN

VEHICLE DEFECTS

1 - TURN SIGNALS 4 - BRAKES 7 - MGRY OR SLICK TIRES 9 - MOTOR TROUBLE 99 - OTHER UNKNOWN  
2 - HEAD LAMPS 5 - STEERING 8 - TRAILER EQUIPMENT DEFECTIVE 10 - DISABLED FROM PRIOR ACCIDENT  
3 - TAIL LAMPS 6 - TIRE BLOWOUT

NON-MOTORIST LOCATION AT IMPACT 1

1 - INTERSECTION - MARKED CROSSWALK 3 - INTERSECTION - OTHER 6 - BICYCLE LANE 9 - MEDIAN/CROSSING ISLAND 12 - FIRST RESPONDER AT INCIDENT SCENE  
2 - INTERSECTION - UNMARKED CROSSWALK 4 - MIDBLOCK - MARKED CROSSWALK 7 - SHOULDER/ROADSIDE 10 - DRIVEWAY ACCESS 13 - DRIVEWAY ACCESS  
3 - SIDEWALK 8 - SIDEWALK 11 - SHARED USE PATHS OR TRAILS 14 - OTHER UNKNOWN 99 - OTHER UNKNOWN  
5 - TRAVEL LANE - OTHER LOCATION

ACTION 4 PRE-CRASH ACTIONS 06

1 - NON-CONTACT 1 - STRAIGHT AHEAD 7 - MAKING U-TURN 13 - NEGOTIATING A CURVE 16 - APPROACHING OR LEAVING VEHICLE  
2 - NON-COLLISION 2 - BACKING 8 - ENTERING TRAFFIC LANE 14 - ENTERING OR CROSSING SPECIFIED LOCATION 19 - STANDING  
3 - STRUCK 3 - CHANGING LANES 9 - LEAVING TRAFFIC LANE 15 - WALKING / RUNNING / JOGGING / PLAYING 20 - OTHER NON-MOTORIST  
4 - STRUCK & STRUCK 4 - OVERTAKING/PASSING 10 - PARKED 16 - WORKING 21 - STANDING OUTSIDE DISABLED VEHICLE  
5 - BOTH STRUCK & STRUCK 5 - MAKING RIGHT TURN 11 - SLOWING OR STOPPED IN TRAFFIC 17 - PUSHING VEHICLE 99 - OTHER UNKNOWN  
9 - OTHER UNKNOWN 6 - MAKING LEFT TURN 12 - DR VERLESS

CONTRIBUTING CIRCUMSTANCES 01

1 - NONE 7 - LEFT OF CENTER 13 - IMPROPER START FROM A PARKED POSITION 17 - VISION OBSTRUCTION 21 - LYING IN ROADWAY  
2 - FAILURE TO YIELD 8 - FOLLOWING TOO CLOSE / ACCA 14 - STOPPED OR PARKED ILLEGALLY 18 - OPERATING DEFECTIVE EQUIPMENT 22 - NOT DISCRETELY  
3 - RAN RED LIGHT 9 - IMPROPER LANE CHANGE 15 - SWERVING TO AVOID 19 - LEAD SPLITTING / FALLING / SPLITTING 23 - OPENING DOOR IN TC ROADWAY  
4 - RAN STOP SIGN 10 - IMPROPER PASSING 16 - DROVE OFF ROAD 20 - OTHER IMPROPER ACTION 99 - OTHER IMPROPER ACTION  
5 - UNSAFE SPEED 11 - DROVE OFF ROAD 12 - IMPROPER BACKING

SEQUENCE OF EVENTS

1 20 1 - OVERTURN/ROLLOVER 6 - EQUIPMENT FAILURE 11 - CROSS CENTERLINE - OPPOSITE DIRECTION OF TRAVEL 16 - RAILWAY VEHICLE 22 - WORK ZONE MAINTENANCE EQUIPMENT  
2 - FIRE EXPLOSION 7 - SEPARATION OF UNITS 12 - DOWNHILL RUNAWAY 17 - ANIMAL - FERRY 23 - STRUCK BY FALLING, SHIFTING CARGO OR ANYTHING SET IN MOTION BY A MOTOR VEHICLE  
3 - IMMERSION 8 - RAN OFF ROAD RIGHT 13 - OTHER NON-COLLISION 18 - ANIMAL - OTHER 24 - OTHER MOVABLE OBJECT  
4 - JACKKNIFE 9 - RAN OFF ROAD LEFT 14 - PEDESTRIAN 19 - MOTOR VEHICLE IN TRANSPORT  
5 - CARGO / EQUIPMENT LOSS OR SHIFT 10 - CROSS MEDIAN 15 - PEDAL CYCLE 21 - PARKED MOTOR VEHICLE

COLLISION WITH FIXED OBJECT - STRUCK

25 - IMPACT ATTENUATOR / CRASH CUSHION 31 - GUARDRAIL END 37 - TRAFFIC SIGN POST 43 - CLRB 50 - WORK ZONE MAINTENANCE EQUIPMENT  
26 - BRIDGE OVERHEAD STRUCTURE 32 - PORTABLE BARRIER 38 - OVERHEAD SIGN POST 44 - DITCH 51 - WALL  
27 - BRIDGE PIER OR ABUTMENT 33 - MEDIUM CABLE BARRIER 39 - LIGHT / LUMINARIES SUPPORT 45 - EMBANKMENT 52 - BUILDING  
28 - BRIDGE PARAPET 34 - MEDIUM GUARDRAIL BARRIER 40 - UTILITY POLE 46 - FENCE 53 - TUNNEL  
29 - BRIDGE RAIL 35 - MEDIUM CONCRETE BARRIER 41 - OTHER POST POLE OR SUPPORT 47 - MAILBOX 54 - OTHER FIXED OBJECT  
30 - GUARDRAIL FACE 36 - MEDIUM OTHER BARRIER 42 - CULVERT 48 - TREE 49 - FIRE HYDRANT 99 - OTHER UNKNOWN

FIRST HARMFUL EVENT 1 MOST HARMFUL EVENT 1

LOCAL REPORT NUMBER  
2021-00006700

DAMAGE

DAMAGE SCALE

3 1 - NONE 3 - FUNCTIONAL DAMAGE  
2 - MINOR DAMAGE 4 - DISABLING DAMAGE  
9 - UNKNOWN

DAMAGED AREA(S)  
INDICATE ALL THAT APPLY

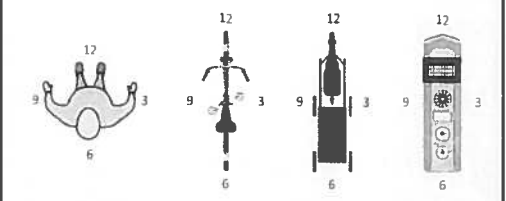
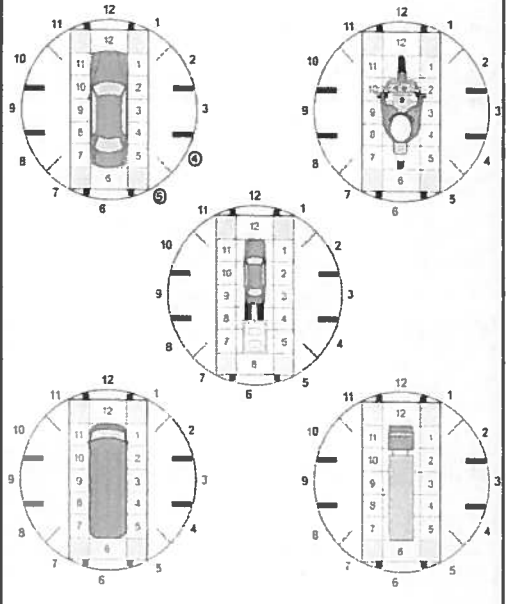

- NO DAMAGE [ 0 ]  - UNDERCARRIAGE [ 14 ]  
 - TOP [ 13 ]  - ALL AREAS [ 15 ]  
 - UNIT NOT AT SCENE [ 16 ]

INITIAL POINT OF CONTACT

04 0 - NO DAMAGE 14 - UNDERCARRIAGE  
1-12 - REFER TO UNIT DIAGRAM 15 - VEHICLE NOT AT SCENE  
13 - TOP 99 - UNKNOWN

TRAFFIC

TRAFFICWAY FLOW 2 TRAFFIC CONTROL 2

1 - ONE-WAY 2 - TWO-WAY 1 - ROUNDABOUT 4 - STOP SIGN  
2 - SIGNAL 5 - YIELD SIGN  
3 - FLASHER 6 - NO CONTROL

# OF THROUGH LANES ON ROAD 2 RAIL GRADE CROSSING 1

1 - NOT INVOLVED  
2 - INVOLVED-ACTIVE CROSSING  
3 - INVOLVED-PASSIVE CROSSING

UNIT / NON-MOTORIST DIRECTION

FROM 1 TO 3

1 - NORTH 5 - NORTHEAST  
2 - SOUTH 6 - NORTHWEST  
3 - EAST 7 - SOUTHEAST  
4 - WEST 8 - SOUTHWEST  
9 - OTHER / UNKNOWN

UNIT SPEED 010 DETECTED SPEED 1

1 - STATED / ESTIMATED SPEED  
2 - CALCULATED / EDR  
3 - UNDETERMINED

POSTED SPEED 25



# MOTORIST / Non-MOTORIST

LOCAL REPORT NUMBER  
2 0 2 1 - 0 0 0 0 6 7 0 0

<b>UNIT #</b> 0 1	<b>NAME: LAST, FIRST, MIDDLE</b> SCOTTON, RACHEL, MARGARETTE	<b>DATE OF BIRTH</b> 1 2 / 1 6 / 2 0 0 1	<b>AGE</b> 1 9	<b>GENDER</b> F
<b>ADDRESS: STREET, CITY, STATE, ZIP</b> 1950 MOHAWK PL, Kent, OH 44240		<b>CONTACT PHONE - INCLUDE AREA CODE</b>		

<b>INJURIES</b> 5	<b>INJURED TAKEN BY</b>	<b>EMS AGENCY (NAME)</b>	<b>INJURED TAKEN TO: MEDICAL FACILITY (NAME, CITY)</b>	<b>SAFETY EQUIPMENT USED</b> 0 4	<input type="checkbox"/> DOT-COMPLIANT MC HELMET	<b>SEATING POSITION</b> 0 1	<b>AIR BAG USAGE</b> 1	<b>EJECTION</b> 1	<b>TRAPPED</b> 1	
<b>OL STATE</b> O, H	<b>OPERATOR LICENSE NUMBER</b>	<b>OFFENSE CHARGED</b> 313.03C1	<b>LOCAL CODE</b> <input checked="" type="checkbox"/>	<b>OFFENSE DESCRIPTION</b> Traffic Control Sign		<b>CITATION NUMBER</b> 66533				
<b>OL CLASS</b> 4	<b>ENDORSEMENT</b>	<b>RESTRICTION</b>	<b>DRIVER DISTRACTED BY</b> 9	<b>ALCOHOL / DRUG SUSPECTED</b> <input type="checkbox"/> ALCOHOL <input type="checkbox"/> MARIJUANA <input type="checkbox"/> OTHER DRUG		<b>CONDITION</b> 1	<b>ALCOHOL TEST</b>		<b>DRUG TEST(S)</b>	

<b>UNIT #</b> 0 2	<b>NAME: LAST, FIRST, MIDDLE</b> TURNER, LAWRENCE, T	<b>DATE OF BIRTH</b> 0 9 / 0 1 / 1 9 7 8	<b>AGE</b> 4 2	<b>GENDER</b> M
<b>ADDRESS: STREET, CITY, STATE, ZIP</b> 728 E MAIN ST, Ravenna, OH 44266		<b>CONTACT PHONE - INCLUDE AREA CODE</b>		

<b>INJURIES</b> 5	<b>INJURED TAKEN BY</b>	<b>EMS AGENCY (NAME)</b>	<b>INJURED TAKEN TO: MEDICAL FACILITY (NAME, CITY)</b>	<b>SAFETY EQUIPMENT USED</b> 0 4	<input type="checkbox"/> DOT-COMPLIANT MC HELMET	<b>SEATING POSITION</b> 0 1	<b>AIR BAG USAGE</b> 1	<b>EJECTION</b> 1	<b>TRAPPED</b> 1	
<b>OL STATE</b> O, H	<b>OPERATOR LICENSE NUMBER</b>	<b>OFFENSE CHARGED</b>	<b>LOCAL CODE</b> <input type="checkbox"/>	<b>OFFENSE DESCRIPTION</b>		<b>CITATION NUMBER</b>				
<b>OL CLASS</b> 4	<b>ENDORSEMENT</b>	<b>RESTRICTION</b>	<b>DRIVER DISTRACTED BY</b> 1	<b>ALCOHOL / DRUG SUSPECTED</b> <input type="checkbox"/> ALCOHOL <input type="checkbox"/> MARIJUANA <input type="checkbox"/> OTHER DRUG		<b>CONDITION</b> 1	<b>ALCOHOL TEST</b>		<b>DRUG TEST(S)</b>	

<b>UNIT #</b>	<b>NAME: LAST, FIRST, MIDDLE</b>	<b>DATE OF BIRTH</b>	<b>AGE</b>	<b>GENDER</b>
<b>ADDRESS: STREET, CITY, STATE, ZIP</b>		<b>CONTACT PHONE - INCLUDE AREA CODE</b>		

<b>INJURIES</b>	<b>INJURED TAKEN BY</b>	<b>EMS AGENCY (NAME)</b>	<b>INJURED TAKEN TO: MEDICAL FACILITY</b>	<b>SAFETY EQUIPMENT USED</b>	<input type="checkbox"/> DOT-COMPLIANT MC HELMET	<b>SEATING POSITION</b>	<b>AIR BAG USAGE</b>	<b>EJECTION</b>	<b>TRAPPED</b>	
<b>OL STATE</b>	<b>OPERATOR LICENSE NUMBER</b>	<b>OFFENSE CHARGED</b>	<b>LOCAL CODE</b> <input type="checkbox"/>	<b>OFFENSE DESCRIPTION</b>		<b>CITATION NUMBER</b>				
<b>OL CLASS</b>	<b>ENDORSEMENT</b>	<b>RESTRICTION</b>	<b>DRIVER DISTRACTED BY</b>	<b>ALCOHOL / DRUG SUSPECTED</b> <input type="checkbox"/> ALCOHOL <input type="checkbox"/> MARIJUANA <input type="checkbox"/> OTHER DRUG		<b>CONDITION</b>	<b>ALCOHOL TEST</b>		<b>DRUG TEST(S)</b>	

INJURIES	SEATING POSITION	AIR BAG	OL CLASS	OL RESTRICTION(S)	DRIVER DISTRACTION	TEST STATUS
1 - FATAL	1 - FRONT - LEFT SIDE (MOTORCYCLE DRIVER)	1 - NOT DEPLOYED	1 - CLASS A	1 - ALCOHOL INTERLOCK DEVICE	1 - NOT DISTRACTED	1 - NONE GIVEN
2 - SUSPECTED SERIOUS INJURY	2 - DEPLOYED FRONT	2 - DEPLOYED FRONT	2 - CLASS B	2 - CDL INTRASTATE ONLY	2 - MANUALLY OPERATING AN ELECTRONIC COMMUNICATION DEVICE (TEXTING, TYPING, DIALING)	2 - TEST REFUSED
3 - SUSPECTED MINOR INJURY	3 - FRONT - MIDDLE	3 - DEPLOYED SIDE	3 - CLASS C	3 - CORRECTIVE LENSES	3 - TALKING ON HANDS-FREE COMMUNICATION DEVICE	3 - TEST GIVEN, CONTAMINATED SAMPLE / UNUSABLE
4 - POSSIBLE INJURY	4 - FRONT - RIGHT SIDE	4 - DEPLOYED BOTH FRONT / SIDE	4 - REGULAR CLASS (OHIO = D)	4 - FARM WAIVER	4 - TALKING ON HAND-HELD COMMUNICATION DEVICE	4 - TEST GIVEN, RESULTS KNOWN
5 - NO APPARENT INJURY	5 - SECOND - LEFT SIDE (MOTORCYCLE PASSENGER)	5 - NOT APPLICABLE	5 - MC MOPED ONLY	5 - EXCEPT CLASS A BUS & CLASS B BUS	5 - OTHER ACTIVITY WITH AN ELECTRONIC DEVICE	5 - TEST GIVEN, RESULTS UNKNOWN
<b>INJURED TAKEN BY</b>	6 - SECOND - MIDDLE	9 - DEPLOYMENT UNKNOWN	6 - NO VALID OL	7 - EXCEPT TRACTOR-TRAILER	6 - PASSENGER	<b>ALCOHOL TEST TYPE</b>
1 - NOT TRANSPORTED / TREATED AT SCENE	7 - THIRD - LEFT SIDE (MOTORCYCLE SIDE CAR)	<b>EJECTION</b>	<b>OL ENDORSEMENT</b>	8 - INTERMEDIATE LICENSE RESTRICTIONS	7 - OTHER DISTRACTION INSIDE THE VEHICLE	1 - NONE
2 - EMS	8 - THIRD - MIDDLE	1 - NOT EJECTED	H - HAZMAT	9 - LEARNER'S PERMIT RESTRICTIONS	8 - OTHER DISTRACTION OUTSIDE THE VEHICLE	2 - BLOOD
3 - POLICE	9 - THIRD - RIGHT SIDE	2 - PARTIALLY EJECTED	M - MOTORCYCLE	10 - LIMITED TO DAYLIGHT ONLY	9 - OTHER / UNKNOWN	3 - URINE
9 - OTHER / UNKNOWN	10 - SLEEPER SECTION OF TRUCK CAB	3 - TOTALLY EJECTED	P - PASSENGER	11 - LIMITED TO EMPLOYMENT	<b>CONDITION</b>	4 - BREATH
<b>SAFETY EQUIPMENT</b>	11 - PASSENGER IN OTHER ENCLOSED CARGO AREA (NON-TRAILING UNIT, BUS, PICK UP WITH CAP)	4 - NOT APPLICABLE	N - TANKER	12 - LIMITED - OTHER	1 - APPARENTLY NORMAL	5 - OTHER
1 - NONE USED	12 - PASSENGER IN UNENCLOSED CARGO AREA	<b>TRAPPED</b>	Q - MOTOR SCOOTER	13 - MECHANICAL DEVICES (SPECIAL BRAKES, HAND CONTROLS, OR OTHER ADAPTIVE DEVICES)	2 - PHYSICAL IMPAIRMENT	<b>DRUG TEST TYPE</b>
2 - SHOULDER BELT ONLY USED	13 - TRAILING UNIT	1 - NOT TRAPPED	R - THREE WHEEL MOTORCYCLE	14 - MILITARY VEHICLES ONLY	3 - EMOTIONAL (E.G. DEPRESSED, ANGRY, DIST. JGED)	1 - NONE
3 - LAP BELT ONLY USED	14 - RIDING ON VEHICLE EXTERIOR (NON-TRAILING UNIT)	2 - EXTRICATED BY MECHANICAL MEANS	S - SCHOOL BUS	15 - MOTOR VEHICLES WITHOUT AIR BRAKES	4 - ILLNESS	2 - BLOOD
4 - SHOULDER & LAP BELT USED	99 - OTHER / UNKNOWN	3 - FREED BY NON-MECHANICAL MEANS	T - DOUBLE & TRIPLE TRAILERS	16 - OUTSIDE MIRROR	5 - FELL ASLEEP, FAINTED, FATIGUED, ETC.	3 - URINE
5 - CHILD RESTRAINT SYSTEM - FORWARD FACING			X - TANKER / HAZMAT	17 - PROSTHETIC AID	6 - UNDER THE INFLUENCE OF MEDICATIONS / DRUGS / ALCOHOL	4 - OTHER
6 - CHILD RESTRAINT SYSTEM - REAR FACING			<b>GENDER</b>	18 - OTHER	9 - OTHER / UNKNOWN	<b>DRUG TEST RESULT(S)</b>
7 - BOOSTER SEAT			F - FEMALE			1 - AMPHETAMINES
8 - HELMET USED			M - MALE			2 - BARBITURATES
9 - PROTECTIVE PADS USED (ELBOW, KNEES, ETC.)			U - OTHER / UNKNOWN			3 - BENZODIAZEPINES
10 - REFLECTIVE CLOTHING						4 - CANNABINOIDS
11 - LIGHTING - PEDESTRIAN / BICYCLE ONLY						5 - COCAINE
99 - OTHER / UNKNOWN						6 - OPIATES / OPIOIDS
						7 - OTHER
						8 - NEGATIVE RESULTS