

**TRAFFIC CRASH REPORT**

\*DENOTES MANDATORY FIELD FOR SUPPLEMENT REPORT

LOCAL REPORT NUMBER\*

<input type="checkbox"/> PHOTOS TAKEN <input type="checkbox"/> SECONDARY CRASH		<input type="checkbox"/> OH-2 <input type="checkbox"/> OH-1P <input type="checkbox"/> PRIVATE PROPERTY	<input type="checkbox"/> OH-3 <input type="checkbox"/> OTHER	LOCAL INFORMATION REPORTING AGENCY NAME* <b>City of Kent Police</b>	NCIC* 0 6 7 0 3	2 0 2 2 - 0 0 0 0 2 1 9 1		
---	--	--	---	---	--------------------	---------------------------	--	--

COUNTY* 6 7	LOCALITY* 1-CITY 2-VILLAGE 3-TOWNSHIP 1	LOCATION: CITY, VILLAGE, TOWNSHIP* <b>Kent</b>	CRASH DATE / TIME* 0 2 1 4 2 0 2 2 / 1 2 2 8	CRASH SEVERITY 1-FATAL 2-SERIOUS INJURY SUSPECTED 3-MINOR INJURY SUSPECTED 4-INJURY POSSIBLE 5-PROPERTY DAMAGE ONLY <b>5</b>
----------------	---	---	---	--

ROUTE TYPE <b>S R</b>	ROUTE NUMBER 5 9	PREFIX 2	LOCATION ROAD NAME <b>LINCOLN</b>	ROAD TYPE <b>S T</b>	LATITUDE DECIMAL DEGREES 4 1 1 1 5 3 7 5 1
--------------------------	---------------------	-------------	--------------------------------------	-------------------------	---

ROUTE TYPE <b>S R</b>	ROUTE NUMBER 5 9	PREFIX 2	REFERENCE ROAD NAME (ROAD, MILEPOST, HOUSE #)	ROAD TYPE	LONGITUDE DECIMAL DEGREES 8 1 3 4 9 7 5 5
--------------------------	---------------------	-------------	---	-----------	--

REFERENCE POINT 1- INTERSECTION 2- MILE POST 3- HOUSE # <b>1</b>	DIRECTION FROM REFERENCE N - NORTH S - SOUTH E - EAST W - WEST <b>2</b>	ROUTE TYPE IR - INTERSTATE ROUTE(TP) US - FEDERAL US ROUTE SR - STATE ROUTE CR - NUMBERED COUNTY ROUTE TR - NUMBERED TOWNSHIP ROUTE	ROAD TYPE AL - ALLEY AV - AVENUE BL - BOULEVARD CR - CIRCLE CT - COURT DR - DRIVE HE - HEIGHTS	ROAD TYPE HW - HIGHWAY LA - LANE MP - MILEPOST OV - OVAL PK - PARKWAY PI - PIKE PL - PLACE	RD - ROAD SQ - SQUARE ST - STREET TE - TERRACE TL - TRAIL WA - WAY	INTERSECTION RELATED <input checked="" type="checkbox"/> WITHIN INTERSECTION OR ON APPROACH <input type="checkbox"/> WITHIN INTERCHANGE AREA NUMBER OF APPROACHES <b>4</b>
--	--	--	---	---	---	--

DISTANCE FROM REFERENCE <b>5 0</b>	DISTANCE UNIT OF MEASURE 1 - MILES 2 - FEET 3 - YARDS <b>2</b>	ROADWAY <input type="checkbox"/> ROADWAY DIVIDED
---------------------------------------	--	---

LOCATION OF FIRST HARMFUL EVENT 1 - ON ROADWAY 2 - ON SHOULDER 3 - IN MEDIAN 4 - ON ROADSIDE 5 - ON GORE 6 - OUTSIDE TRAFFIC WAY 7 - ON RAMP 8 - OFF RAMP <b>0 1</b>	9 - CROSSOVER 10 - DRIVEWAY/ALLEY ACCESS 11 - RAILWAY GRADE CROSSING 12 - SHARED USE PATHS OR TRAILS 13 - BIKE LANE 14 - TOLL BOOTH 99 - OTHER / UNKNOWN <b>2</b>	MANNER OF CRASH COLLISION/IMPACT 1 - NOT COLLISION BETWEEN TWO MOTOR VEHICLES IN TRANSPORT 2 - REAR-END 3 - HEAD-ON 4 - REAR-TO-REAR 5 - BACKING 6 - ANGLE 7 - SIDESWIPE, SAME DIRECTION 8 - SIDESWIPE, OPPOSITE DIRECTION 9 - OTHER / UNKNOWN	DIRECTION OF TRAVEL N - NORTH S - SOUTH E - EAST W - WEST	MEDIAN TYPE 1 - DIVIDED FLUSH MEDIAN (<4 FEET) 2 - DIVIDED FLUSH MEDIAN (≥4 FEET) 3 - DIVIDED, DEPRESSED MEDIAN 4 - DIVIDED, RAISED MEDIAN (ANY TYPE) 9 - OTHER/UNKNOWN
---	--	---	---	--

<input type="checkbox"/> WORK ZONE RELATED <input type="checkbox"/> WORKERS PRESENT <input type="checkbox"/> LAW ENFORCEMENT PRESENT <input type="checkbox"/> ACTIVE SCHOOL ZONE	WORK ZONE TYPE 1 - LANE CLOSURE 2 - LANE SHIFT/CROSSOVER 3 - WORK ON SHOULDER OR MEDIAN 4 - INTERMITTENT OR MOVING WORK 5 - OTHER	LOCATION OF CRASH IN WORK ZONE 1 - BEFORE THE 1ST WORK ZONE WARNING SIGN 2 - ADVANCE WARNING AREA 3 - TRANSITION AREA 4 - ACTIVITY AREA 5 - TERMINATION AREA	CONTOUR <b>1</b> 1 - STRAIGHT LEVEL 2 - STRAIGHT GRADE 3 - CURVE LEVEL 4 - CURVE GRADE 9 - OTHER/UNKNOWN	CONDITIONS <b>1</b> 1 - DRY 2 - WET 3 - SNOW 4 - ICE 5 - SAND, MUD, DIRT, OIL, GRAVEL 6 - WATER (STANDING, MOVING) 7 - SLUSH 9 - OTHER/UNKNOWN	SURFACE <b>2</b> 1 - CONCRETE 2 - BLACKTOP, BITUMINOUS, ASPHALT 3 - BRICK/BLOCK 4 - SLAG, GRAVEL, STONE 5 - DIRT 9 - OTHER/UNKNOWN
---	--	---	--	---	---

LIGHT CONDITION 1 - DAYLIGHT 2 - DAWN/DUSK 3 - DARK - LIGHTED ROADWAY 4 - DARK - ROADWAY NOT LIGHTED 5 - DARK - UNKNOWN ROADWAY LIGHTING 9 - OTHER / UNKNOWN <b>1</b>	WEATHER 1 - CLEAR 2 - CLOUDY 3 - FOG, SMOG, SMOKE 4 - RAIN 5 - SLEET, HAIL 6 - SNOW 7 - SEVERE CROSSWINDS 8 - BLOWING SAND, SOIL, DIRT, SNOW 9 - FREEZING RAIN OR FREEZING DRIZZLE 99 - OTHER / UNKNOWN <b>0 2</b>
--	---

NARRATIVE

**Unit 1 was stopped northbound on S Lincoln St for the red light at E Main St. Unit 2 was northbound on S Lincoln St and failed to stop in time. Unit 2 struck Unit 1 in the rear. Unit 2 then left the scene.**

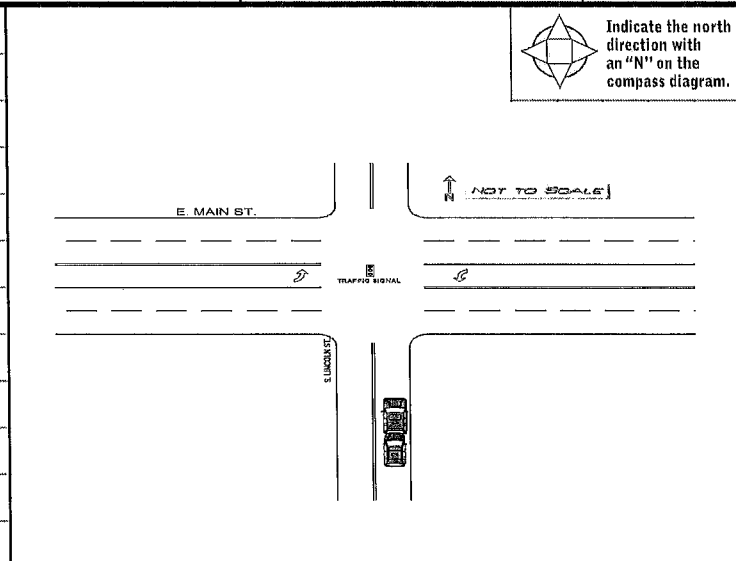

CRASH REPORTED DATE / TIME 0 2 1 4 2 0 2 2 / 1 2 2 8	DISPATCH DATE / TIME 0 2 1 4 2 0 2 2 / 1 2 3 0	ARRIVAL DATE / TIME 0 2 1 4 2 0 2 2 / 1 2 3 5	SCENE CLEARED DATE / TIME 0 2 1 4 2 0 2 2 / 1 2 4 8	REPORT TAKEN BY <input checked="" type="checkbox"/> POLICE AGENCY <input type="checkbox"/> MOTORIST
TOTAL TIME ROADWAY CLOSED 0 0 0	OTHER INVESTIGATION TIME 0 6 0	TOTAL MINUTES 0 7 8	OFFICER'S NAME* <b>Darrah, Benjamin</b>	CHECKED BY OFFICER'S NAME* <b>Wheeler, George</b>
			OFFICER'S BADGE NUMBER* 2 2 6	CHECKED BY OFFICER'S BADGE NUMBER* 2 4 3

**OWNER**

UNIT # **0 1** OWNER NAME: LAST, FIRST, MIDDLE (X) SAME AS DRIVER  
**STEWART, KATELYNN, ELIZABETH**

OWNER ADDRESS: STREET, CITY, STATE, ZIP (X) SAME AS DRIVER  
**3379 RHAPSODY, CLINTON, OH 44216**

COMMERCIAL CARRIER: NAME, ADDRESS, CITY, STATE, ZIP

COMMERCIAL CARRIER PHONE: INCLUDE AREA CODE

**DAMAGE**

**DAMAGE SCALE**

**2** 1 - NONE 3 - FUNCTIONAL DAMAGE  
 2 - MINOR DAMAGE 4 - DISABLING DAMAGE  
 9 - UNKNOWN

**VEHICLE**

LP STATE **OH** LICENSE PLATE # **HXM4065** VEHICLE IDENTIFICATION # **2 H K Y F 1 8 4 9 3 H 5 8 7 0 1 4** VEHICLE YEAR **2 0 0 3** VEHICLE MAKE **Honda**

INSURANCE VERIFIED INSURANCE COMPANY **ALLSTATE** INSURANCE POLICY # **992963152** COLOR **SIL** VEHICLE MODEL **PILOT**

COMMERCIAL TYPE OF USE  GOVERNMENT  IN EMERGENCY RESPONSE US DOT # TOWED BY: COMPANY NAME

INTERLOCK DEVICE EQUIPPED  HIT/SKIP UNIT #OCCUPANTS **0 1** VEHICLE WEIGHT GVWR/GCWR  
 1 - <10K LBS.  
 2 - 10,001 - 26K LBS.  
 3 - >26K LBS.

HAZARDOUS MATERIAL MATERIAL RELEASED CLASS # PLACARD ID #

UNIT TYPE  
 1 - PASSENGER CAR 7 - MOTORCYCLE 2-WHEELED 12 - GOLF CART 18 - LIMO (LIVERY VEHICLE) 23 - PEDESTRIAN / SKATER  
 2 - PASSENGER VAN (MINIVAN) 8 - MOTORCYCLE 3-WHEELED 13 - SNOWMOBILE 19 - BUS (16+ PASSENGERS) 24 - WHEELCHAIR (ANY TYPE)  
 3 - SPORT UTILITY VEHICLE 9 - AUTOCYCLE 14 - SINGLE UNIT TRUCK 20 - OTHER VEHICLE 25 - OTHER NON-MOTORIST  
 4 - PICK UP 10 - MOPED OR MOTORIZED BICYCLE 15 - SEMI-TRACTOR 21 - HEAVY EQUIPMENT 26 - BICYCLE  
 5 - CARGO VAN 11 - ALL TERRAIN VEHICLE (ATV/UTV) 16 - FARM EQUIPMENT 22 - ANIMAL WITH RIDER OR ANIMAL-DRAWN VEHICLE 27 - TRAIN  
 6 - VAN (9-15 SEATS) 17 - MOTORHOME

# OF TRAILING UNITS

WAS VEHICLE OPERATING IN AUTONOMOUS MODE WHEN CRASH OCCURRED? **2** 0 - NO AUTOMATION 3 - CONDITIONAL AUTOMATION 9 - UNKNOWN  
 1 - YES 2 - NO 9 - OTHER / UNKNOWN 1 - DRIVER ASSISTANCE 4 - HIGH AUTOMATION 5 - FULL AUTOMATION 2 - PARTIAL AUTOMATION

SPECIAL FUNCTION  
 1 - NONE 6 - BUS - CHARTER/TOUR 11 - FIRE 16 - FARM 21 - MAIL CARRIER  
 2 - TAXI 7 - BUS - INTERCITY 12 - MILITARY 17 - MOWING 18 - OTHER / UNKNOWN  
 3 - ELECTRONIC RIDE SHARING 8 - BUS - SHUTTLE 13 - POLICE 19 - SNOW REMOVAL  
 4 - SCHOOL TRANSPORT 9 - BUS - OTHER 14 - PUBLIC UTILITY 20 - TOWING  
 5 - BUS - TRANSIT/COMMUTER 10 - AMBULANCE 15 - CONSTRUCTION EQUIPMENT 20 - SAFETY SERVICE PATROL

CARGO BODY TYPE  
 1 - NO CARGO BODY TYPE / NOT APPLICABLE 3 - VEHICLE TOWING ANOTHER MOTOR VEHICLE 5 - INTERMODAL CONTAINER CHASSIS 8 - POLE 12 - CONCRETE MIXER  
 2 - BUS 4 - LOGGING 6 - CARGO VAN/ENCLOSED BOX 9 - CARGO TANK 13 - AUTO TRANSPORTER  
 7 - GRAIN/CHIPS/GRAVEL 11 - DUMP 14 - GARBAGE/REFUSE 99 - OTHER / UNKNOWN

VEHICLE DEFECTS  
 1 - TURN SIGNALS 4 - BRAKES 7 - WORN OR SLICK TIRES 9 - MOTOR TROUBLE 99 - OTHER / UNKNOWN  
 2 - HEAD LAMPS 5 - STEERING 8 - TRAILER EQUIPMENT DEFECTIVE 10 - DISABLED FROM PRIOR ACCIDENT  
 3 - TAIL LAMPS 6 - TIRE BLOWOUT

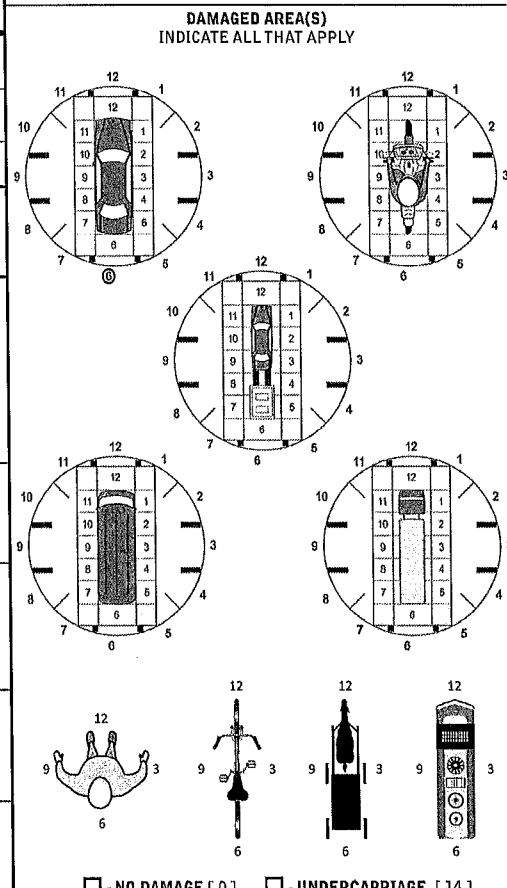

**EVENT(S)**

NON-MOTORIST LOCATION AT IMPACT  
 1 - INTERSECTION - MARKED CROSSWALK 3 - INTERSECTION - OTHER 6 - BICYCLE LANE 9 - MEDIUM CROSSING ISLAND 12 - FIRST RESPONDER AT INCIDENT SCENE  
 2 - INTERSECTION - UNMARKED CROSSWALK 4 - MIDBLOCK - MARKED CROSSWALK 7 - SHOULDER / ROADSIDE 10 - DRIVEWAY ACCESS 14 - GARBAGE/REFUSE  
 8 - SIDEWALK 5 - TRAVEL LANE - OTHER LOCATION 11 - SHARED USE PATHS OR TRAILS 99 - OTHER / UNKNOWN

ACTION  
**4** 1 - NON-CONTACT 1 - STRAIGHT AHEAD 7 - MAKING U-TURN 13 - NEGOTIATING A CURVE 18 - APPROACHING OR LEAVING VEHICLE  
 2 - NON-COLLISION 2 - BACKING 8 - ENTERING TRAFFIC LANE 14 - ENTERING OR CROSSING SPECIFIED LOCATION 19 - STANDING  
 3 - STRIKING **1 1** 3 - CHANGING LANES 9 - LEAVING TRAFFIC LANE 15 - WALKING, RUNNING, JOGGING, PLAYING 20 - OTHER NON-MOTORIST  
 4 - STRUCK PRE-CRASH ACTIONS 4 - OVERTAKING/PASSING 10 - PARKED 11 - SLOWING OR STOPPED IN TRAFFIC 16 - WORKING 21 - STANDING OUTSIDE DISABLED VEHICLE  
 5 - BOTH STRIKING & STRUCK 5 - MAKING RIGHT TURN 11 - SLOWING OR STOPPED IN TRAFFIC 16 - WORKING 21 - STANDING OUTSIDE DISABLED VEHICLE  
 6 - MAKING LEFT TURN 12 - DRIVERLESS 17 - PUSHING VEHICLE 99 - OTHER / UNKNOWN  
 9 - OTHER / UNKNOWN

CONTRIBUTING CIRCUMSTANCES  
**0 1** 1 - NONE 7 - LEFT OF CENTER 13 - IMPROPER START FROM A PARKED POSITION 17 - VISION OBSTRUCTION 21 - LYING IN ROADWAY  
 2 - FAILURE TO YIELD 8 - FOLLOWING TOO CLOSE / ACDA 14 - STOPPED OR PARKED ILLEGALLY 18 - OPERATING DEFECTIVE EQUIPMENT 22 - NOT DISCERNIBLE  
 3 - RAN RED LIGHT 9 - IMPROPER LANE CHANGE 15 - SWERVING TO AVOID 19 - LOAD SHIFTING/FALLING/SPILLING 23 - OPENING DOOR INTO ROADWAY  
 4 - RAN STOP SIGN 10 - IMPROPER PASSING 16 - WRONG WAY 20 - IMPROPER CROSSING 99 - OTHER IMPROPER ACTION  
 5 - UNSAFE SPEED 11 - DROVE OFF ROAD 12 - IMPROPER BACKING

SEQUENCE OF EVENTS  
 1 **2 0** 1 - OVERTURN/ROLLOVER 6 - EQUIPMENT FAILURE 11 - CROSS CENTERLINE - OPPOSITE DIRECTION OF TRAVEL 16 - RAILWAY VEHICLE 22 - WORK ZONE MAINTENANCE EQUIPMENT  
 2 - FIRE/EXPLOSION 7 - SEPARATION OF UNITS 12 - DOWNHILL RUNAWAY 17 - ANIMAL - FARM 23 - STRUCK BY FALLING, SHIFTING CARGO OR ANYTHING SET IN MOTION BY A MOTOR VEHICLE  
 3 - IMMERSION 8 - RAN OFF ROAD RIGHT 13 - OTHER NON-COLLISION 18 - ANIMAL - DEER 20 - MOTOR VEHICLE IN TRANSPORT 24 - OTHER MOVABLE OBJECT  
 4 - JACKKNIFE 9 - RAN OFF ROAD LEFT 14 - PEDESTRIAN 19 - ANIMAL - OTHER 21 - PARKED MOTOR VEHICLE  
 5 - CARGO / EQUIPMENT LOSS OR SHIFT 10 - CROSS MEDIAN 15 - PEDALCYCLE

**COLLISION WITH FIXED OBJECT - STRUCK**

25 - IMPACT ATTENUATOR / CRASH CUSHION 31 - GUARDRAIL END 37 - TRAFFIC SIGN POST 43 - CURB 50 - WORK ZONE MAINTENANCE EQUIPMENT  
 26 - BRIDGE OVERHEAD STRUCTURE 32 - PORTABLE BARRIER 38 - OVERHEAD SIGN POST 44 - DITCH 51 - WALL  
 27 - BRIDGE PIER OR ABUTMENT 33 - MEDIAN CABLE BARRIER 39 - LIGHT / LUMINARIES SUPPORT 45 - EMBANKMENT 52 - BUILDING  
 28 - BRIDGE PARAPET 34 - MEDIAN GUARDRAIL BARRIER 40 - UTILITY POLE 46 - FENCE 53 - TUNNEL  
 29 - BRIDGE RAIL 35 - MEDIAN CONCRETE BARRIER 41 - OTHER POST, POLE OR SUPPORT 47 - MAILBOX 54 - OTHER FIXED OBJECT  
 30 - GUARDRAIL FACE 36 - MEDIAN OTHER BARRIER 42 - CULVERT 48 - TREE 99 - OTHER / UNKNOWN  
 49 - FIRE HYDRANT

**1** FIRST HARMFUL EVENT **1** MOST HARMFUL EVENT

**INITIAL POINT OF CONTACT**  
 0 - NO DAMAGE 14 - UNDERCARRIAGE  
**0 6** 1-12 - REFER TO UNIT DIAGRAM 15 - VEHICLE NOT AT SCENE  
 13 - TOP 99 - UNKNOWN

**TRAFFIC**

TRAFFICWAY FLOW  
**2** 1 - ONE-WAY  
 2 - TWO-WAY

TRAFFIC CONTROL  
**2** 1 - ROUNDABOUT 4 - STOP SIGN  
 2 - SIGNAL 5 - YIELD SIGN  
 3 - FLASHER 6 - NO CONTROL

# OF THROUGH LANES ON ROAD  
**2**

RAIL GRADE CROSSING  
**1** 1 - NOT INVOLVED  
 2 - INVOLVED-ACTIVE CROSSING  
 3 - INVOLVED-PASSIVE CROSSING

**UNIT / NON-MOTORIST DIRECTION**  
 FROM **2** TO **1**  
 1 - NORTH 5 - NORTHEAST  
 2 - SOUTH 6 - NORTHWEST  
 3 - EAST 7 - SOUTHEAST  
 4 - WEST 8 - SOUTHWEST  
 9 - OTHER / UNKNOWN

UNIT SPEED  
**0 0 0**

DETECTED SPEED  
**1** 1 - STATED / ESTIMATED SPEED  
 2 - CALCULATED / EDR  
 3 - UNDETERMINED

POSTED SPEED  
**2 5**

<b>OWNER</b>	UNIT # <b>0 2</b>	OWNER NAME: LAST, FIRST, MIDDLE (X SAME AS DRIVER)	OWNER PHONE: INCLUDE AREA CODE ( ) SAME AS DRIVER			
	OWNER ADDRESS: STREET, CITY, STATE, ZIP ( ) SAME AS DRIVER					
	COMMERCIAL CARRIER: NAME, ADDRESS, CITY, STATE, ZIP		COMMERCIAL CARRIER PHONE: INCLUDE AREA CODE			
<b>VEHICLE</b>	LP STATE	LICENSE PLATE #	VEHICLE IDENTIFICATION #	VEHICLE YEAR	VEHICLE MAKE <b>Honda</b>	
	<input type="checkbox"/> INSURANCE VERIFIED	INSURANCE COMPANY	INSURANCE POLICY #	COLOR BGE	VEHICLE MODEL <b>ODYSSEY</b>	
	<input type="checkbox"/> COMMERCIAL	TYPE OF USE <input type="checkbox"/> GOVERNMENT <input type="checkbox"/> IN EMERGENCY RESPONSE	US DOT #	TOWED BY: COMPANY NAME		
	<input type="checkbox"/> INTERLOCK DEVICE EQUIPPED	<input checked="" type="checkbox"/> HIT/SKIP UNIT	#OCCUPANTS <b>0 1</b>	HAZARDOUS MATERIAL <input type="checkbox"/> MATERIAL RELEASED <input type="checkbox"/> PLACARD		
	UNIT TYPE <b>0 2</b>		VEHICLE WEIGHT GVWR/GCWR 1 - ≤10K LBS. 2 - 10,001 - 26K LBS. 3 - >26K LBS.	CLASS # PLACARD ID #		
	1 - PASSENGER CAR 2 - PASSENGER VAN (MINIVAN) 3 - SPORT UTILITY VEHICLE 4 - PICK UP 5 - CARGO VAN 6 - VAN (9-15 SEATS)		7 - MOTORCYCLE 2-WHEELED 8 - MOTORCYCLE 3-WHEELED 9 - AUTOCYCLE 10 - MOPED OR MOTORIZED BICYCLE 11 - ALL TERRAIN VEHICLE (ATV / UTV)	12 - GOLF CART 13 - SNOWMOBILE 14 - SINGLE UNIT TRUCK 15 - SEMI-TRACTOR 16 - FARM EQUIPMENT 17 - MOTORHOME	18 - LIMO (LIVERY VEHICLE) 19 - BUS (16+ PASSENGERS) 20 - OTHER VEHICLE 21 - HEAVY EQUIPMENT 22 - ANIMAL WITH RIDER OR ANIMAL-DRAWN VEHICLE	23 - PEDESTRIAN / SKATER 24 - WHEELCHAIR (ANY TYPE) 25 - OTHER NON-MOTORIST 26 - BICYCLE 27 - TRAIN 99 - UNKNOWN OR HIT/SKIP
	# OF TRAILING UNITS		WAS VEHICLE OPERATING IN AUTONOMOUS MODE WHEN CRASH OCCURRED? <b>2</b> 1-YES 2-NO 9-OTHER / UNKNOWN			
	AUTONOMOUS MODE LEVEL <b>0</b>		0 - NO AUTOMATION 1 - DRIVER ASSISTANCE 2 - PARTIAL AUTOMATION 3 - CONDITIONAL AUTOMATION 4 - HIGH AUTOMATION 5 - FULL AUTOMATION 9 - UNKNOWN			
	SPECIAL FUNCTION <b>9 9</b>		1 - NONE 2 - TAXI 3 - ELECTRONIC RIDE SHARING 4 - SCHOOL TRANSPORT 5 - BUS - TRANSIT/COMMUTER 6 - BUS - CHARTER/TOUR 7 - BUS - INTERCITY 8 - BUS - SHUTTLE 9 - BUS - OTHER 10 - AMBULANCE 11 - FIRE 12 - MILITARY 13 - POLICE 14 - PUBLIC UTILITY 15 - CONSTRUCTION EQUIPMENT 16 - FARM 17 - MOWING 18 - SNOW REMOVAL 19 - TOWING 20 - SAFETY SERVICE PATROL 21 - MAIL CARRIER 99 - OTHER / UNKNOWN			
	CARGO BODY TYPE <b>0 1</b>		1 - NO CARGO BODY TYPE /NOT APPLICABLE 2 - BUS 3 - VEHICLE TOWING ANOTHER MOTOR VEHICLE 4 - LOGGING 5 - INTERMODAL CONTAINER CHASSIS 6 - CARGO VAN/ENCLOSED BOX 7 - GRAIN/CHIPS/GRAVEL 8 - POLE 9 - CARGO TANK 10 - FLAT BED 11 - DUMP 12 - CONCRETE MIXER 13 - AUTO TRANSPORTER 14 - GARBAGE/REFUSE 99 - OTHER / UNKNOWN			
VEHICLE DEFECTS		1 - TURN SIGNALS 2 - HEAD LAMPS 3 - TAIL LAMPS 4 - BRAKES 5 - STEERING 6 - TIRE BLOWOUT 7 - WORN OR SLICK TIRES 8 - TRAILER EQUIPMENT DEFECTIVE 9 - MOTOR TROUBLE 10 - DISABLED FROM PRIOR ACCIDENT 99 - OTHER / UNKNOWN				
NON-MOTORIST LOCATION AT IMPACT		1 - INTERSECTION - MARKED CROSSWALK 2 - INTERSECTION - UNMARKED CROSSWALK 3 - INTERSECTION - OTHER 4 - MIDBLOCK - MARKED CROSSWALK 5 - TRAVEL LANE - OTHER LOCATION 6 - BICYCLE LANE 7 - SHOULDER / ROADSIDE 8 - SIDEWALK 9 - MEDIAN/CROSSING ISLAND 10 - DRIVEWAY ACCESS 11 - SHARED USE PATHS OR TRAILS 12 - FIRST RESPONDER AT INCIDENT SCENE 99 - OTHER / UNKNOWN				
ACTION <b>4</b>		1 - NON-CONTACT 2 - NON-COLLISION 3 - STRIKING 4 - STRUCK 5 - BOTH STRIKING & STRUCK 9 - OTHER / UNKNOWN 1 - STRAIGHT AHEAD 2 - BACKING 3 - CHANGING LANES 4 - OVERTAKING/PASSING 5 - MAKING RIGHT TURN 6 - MAKING LEFT TURN 7 - MAKING U-TURN 8 - ENTERING TRAFFIC LANE 9 - LEAVING TRAFFIC LANE 10 - PARKED 11 - SLOWING OR STOPPED IN TRAFFIC 12 - DRIVERLESS 13 - NEGOTIATING A CURVE 14 - ENTERING OR CROSSING SPECIFIED LOCATION 15 - WALKING, RUNNING, JOGGING, PLAYING 16 - WORKING 17 - PUSHING VEHICLE 18 - APPROACHING OR LEAVING VEHICLE 19 - STANDING 20 - OTHER NON-MOTORIST 21 - STANDING OUTSIDE DISABLED VEHICLE 99 - OTHER / UNKNOWN				
CONTRIBUTING CIRCUMSTANCES <b>0 8</b>		1 - NONE 2 - FAILURE TO YIELD 3 - RAN RED LIGHT 4 - RAN STOP SIGN 5 - UNSAFE SPEED 6 - IMPROPER TURN 7 - LEFT OF CENTER 8 - FOLLOWING TOO CLOSE / ACDA 9 - IMPROPER LANE CHANGE 10 - IMPROPER PASSING 11 - DROVE OFF ROAD 12 - IMPROPER BACKING 13 - IMPROPER START FROM A PARKED POSITION 14 - STOPPED OR PARKED ILLEGALLY 15 - SWERVING TO AVOID 16 - WRONG WAY 17 - VISION OBSTRUCTION 18 - OPERATING DEFECTIVE EQUIPMENT 19 - LOAD SHIFTING/FALLING/ SPILLING 20 - IMPROPER CROSSING 21 - LYING IN ROADWAY 22 - NOT DISCERNIBLE 23 - OPENING DOOR INTO ROADWAY 99 - OTHER IMPROPER ACTION				
<b>EVENT(S)</b>	SEQUENCE OF EVENTS		NON-COLLISION			
	1 <b>2 0</b>		11 - CROSS CENTERLINE - OPPOSITE DIRECTION OF TRAVEL 12 - DOWNHILL RUNAWAY 13 - OTHER NON-COLLISION 14 - PEDESTRIAN 15 - PEDALCYCLE 16 - RAILWAY VEHICLE 17 - ANIMAL - FARM 18 - ANIMAL - DEER 19 - ANIMAL - OTHER 20 - MOTOR VEHICLE IN TRANSPORT 21 - PARKED MOTOR VEHICLE 22 - WORK ZONE MAINTENANCE EQUIPMENT 23 - STRUCK BY FALLING, SHIFTING CARGO OR ANYTHING SET IN MOTION BY A MOTOR VEHICLE 24 - OTHER MOVABLE OBJECT			
	2		COLLISION WITH FIXED OBJECT - STRUCK			
	3		31 - GUARDRAIL END 32 - PORTABLE BARRIER 33 - MEDIAN CABLE BARRIER 34 - MEDIAN GUARDRAIL BARRIER 35 - MEDIAN CONCRETE BARRIER 36 - MEDIAN OTHER BARRIER 37 - TRAFFIC SIGN POST 38 - OVERHEAD SIGN POST 39 - LIGHT / LUMINARIES SUPPORT 40 - UTILITY POLE 41 - OTHER POST, POLE OR SUPPORT 42 - CULVERT 43 - CURB 44 - DITCH 45 - EMBANKMENT 46 - FENCE 47 - MAILBOX 48 - TREE 49 - FIRE HYDRANT 50 - WORK ZONE MAINTENANCE EQUIPMENT 51 - WALL 52 - BUILDING 53 - TUNNEL 54 - OTHER FIXED OBJECT 99 - OTHER / UNKNOWN			
	4		50 - WORK ZONE MAINTENANCE EQUIPMENT 51 - WALL 52 - BUILDING 53 - TUNNEL 54 - OTHER FIXED OBJECT 99 - OTHER / UNKNOWN			
5		50 - WORK ZONE MAINTENANCE EQUIPMENT 51 - WALL 52 - BUILDING 53 - TUNNEL 54 - OTHER FIXED OBJECT 99 - OTHER / UNKNOWN				
6		50 - WORK ZONE MAINTENANCE EQUIPMENT 51 - WALL 52 - BUILDING 53 - TUNNEL 54 - OTHER FIXED OBJECT 99 - OTHER / UNKNOWN				
1		50 - WORK ZONE MAINTENANCE EQUIPMENT 51 - WALL 52 - BUILDING 53 - TUNNEL 54 - OTHER FIXED OBJECT 99 - OTHER / UNKNOWN				
FIRST HARMFUL EVENT		MOST HARMFUL EVENT				

<b>DAMAGE</b>	
<b>DAMAGE SCALE</b>	
<b>2</b>	1 - NONE 2 - MINOR DAMAGE 3 - FUNCTIONAL DAMAGE 4 - DISABLING DAMAGE 9 - UNKNOWN
<b>DAMAGED AREA(S)</b> INDICATE ALL THAT APPLY	
<input type="checkbox"/> - NO DAMAGE [ 0 ] <input type="checkbox"/> - UNDERCARRIAGE [ 14 ] <input type="checkbox"/> - TOP [ 13 ] <input type="checkbox"/> - ALL AREAS [ 15 ] <input type="checkbox"/> - UNIT NOT AT SCENE [ 16 ]	
<b>INITIAL POINT OF CONTACT</b>	
0 - NO DAMAGE    14 - UNDERCARRIAGE 1-12 - REFER TO UNIT DIAGRAM    15 - VEHICLE NOT AT SCENE 13 - TOP    99 - UNKNOWN	
<b>TRAFFIC</b>	
<b>TRAFFICWAY FLOW</b> 1 - ONE-WAY <b>2</b> 2 - TWO-WAY	<b>TRAFFIC CONTROL</b> 1 - ROUNDABOUT    4 - STOP SIGN 2 - SIGNAL    5 - YIELD SIGN 3 - FLASHER    6 - NO CONTROL
<b># OF THROUGH LANES ON ROAD</b> <b>2</b>	<b>RAIL GRADE CROSSING</b> 1 - NOT INVOLVED 2 - INVOLVED-ACTIVE CROSSING 3 - INVOLVED-PASSIVE CROSSING
<b>UNIT / NON-MOTORIST DIRECTION</b>	
FROM <b>2</b> TO <b>1</b>	
<b>UNIT SPEED</b> _____	<b>DETECTED SPEED</b> 1 - STATED / ESTIMATED SPEED 2 - CALCULATED / EDR 3 - UNDETERMINED
<b>POSTED SPEED</b> _____	



# MOTORIST / Non-MOTORIST

LOCAL REPORT NUMBER  
2,0,2,2,-0,0,0,0,2,1,9,1

<b>UNIT #</b> 0,1	<b>NAME: LAST, FIRST, MIDDLE</b> STEWART, KATELYNN, ELIZABETH			<b>DATE OF BIRTH</b> 06 / 28 / 1997		<b>AGE</b> 24	<b>GENDER</b> F			
<b>ADDRESS: STREET, CITY, STATE, ZIP</b> 3379 RHAPSODY, CLINTON, OH 44216				<b>CONTACT PHONE - INCLUDE AREA CODE</b>						
<b>INJURIES</b> 5	<b>INJURED TAKEN BY</b>	<b>EMS AGENCY (NAME)</b>	<b>INJURED TAKEN TO: MEDICAL FACILITY (NAME, CITY)</b>	<b>SAFETY EQUIPMENT USED</b> 0,1	<input type="checkbox"/> DOT-COMPLIANT MC HELMET	<b>SEATING POSITION</b> 0,1	<b>AIR BAG USAGE</b> 1	<b>EJECTION</b> 1	<b>TRAPPED</b> 1	
<b>OL STATE</b> OH	<b>OPERATOR LICENSE NUMBER</b>		<b>OFFENSE CHARGED</b>	<b>LOCAL CODE</b> <input type="checkbox"/>	<b>OFFENSE DESCRIPTION</b>		<b>CITATION NUMBER</b>			
<b>OL CLASS</b> 4	<b>ENDORSEMENT SELECT UP TO 2</b>	<b>RESTRICTION SELECT UP TO 3</b>	<b>DRIVER DISTRACTED BY</b> 1	<b>ALCOHOL / DRUG SUSPECTED</b> <input type="checkbox"/> ALCOHOL <input type="checkbox"/> MARIJUANA <input type="checkbox"/> OTHER DRUG		<b>CONDITION</b> 1	<b>ALCOHOL TEST</b> STATUS: 1, TYPE: 1, VALUE: .		<b>DRUG TEST(S)</b> STATUS: 1, TYPE: 1, RESULT: SELECT UP TO 4	

<b>UNIT #</b> 0,2	<b>NAME: LAST, FIRST, MIDDLE</b>			<b>DATE OF BIRTH</b>		<b>AGE</b>	<b>GENDER</b>			
<b>ADDRESS: STREET, CITY, STATE, ZIP</b>				<b>CONTACT PHONE - INCLUDE AREA CODE</b>						
<b>INJURIES</b>	<b>INJURED TAKEN BY</b>	<b>EMS AGENCY (NAME)</b>	<b>INJURED TAKEN TO: MEDICAL FACILITY (NAME, CITY)</b>	<b>SAFETY EQUIPMENT USED</b>	<input type="checkbox"/> DOT-COMPLIANT MC HELMET	<b>SEATING POSITION</b>	<b>AIR BAG USAGE</b>	<b>EJECTION</b>	<b>TRAPPED</b>	
<b>OL STATE</b>	<b>OPERATOR LICENSE NUMBER</b>		<b>OFFENSE CHARGED</b>	<b>LOCAL CODE</b> <input type="checkbox"/>	<b>OFFENSE DESCRIPTION</b>		<b>CITATION NUMBER</b>			
<b>OL CLASS</b>	<b>ENDORSEMENT SELECT UP TO 2</b>	<b>RESTRICTION SELECT UP TO 3</b>	<b>DRIVER DISTRACTED BY</b>	<b>ALCOHOL / DRUG SUSPECTED</b> <input type="checkbox"/> ALCOHOL <input type="checkbox"/> MARIJUANA <input type="checkbox"/> OTHER DRUG		<b>CONDITION</b>	<b>ALCOHOL TEST</b> STATUS: 1, TYPE: 1, VALUE: .		<b>DRUG TEST(S)</b> STATUS: 1, TYPE: 1, RESULT: SELECT UP TO 4	

<b>UNIT #</b>	<b>NAME: LAST, FIRST, MIDDLE</b>			<b>DATE OF BIRTH</b>		<b>AGE</b>	<b>GENDER</b>			
<b>ADDRESS: STREET, CITY, STATE, ZIP</b>				<b>CONTACT PHONE - INCLUDE AREA CODE</b>						
<b>INJURIES</b>	<b>INJURED TAKEN BY</b>	<b>EMS AGENCY (NAME)</b>	<b>INJURED TAKEN TO: MEDICAL FACILITY (NAME, CITY)</b>	<b>SAFETY EQUIPMENT USED</b>	<input type="checkbox"/> DOT-COMPLIANT MC HELMET	<b>SEATING POSITION</b>	<b>AIR BAG USAGE</b>	<b>EJECTION</b>	<b>TRAPPED</b>	
<b>OL STATE</b>	<b>OPERATOR LICENSE NUMBER</b>		<b>OFFENSE CHARGED</b>	<b>LOCAL CODE</b> <input type="checkbox"/>	<b>OFFENSE DESCRIPTION</b>		<b>CITATION NUMBER</b>			
<b>OL CLASS</b>	<b>ENDORSEMENT SELECT UP TO 2</b>	<b>RESTRICTION SELECT UP TO 3</b>	<b>DRIVER DISTRACTED BY</b>	<b>ALCOHOL / DRUG SUSPECTED</b> <input type="checkbox"/> ALCOHOL <input type="checkbox"/> MARIJUANA <input type="checkbox"/> OTHER DRUG		<b>CONDITION</b>	<b>ALCOHOL TEST</b> STATUS: 1, TYPE: 1, VALUE: .		<b>DRUG TEST(S)</b> STATUS: 1, TYPE: 1, RESULT: SELECT UP TO 4	

INJURIES	SEATING POSITION	AIR BAG	OL CLASS	OL RESTRICTION(S)	DRIVER DISTRACTION	TEST STATUS
1 - FATAL 2 - SUSPECTED SERIOUS INJURY 3 - SUSPECTED MINOR INJURY 4 - POSSIBLE INJURY 5 - NO APPARENT INJURY	1 - FRONT - LEFT SIDE (MOTORCYCLE DRIVER) 2 - FRONT - MIDDLE 3 - FRONT - RIGHT SIDE 4 - SECOND - LEFT SIDE (MOTORCYCLE PASSENGER) 5 - SECOND - MIDDLE 6 - SECOND - RIGHT SIDE 7 - THIRD - LEFT SIDE (MOTORCYCLE SIDE CAR) 8 - THIRD - MIDDLE 9 - THIRD - RIGHT SIDE 10 - SLEEPER SECTION OF TRUCK CAB	1 - NOT DEPLOYED 2 - DEPLOYED FRONT 3 - DEPLOYED SIDE 4 - DEPLOYED BOTH FRONT / SIDE 5 - NOT APPLICABLE 9 - DEPLOYMENT UNKNOWN	1 - CLASS A 2 - CLASS B 3 - CLASS C 4 - REGULAR CLASS (OHID = D) 5 - MC MOPED ONLY 6 - NO VALID OL	1 - ALCOHOL INTERLOCK DEVICE 2 - CDL INTRASTATE ONLY 3 - CORRECTIVE LENSES 4 - FARM WAIVER 5 - EXCEPT CLASS A BUS 6 - EXCEPT CLASS A & CLASS B BUS 7 - EXCEPT TRACTOR-TRAILER 8 - INTERMEDIATE LICENSE RESTRICTIONS 9 - LEARNER'S PERMIT RESTRICTIONS 10 - LIMITED TO DAYLIGHT ONLY 11 - LIMITED TO EMPLOYMENT 12 - LIMITED - OTHER 13 - MECHANICAL DEVICES (SPECIAL BRAKES, HAND CONTROLS, OR OTHER ADAPTIVE DEVICES) 14 - MILITARY VEHICLES ONLY 15 - MOTOR VEHICLES WITHOUT AIR BRAKES 16 - OUTSIDE MIRROR 17 - PROSTHETIC AID 18 - OTHER	1 - NOT DISTRACTED 2 - MANUALLY OPERATING AN ELECTRONIC COMMUNICATION DEVICE (TEXTING, TYPING, DIALING) 3 - TALKING ON HANDS-FREE COMMUNICATION DEVICE 4 - TALKING ON HAND-HELD COMMUNICATION DEVICE 5 - OTHER ACTIVITY WITH AN ELECTRONIC DEVICE 6 - PASSENGER 7 - OTHER DISTRACTION INSIDE THE VEHICLE 8 - OTHER DISTRACTION OUTSIDE THE VEHICLE 9 - OTHER / UNKNOWN	1 - NONE GIVEN 2 - TEST REFUSED 3 - TEST GIVEN, CONTAMINATED SAMPLE / UNSABLE 4 - TEST GIVEN, RESULTS KNOWN 5 - TEST GIVEN, RESULTS UNKNOWN
INJURED TAKEN BY	EJECTION		OL ENDORSEMENT	CONDITION		ALCOHOL TEST TYPE
1 - NOT TRANSPORTED / TREATED AT SCENE 2 - EMS 3 - POLICE 9 - OTHER / UNKNOWN	1 - NOT EJECTED 2 - PARTIALLY EJECTED 3 - TOTALLY EJECTED 4 - NOT APPLICABLE	H - HAZMAT M - MOTORCYCLE P - PASSENGER N - TANKER Q - MOTOR SCOOTER R - THREE-WHEEL MOTORCYCLE S - SCHOOL BUS T - DOUBLE & TRIPLE TRAILERS X - TANKER / HAZMAT	1 - NONE 2 - BLOOD 3 - URINE 4 - BREATH 5 - OTHER	1 - APPARENTLY NORMAL 2 - PHYSICAL IMPAIRMENT 3 - EMOTIONAL (E.G., DEPRESSED, ANGRY, DISTURBED) 4 - ILLNESS 5 - FELL ASLEEP, FAINTED, FATIGUED, ETC. 6 - UNDER THE INFLUENCE OF MEDICATIONS / DRUGS / ALCOHOL 9 - OTHER / UNKNOWN	1 - NONE 2 - BLOOD 3 - URINE 4 - OTHER	1 - NONE 2 - BLOOD 3 - URINE 4 - OTHER
SAFETY EQUIPMENT	TRAPPED		GENDER	DRUG TEST TYPE		DRUG TEST RESULT(S)
1 - NONE USED 2 - SHOULDER BELT ONLY USED 3 - LAP BELT ONLY USED 4 - SHOULDER & LAP BELT USED 5 - CHILD RESTRAINT SYSTEM - FORWARD FACING 6 - CHILD RESTRAINT SYSTEM - REAR FACING 7 - BOOSTER SEAT 8 - HELMET USED 9 - PROTECTIVE PADS USED (ELBOW, KNEES, ETC.) 10 - REFLECTIVE CLOTHING 11 - LIGHTING - PEDESTRIAN / BICYCLE ONLY 99 - OTHER / UNKNOWN	1 - NOT TRAPPED 2 - EXTRICATED BY MECHANICAL MEANS 3 - FREED BY NON-MECHANICAL MEANS	F - FEMALE M - MALE U - OTHER / UNKNOWN	1 - NONE 2 - BLOOD 3 - URINE 4 - OTHER	1 - AMPHETAMINES 2 - BARBITURATES 3 - BENZODIAZEPINES 4 - CANNABINOIDS 5 - COCAINE 6 - OPIATES / OPIOIDS 7 - OTHER 8 - NEGATIVE RESULTS	1 - AMPHETAMINES 2 - BARBITURATES 3 - BENZODIAZEPINES 4 - CANNABINOIDS 5 - COCAINE 6 - OPIATES / OPIOIDS 7 - OTHER 8 - NEGATIVE RESULTS	